



**STIRLING MANSIONS  
CANFIELD GARDENS  
SOUTH HAMPSTEAD NW6**

**£950,000**

SOLE AGENT

A unique and spacious two double bedroom, two bathroom garden apartment situated on the ground floor of this impressive mansion block boasting 973 sq ft of internal space.

This superb flat benefits from high ceilings throughout, a gorgeous 19ft x 11ft reception room and an extensive 23ft x 9ft eat-in kitchen leading on to a private patio area which offers direct access to a well maintained communal garden.

Further advantages include off street first come first served parking, period features and ample storage.

Stirling Mansions is ideally located with Finchley Road underground station (Jubilee & Metropolitan Lines) positioned just 0.2 miles away with Waitrose and other local amenities equally close by.

2 Bedrooms – Bathroom – Shower Room – Reception Room – Kitchen – Patio – Communal Gardens – First Come First Served Parking – Share Of Freehold

STIRLING MANSIONS  
SOUTH HAMPSTEAD NW6  
£950,000



## Stirling Mansions, Canfield Gardens, NW6

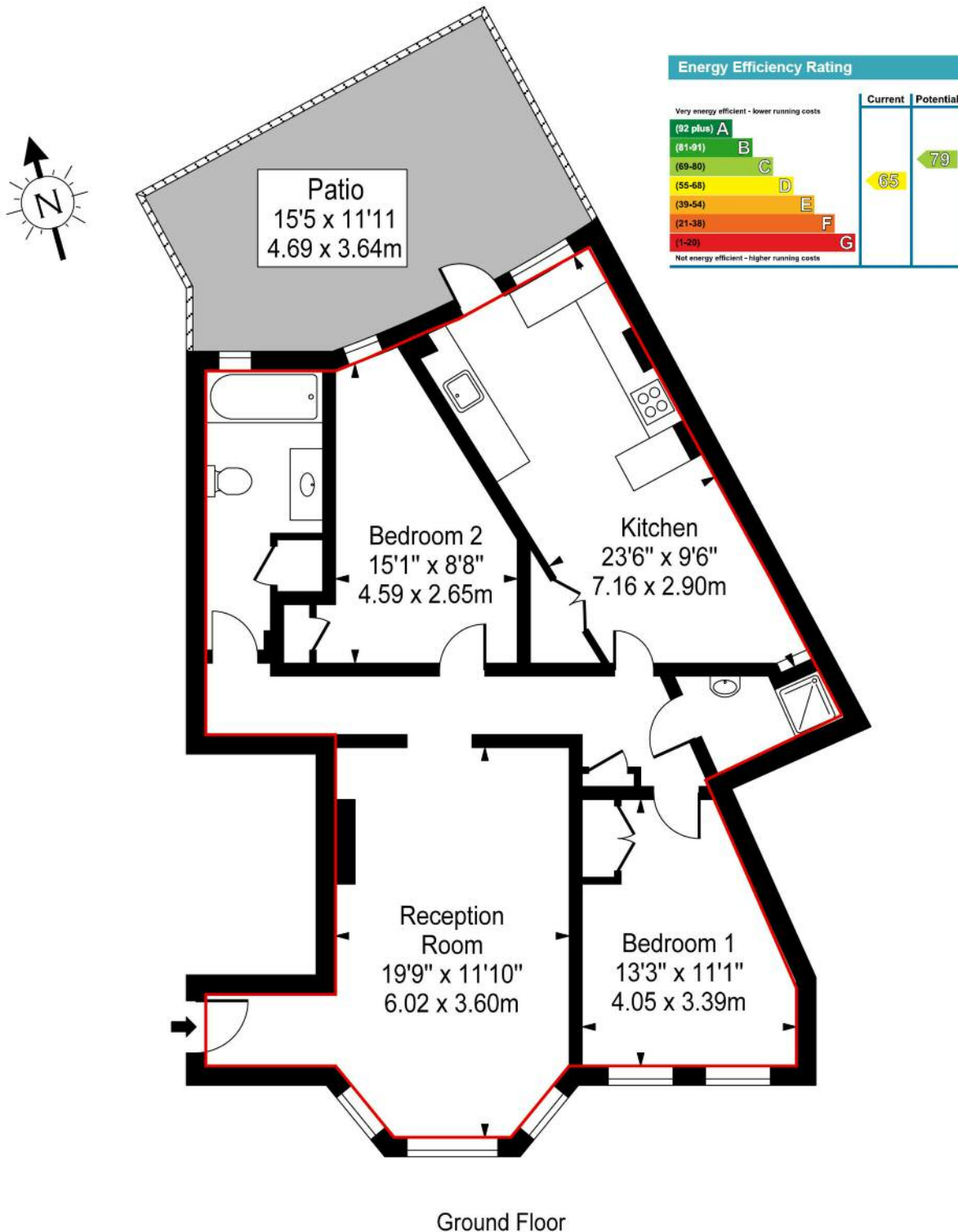

**Approximate Square Footage Within Red Line      973 Sq Ft - 90.43 Sq M**

For Illustration Purposes Only - Not To Scale    Floor Plan by [www.nogaphotostudio.com](http://www.nogaphotostudio.com)    Ref: No.33300

This floor plan should be used as a general outline for guidance only. Any intending purchaser or lessee should satisfy themselves by inspection, searches, enquiries and full survey as to the correctness of each statement. Any areas, measurements or distances quoted are approximate and should not be used to value a property or be the basis of any sale or let.

