

A photograph of a multi-story brick apartment building at Rainbow Quay, Surrey Quays. The building features a prominent curved balcony on the left side and a small white cupola on the roof. The ground floor has large windows and a paved area with trees. A silver car is parked on the right. The sky is blue with some clouds.

Rainbow Quay, Surrey Quays

Asking Price £375,000 Leasehold

OLIVER  JACQUES
EST. 1986



Rainbow Quay, Surrey Quays

Nestled between Surrey Quays' two scenic docks, this immaculately kept, quayside apartment feels a world away from its convenient location near the Thames. The property benefits from floor-to-ceiling windows and Juliette balconies to both the reception room and bedroom which offer views directly over Greenland Dock. Rainbow Quay further enjoys secure underground parking, impeccably maintained communal gardens and an active residents' association. Moments from the Thames Clipper service - offering commuter riverboat services to Canary Wharf and beyond - and within walking distance of both Surrey Quays and Canada Water underground stations.

- Second Floor Apartment
- Direct Views Over Docks
- Juliette Balconies
- Secure Allocated Parking
- Well-Kept Communal Gardens
- Quiet Residential Location

South East London
020 7231 5050

Email southeast@o-j.co.uk

229-231 Lower Road, London, SE16 2LW

web www.o-j.co.uk

Every care has been taken with the preparation of this brochure but it is for general guidance only and complete accuracy cannot be guaranteed. If there is any point, which is of importance professional verification should be sought. This brochure does not constitute a contract or part of a contract. We are not qualified to verify tenure of property. Prospective purchasers should seek clarification from their solicitor or verify the tenure of this property for themselves by visiting www.landregisteronline.gov.uk. The mention of any appliances, fixtures or fittings does not imply they are in full working order. Photographs are reproduced for general information and it cannot be inferred that any item shown is included in the sale. All dimensions are approximate. Walking times are taken from Google Maps and measured from the centre of the postcode, which may differ slightly from the individual property.

Rainbow Quay, London, SE16

APPROX. GROSS INTERNAL FLOOR AREA 483 SQ FT 44.8 SQ METRES

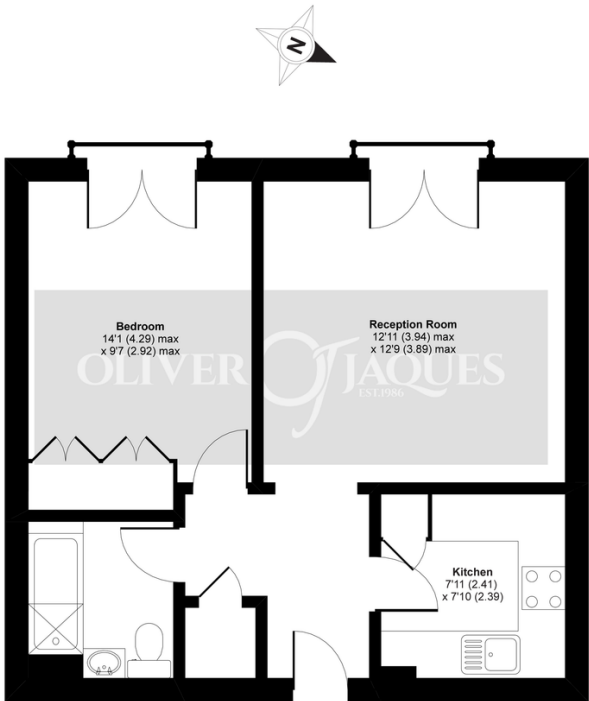

SECOND FLOOR

Whilst every attempt has been made to ensure the accuracy of the floor plan contained here, measurements of doors, windows and rooms are approximate and no responsibility is taken for any error, omission or misstatement. These plans are for representation purposes only as defined by RICS Code of Measuring Practice and should be used as such by any prospective purchaser. Specifically no guarantee is given on the total square footage of the property if quoted on this plan. Any figure given is for initial guidance only and should not be relied on as a basis of valuation.

Copyright nichecom.co.uk 2019 Produced for Oliver Jacques REF : 522680

