



North Street
Winterborne Kingston, Dorset, DT11 9AZ

North Street, Winterborne Kingston, Dorset, DT11 9AZ

FREEHOLD PRICE £365,000

A unique opportunity to acquire a four bedroom semi detached cottage over three floors with stunning kitchen and bathroom situated in a popular village location. Vendor suited.

- Entrance storm porch leading to entrance hallway
- Good size sitting room with wood burner and dual aspect
- Stunning kitchen/breakfast room with butler sink, a range of base units and drawers, matching pantry cupboard, space for range cooker and appliances
- Utility room with tiled flooring and space for appliances
- Feature beams and flagstone flooring to the sitting room, hallway and kitchen/breakfast room
- First floor landing leading to two bedrooms and bathroom
- Spacious Master bedroom enjoying a dual aspect
- Superb bathroom with clawfoot freestanding bath, separate shower cubicle, vanity unit with wash hand basin and WC
- Second floor landing leading to two double bedrooms with velux windows
- Gas heating and shared sewerage treatment plant
- Off road parking leading to detached garage, in need of some modernisation. The garden is then behind with gravel pathway, patio and lawn area, with vegetable patch, flower, tree and shrub borders

Winterborne Kingston is a popular village approximately 12 miles west of Wimborne and approximately 13 miles from Dorchester. Local amenities include a local pub/restaurant, church, primary school, village hall and shop. Further amenities are available in Bere Regis, Wareham, Blandford and Poole.

EPC RATING: TBC

AGENTS NOTE: The heating system, mains and appliances have not been tested by Hearnese Estate Agents. Any areas, measurements or distances are approximate. The text, photographs and plans are for guidance only and are not necessarily comprehensive.



Ground Floor

Approx. 56.7 sq. metres (609.9 sq. feet)

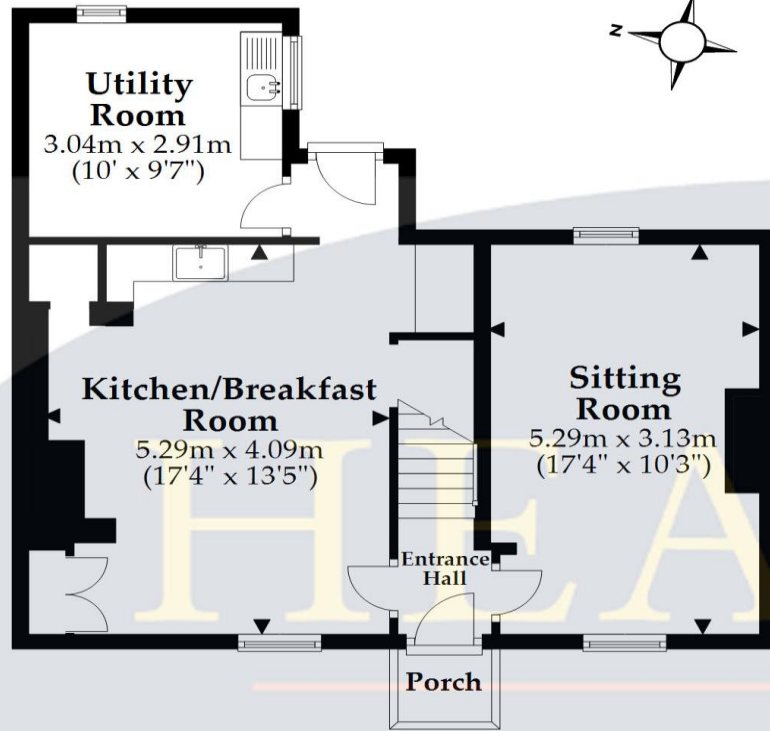

First Floor

Approx. 46.7 sq. metres (502.7 sq. feet)

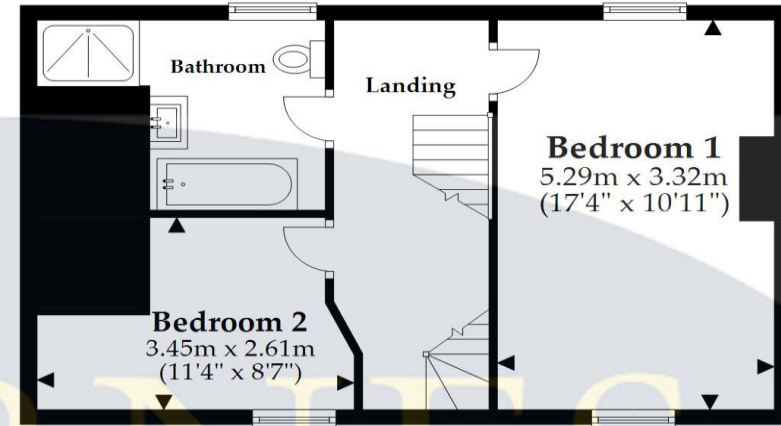

Outbuilding

Approx. 33.3 sq. metres (358.8 sq. feet)

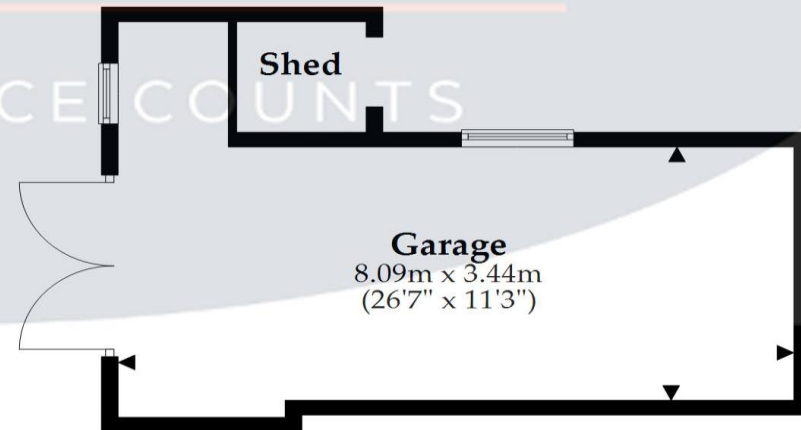

Second Floor

Approx. 31.6 sq. metres (340.2 sq. feet)

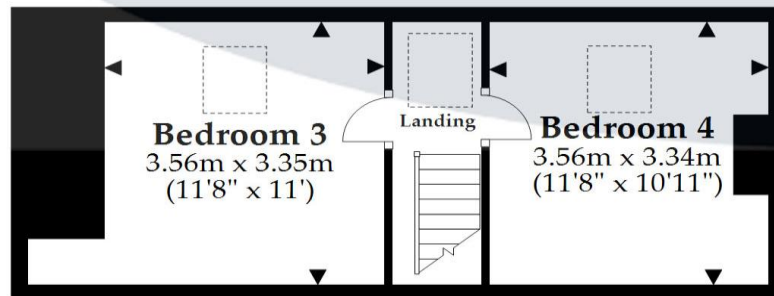

Total area: approx. 168.3 sq. metres (1811.6 sq. feet)

This plan is not to scale and it is for general guidance only. LJT Surveying Ringwood



6 Cook Row, Wimborne, Dorset BH21 1LB Tel: 01202 842922 Email: wimborne@hearnes.com www.hearnes.com

OFFICES ALSO AT: BOURNEMOUTH, FERNDOWN, POOLE & RINGWOOD

