

St. Pauls Road

Cheltenham GL50 4EX



Coopers Court, St. Pauls Road, Cheltenham GL50 4EX

This one double bedroom, second floor apartment is located in the popular area of St Pauls, just a short distance from Cheltenham Town Centre and offered to the market CHAIN FREE making it the ideal investment property or first home.

The modern accommodation consists of an open plan kitchen / dining / living room with an integrated cooker and white goods. There is a double bedroom and family bathroom with three piece suite. The property further benefits from large double doors creating plenty of natural light, permit parking and a bike store.

Leasehold

Years Remaining on Lease: 116

Annual Service Charge: £1370

Annual Ground Rent: £250

Council Tax Band: A





GROUND FLOOR
366 sq.ft. (34.0 sq.m.) approx.

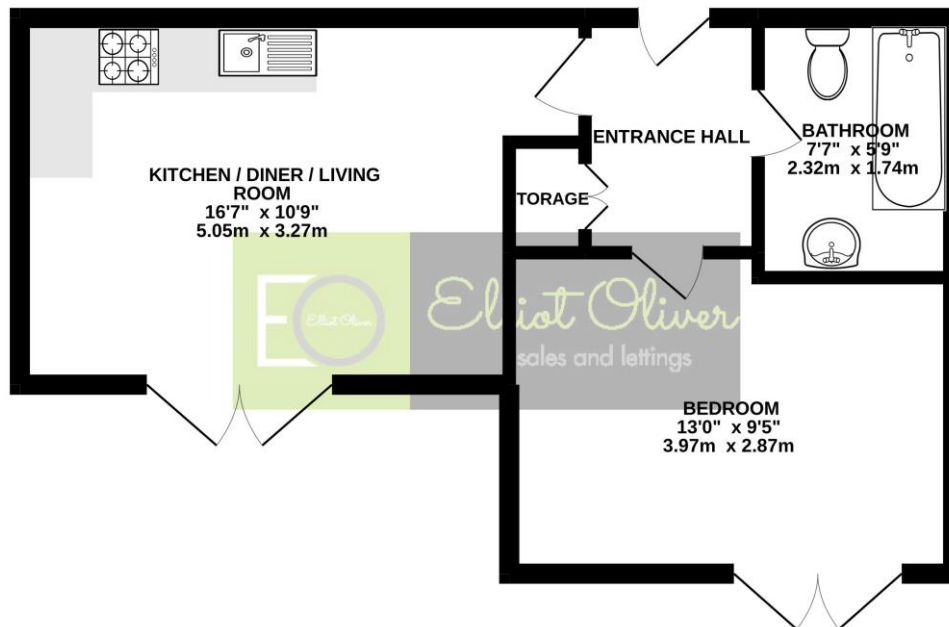

TOTAL FLOOR AREA : 366 sq.ft. (34.0 sq.m.) approx.

Whilst every attempt has been made to ensure the accuracy of the floorplan contained here, measurements of doors, windows, rooms and any other items are approximate and no responsibility is taken for any error, omission or mis-statement. This plan is for illustrative purposes only and should be used as such by any prospective purchaser. The services, systems and appliances shown have not been tested and no guarantee as to their operability or efficiency can be given.
Made with Metropix ©2022

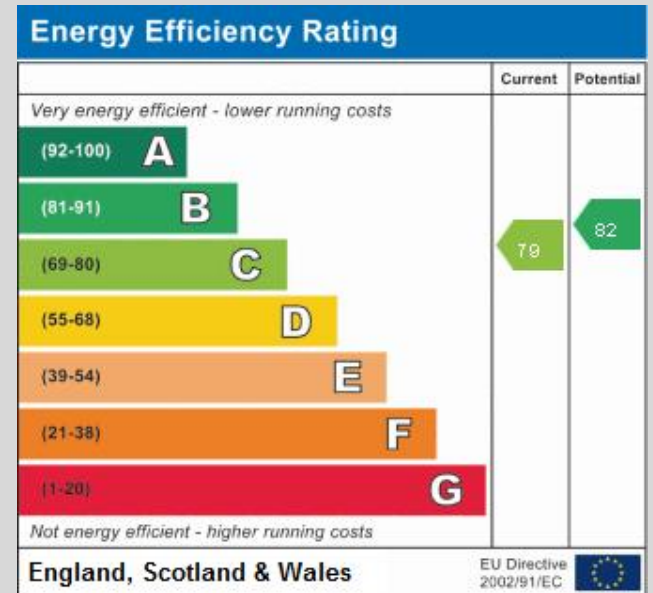

OFFICE

101 Promenade,
Cheltenham,
Gloucestershire, GL50
1NW
info@elliottoliver.co.uk

Agents Note: Whilst every care has been taken to prepare these sales particulars, they are for guidance purposes only. All measurements are approximate and for general guidance purposes only and whilst every care has been taken to ensure their accuracy, they should not be relied upon and potential buyers are advised to recheck the measurements