



## FOR SALE

3 Bed Detached Bungalow in Estoril Avenue, Leicester LE18 3RD  
£375,000

\*\*\* No Chain \*\*\* Extremely well presented and well maintained detached bungalow in the ever popular 'Meres' area of Wigston and closely located to Glenmere primary school. The accommodation comprises entrance hall, lounge diner, breakfast kitchen, three bedrooms, en-suite to master, family bathroom, tandem garage, off road parking and pleasant rear garden. Bungalows in this condition don't come to the market very often so get your viewing booked today!



GROUND FLOOR  
1192 sq.ft. (110.7 sq.m.) approx.

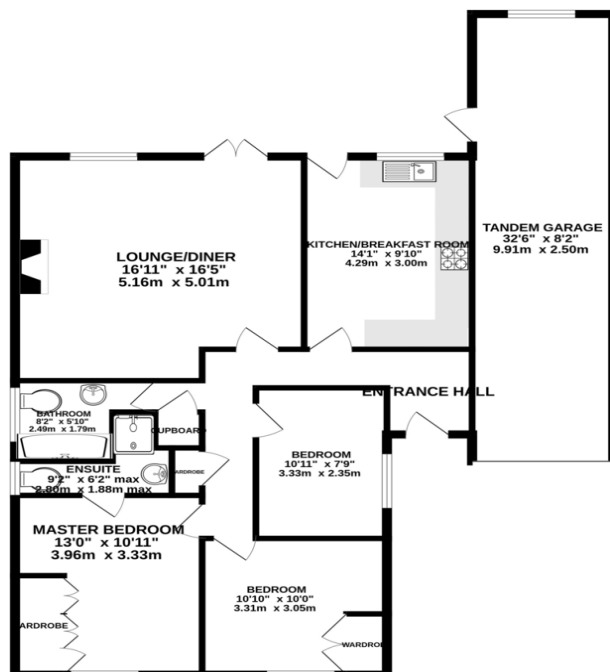

TOTAL FLOOR AREA: 1192 sq.ft. (110.7 sq.m.) approx.

Whilst every attempt has been made to ensure the accuracy of the floorplan contained here, measurements of doors, windows, rooms and any other items are approximate and no responsibility is taken for any error, omission or mis-statement. This plan is for illustrative purposes only and should be used as such by any prospective purchaser. The services, systems and appliances shown have not been tested and no guarantee as to their operability or efficiency can be given.  
Made with Metropix ©2023

**Agents Note:** Whilst every care has been taken to prepare these sales particulars, they are for guidance purposes only. All measurements are approximate are for general guidance purposes only and whilst every care has been taken to ensure their accuracy, they should not be relied upon and potential buyers are advised to recheck the measurements.

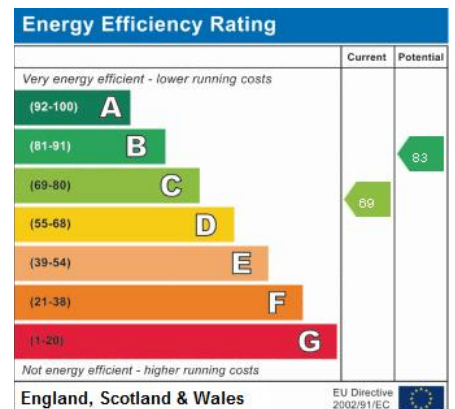

- No Chain
- Detached Bungalow
- Excellent Location
- Three Bedrooms
- En-Suite To Master
- 36' Long Garage
- Pleasant Rear Garden
- Well Presented Throughout

