



Kings Gardens, London NW6

£750,000 Share of Freehold

Welcome to this generously proportioned three-bedroom flat located in the heart of West Hampstead. Spanning over 1,100 sq ft, this unmodernised gem offers ample space and potential for personalization, making it the perfect canvas for your dream home.

The property boasts a share of freehold, providing an excellent investment opportunity with long-term security. The flat features three spacious double bedrooms, ideal for families or those in need of extra space for a home office or guest room.

Situated in an enviable location, this flat is just moments away from the iconic Abbey Road, offering a touch of historical charm. Residents will also appreciate the close proximity to local shops and amenities, ensuring that everything you need is within easy reach.

- **Spacious**
- **Over 1,100 sq ft**
- **Share of Freehold**
- **Three double bedrooms**
- **Excellent Location**
- **West Hampstead**
- **Moments away from Abbey Road**
- **Unmodernised**
- **Close to local shops and amenities**
- **Good transport links**

Kings Gardens, NW6 4PX

Approx Gross Internal Area = 101 sq.m / 1087 sq.ft

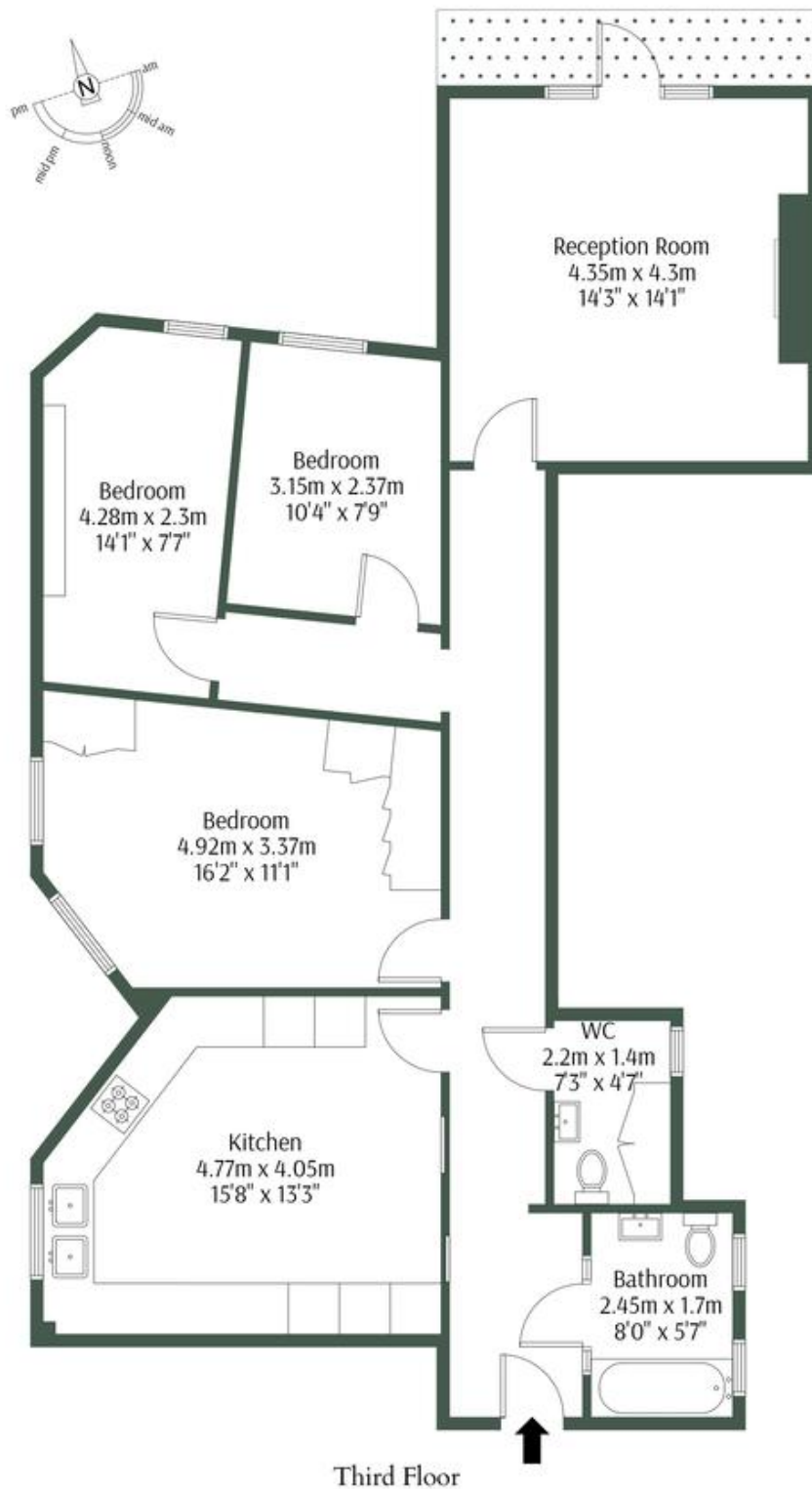

M MILE

The Floor plan is not to scale and measurements and areas shown are approximate and therefore should be used for

MONEY LAUNDERING REGULATIONS 2003: Intending purchasers will be asked to produce identification documentation at a later stage and we would ask for your co-operation in order that there will be no delay in agreeing the sale.

General: While we endeavour to make our sales particulars fair, accurate and reliable, they are only a general guide to the property and, accordingly, if there is any point which is of particular importance to you, please contact the office and we will be pleased to check the position for you, especially if you are contemplating travelling some distance to view the property.

Measurements: These approximate room sizes are only intended as general guidance. You must verify the dimensions carefully before ordering carpets or any built-in furniture.

Services: Please note we have not tested the services or any of the equipment or appliances in this property, accordingly we strongly advise prospective buyers to commission their own survey or service reports before finalising their offer to purchase.