



FOR SALE

3 Bed Detached House in Clipstone Gardens, Wigston, LE18 3UN
Offers Over £300,000

*** No Chain *** Well presented detached family home nestled in a quiet on cul-de-sac on the ever popular Meadows estate in Wigston. The accommodation comprises porch, entrance hall, downstairs w.c., lounge diner, kitchen, three bedrooms, w.c. ensuite, family bathroom, front and rear gardens, off road parking and detached garage.



GROUND FLOOR
436 sq.ft. (40.5 sq.m.) approx.

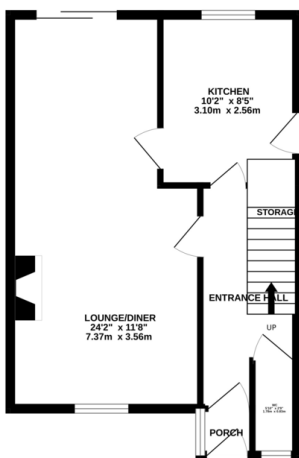

1ST FLOOR
426 sq.ft. (39.5 sq.m.) approx.

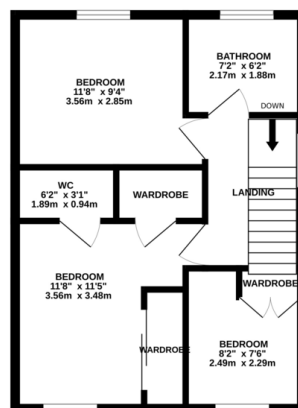

TOTAL FLOOR AREA: 862 sq.ft. (80.1 sq.m.) approx.
Whilst every attempt has been made to ensure the accuracy of the floorplan contained here, measurements of doors, windows, rooms and any other items are approximate and no responsibility is taken for any error, omission or misstatement. This plan is for illustrative purposes only and should be used as such by any prospective purchaser. The services, systems and appliances shown here have not been tested and no guarantee as to their operability or efficiency can be given.
Made with Heliograph 12/2014

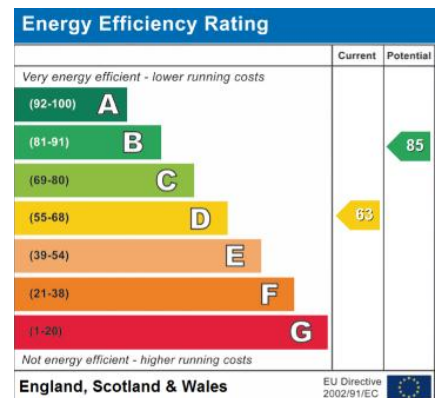

- No Chain
- Detached House
- Quiet Cul-De-Sac
- Detached Garage
- W.C. En-Suite
- Well Presented Throughout
- Three Bedrooms
- Ideal Family Home

Agents Note: Whilst every care has been taken to prepare these sales particulars, they are for guidance purposes only. All measurements are approximate and for general guidance purposes only and whilst every care has been taken to ensure their accuracy, they should not be relied upon and potential buyers are advised to recheck the measurements.

