



39 St. Richards Road

Portslade BN41 1PA

Guide Price £400,000 - £425,000

- BEAUTIFULLY REFURBISHED
- THREE BEDROOMS
- BATHROOM
- KITCHEN/DINING ROOM

- LIVING ROOM
- PRIVATE GARDEN
- GARDEN ROOM/HOME OFFICE
- PRESENTED IN EXCELLENT ORDER

Guide Price £400,000 - £425,000. Whitlock and Heaps are pleased to bring to market this beautifully refurbished and updated three bedroom family home that is offered for sale in excellent order throughout with a delightful and newly installed kitchen/dining room that opens onto the good size rear garden. The property also features a separate living room with open fire and in the garden is an insulated garden room/home office.

ENTRANCE HALL Understairs storage, radiator.

KITCHEN/DINING ROOM Kitchen Incorporating stainless steel sink with mixer tap, adjacent work surface with cupboards and drawers under, eye level wall cupboards, inset induction hob with concealed extractor over, oven, integrated fridge/freezer and washing machine, tiled splashback, window overlooking the garden.

Dining Feature fireplace with tiled surround and hearth, fitted unit in alcove, cupboard housing 'Ideal' gas fired boiler and plumbing for washing machine, radiator, door to garden.

LIVING ROOM Open fireplace with tiled hearth and surround, UPVC double glazed bay window, radiator.

FIRST FLOOR

LANDING Hatch to loft with pull down ladder, varnished floorboards.

BEDROOM 1 Fitted wardrobes, UPVC double glazed window, radiator, varnished floorboards.

BEDROOM 2 Fitted cupboard, feature fireplace, radiator, UPVC double glazed windows, varnished floorboards.

BEDROOM 3 UPVC double glazed window, radiator, varnished floorboards.

BATHROOM White suite comprising panelled bath with mixer tap, 'Mira' electric shower over, wash hand basin with cupboard under, low level w.c, part tiled walls, UPVC double glazed window, radiator.

OUTSIDE

REAR GARDEN Paved patio and area of lawn with flower borders.

GARDEN ROOM/HOME OFFICE

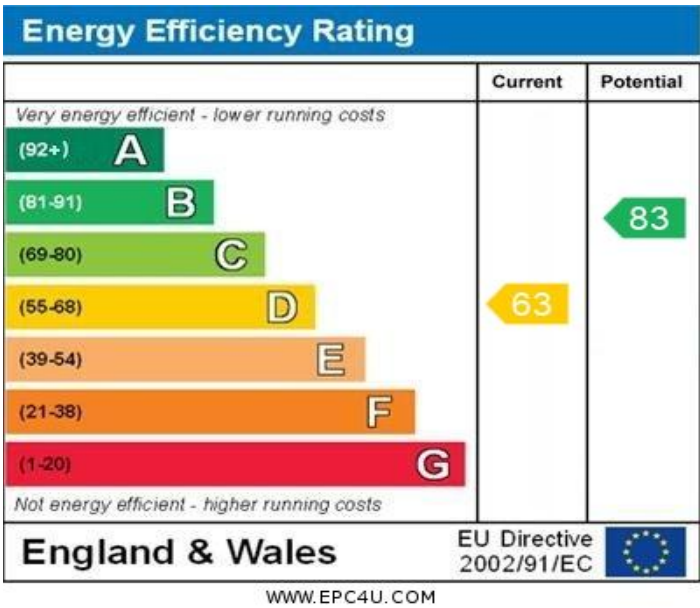
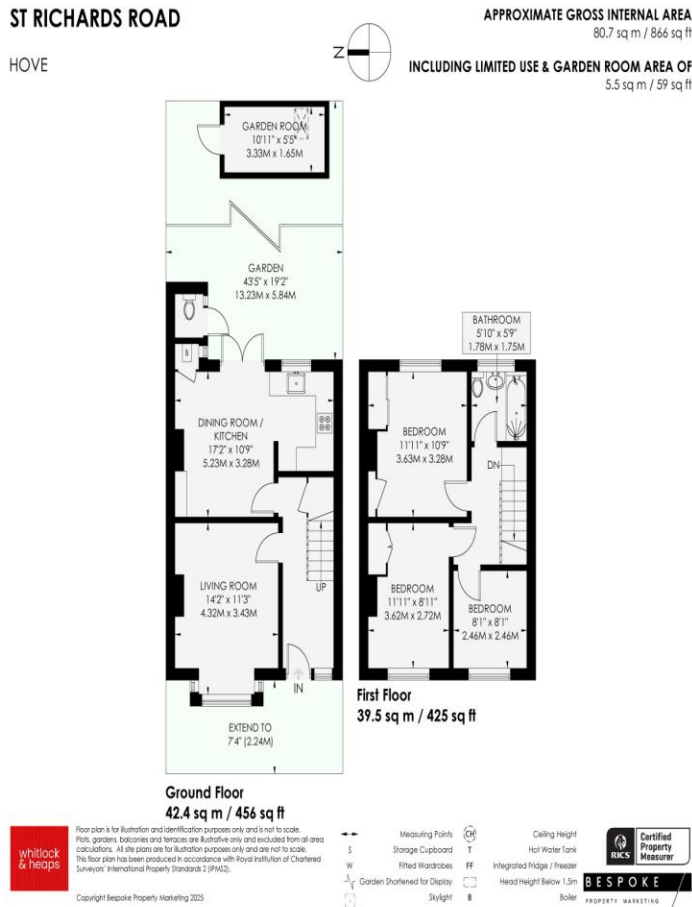

Portslade Branch
48 Boundary Road, Portslade BN3 4EF
portslade@whitlockandheaps.co.uk
01273 422706



Hove Branch
65 Sackville Road, Hove BN3 3WE
hove@whitlockandheaps.co.uk
01273 778577

Disclaimer: Whitlock & Heaps have produced these particulars in good faith and they are set out as a general guide. Accuracy is not guaranteed, nor do they form part of any contract. If there is any particular aspect of these details which you require any confirmation, please do contact us, especially if contemplating a long journey. All measurements are approximate. Fixtures and fittings, other than those mentioned above, to be agreed with the seller. Any services, systems or appliances at the property have not been tested.