



Valley View, Bury, Lancashire **£140,000**





YOUR MOVE





Valley View, Bury, Lancashire

£140,000

Property Description

Offered for sale with no onward chain, viewings are a must on this beautifully presented and maintained modern build home. Benefits include Gas Central Heating and Double Glazing with the accommodation in brief comprising entrance hall way, W.C, spacious lounge and kitchen to the ground floor. To the first floor there are two DOUBLE bedrooms and a bathroom. Externally there is a driveway providing off road parking to the front and a generous sized, lawned garden to the rear. Call to view now. EPC Grade Awaited. A copy of the EPC will be available on request.

Our View

An excellent opportunity to purchase this beautiful property which would make an ideal first home. Set in spacious gardens with Off Road Parking in an excellent commuting area, viewings are a must.

Location

An excellent location for those requiring access to Bury Town Centre approximately 1 mile away with its array of branded shops, restaurants and entertainment facilities. Tottington Village is also approximately one mile away.



*****EPC RATING*****

For full EPC please contact the branch

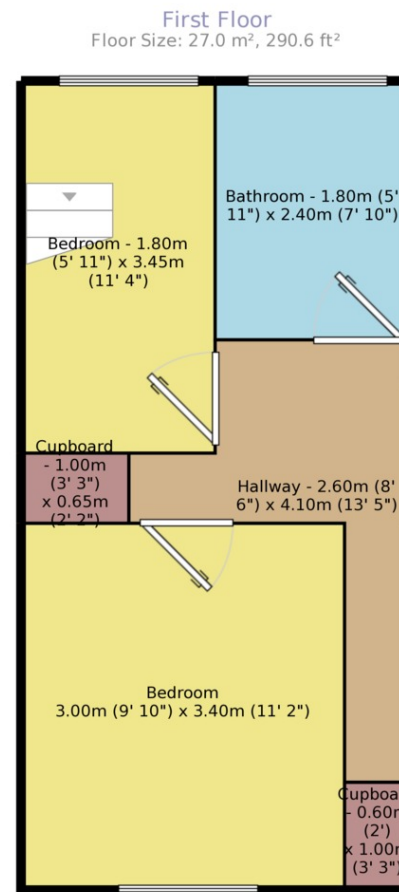
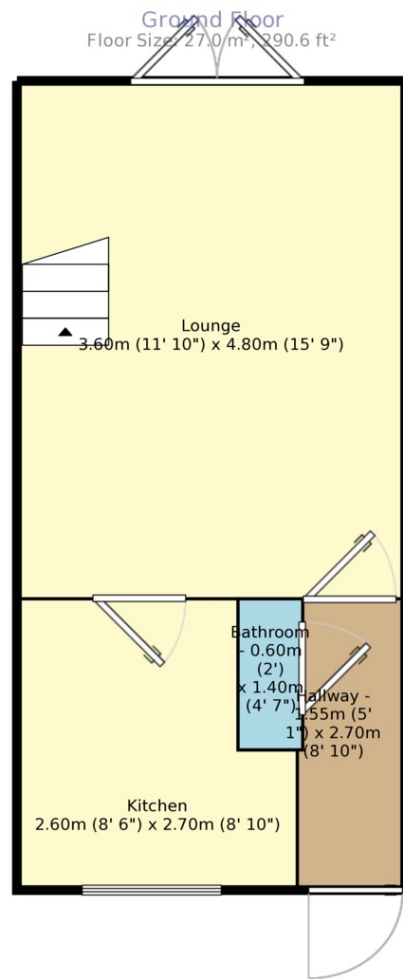

Measurements are approximate. Not to scale. For illustrative purposes only.

IMPORTANT NOTE TO PURCHASERS: We endeavour to make our sales particulars accurate and reliable, however, they do not constitute or form part of an offer or any contract and none is to be relied upon as statements of representation or fact. The services, systems and appliances listed in this specification have not been tested by us and no guarantee as to their operating ability or efficiency is given. All measurements have been taken as guide to prospective buyers only, and are not precise. Floor plans where included are not to scale and accuracy is not guaranteed. If you require clarification or further information on any points, please contact us, especially if you are travelling some distance to view. Fixtures and fittings other than those mentioned are to be agreed with the seller.

Your Move is a trading name of your-move.co.uk, registered in England at Newcastle House, Albany Court, Newcastle Business Park, Newcastle upon Tyne NE4 7YB (number 01864469).

18-20 The Rock, Bury, Lancashire, BL9 0NT

0161 7635066 * Bury@your-move.co.uk

*Calls may be recorded and/or monitored for training and/or security purposes.

