



Kneller Road, Whitton, Twickenham **£375,000**







Kneller Road, Whitton,
Twickenham

£375,000

Property Description

OVERLOOKING THE HISTORIC KNELLER HALL. This attractive ground floor maisonette in central Whitton is brought to the market with no forward chain. In brief offers living/dining room, fitted kitchen, 2 bedrooms and bathroom w/c. Other benefits include a south facing 27ft rear garden. EPC grade D. A full copy of the EPC is available on request.

Our View

FANTASTIC VIEWS OF HISTORIC KNELLER HALL.

Location

The property is situated in central Whitton and is within walking distance to Whitton High Street with a wide range of shops for your convenience and Whitton mainline Station which serves London Waterloo on the fast services in less than 30 minutes. The local Infant and Junior Schools are Chase Bridge, Nelson, Bishop Perrin, and St Edmunds. The local secondary School would be Twickenham Academy. Other benefits are local bus routes including the H22, 281 and 481 and local open space provided by Murray Park.



EPC Grade D

For full EPC please contact the branch

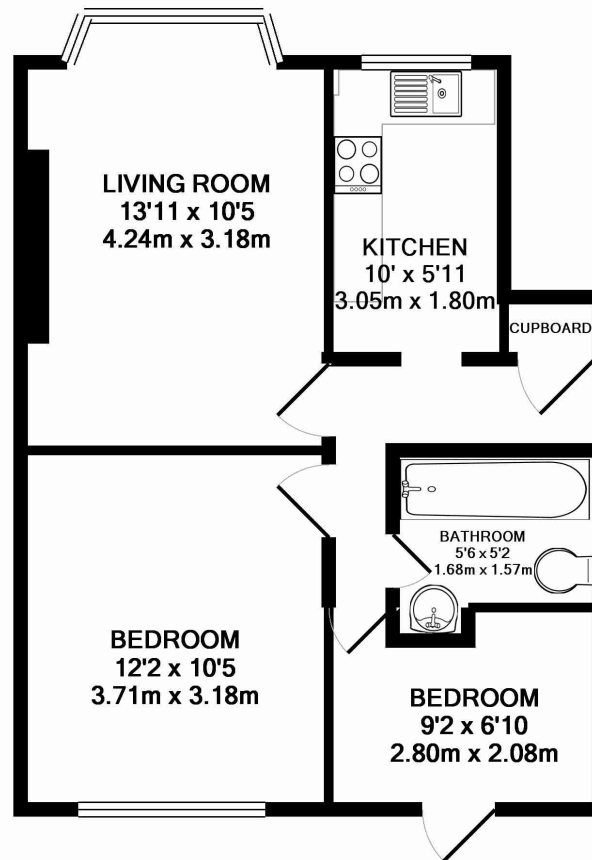

TOTAL APPROX. FLOOR AREA 431 SQ.FT. (40.1 SQ.M.)

Whilst every attempt has been made to ensure the accuracy of the floor plan contained here, measurements of doors, windows, rooms and any other items are approximate and no responsibility is taken for any error, omission, or mis-statement. This plan is for illustrative purposes only and should be used as such by any prospective purchaser. The services, systems and appliances shown have not been tested and no guarantee as to their operability or efficiency can be given

Made with Metropix ©2012

IMPORTANT NOTE TO PURCHASERS: We endeavour to make our sales particulars accurate and reliable, however, they do not constitute or form part of an offer or any contract and none is to be relied upon as statements of representation or fact. The services, systems and appliances listed in this specification have not been tested by us and no guarantee as to their operating ability or efficiency is given. All measurements have been taken as guide to prospective buyers only, and are not precise. Floor plans where included are not to scale and accuracy is not guaranteed. If you require clarification or further information on any points, please contact us, especially if you are travelling some distance to view. Fixtures and fittings other than those mentioned are to be agreed with the seller.

Your Move is a trading name of your-move.co.uk, registered in England at Newcastle House, Albany Court, Newcastle Business Park, Newcastle upon Tyne NE4 7YB (number 01864469).

*Calls may be recorded and/or monitored for training and/or security purposes.

115 High Street, Whitton, Twickenham, TW2
7LG

020 8898 6055 * Whitton@your-move.co.uk

