

Perry Bishop
and Chambers

the agent who keeps you informed

Hoopers Court, West Way, Cirencester, GL7 1GS



Two spacious bedrooms with fitted wardrobes | Fitted kitchen with integrated appliances
Allocated parking space | Very well presented
No onward chain | EPC C

£200,000

Cirencester Cheltenham Fairford Faringdon Leckhampton London Nailsworth Stroud Tetbury



West Way, Cirencester, GL7

APPROX. GROSS INTERNAL FLOOR AREA 572 SQ FT 53.1 SQ METRES

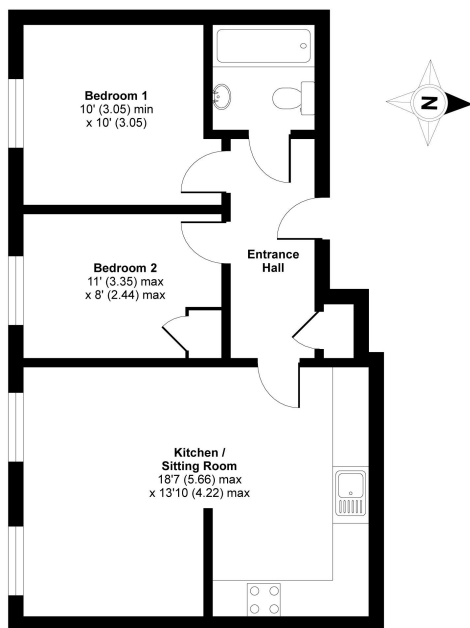

FIRST FLOOR

Whilst every attempt has been made to ensure the accuracy of the floor plan contained here, measurements of doors, windows and rooms are approximate and no responsibility is taken for any error, omission or misstatement. These plans are for representation purposes only as defined by RICS Code of Measuring Practice and should be used as such by any prospective purchaser. Specifically no guarantee is given on the total square footage of the property if quoted on this plan. Any figure given is for initial guidance only and should not be relied on as a basis of valuation.

Copyright nichecom.co.uk 2017 Produced for Perry Bishop & Chambers REF : 193452

Situated close to the town centre and offered with no onward chain, this first floor apartment is perfect for those looking for the ease of a central location with parking.

Entered into the communal vestibule, the apartment can be reached either by stairs to the first floor or by lift. Entering into the apartment the hallway is wide and welcoming and has doors leading off into the family bathroom with bath and overhead shower and two well-proportioned bedrooms with inbuilt storage.

The open plan kitchen is well equipped with a range of base and wall units and integrated appliances, and flows into the dining/sitting area which is light and airy. The apartment is in a quiet location and benefits from gas central heating and sealed unit double glazed windows and offers allocated parking.

Directions

From our office in Cirencester turn left into the Market Place. Continue through the Market Place taking the next turning on the right hand side into North Way with the property being found on the right hand side.

Services & Tenure

We believe the property is served by mains electricity, gas, water and drainage. The vendor informs us that the Tenure is Leasehold from 2006 for 250 years and the ground rent is £150 pa, the maintenance charges varies.

Local Authority

Cotswold District Council

Ref: CIR3884/MR/71026010

2 Silver Street, Cirencester, Gloucestershire, GL7 2BL

T: 01285 655355

E: cirencester@perrybishop.co.uk

perrybishop.co.uk

Disclaimer: These particulars should not be relied upon as statement or representation of fact and do not constitute part of an offer or contract. The seller does not make or give, nor do we or our employees have the authority to make or give any representation or warranty in relation to this property. We would strongly recommend that all the information we provide about the property is verified by yourself on inspection. We have not carried out a survey nor have we tested any appliances, services or specific fittings at the property.