

Agents Note: Whilst every care has been taken to prepare these sales particulars, they are for guidance purposes only. All measurements are approximate and whilst every care has been taken to ensure their accuracy, they should not be relied upon and potential buyers are advised to check the measurements themselves.

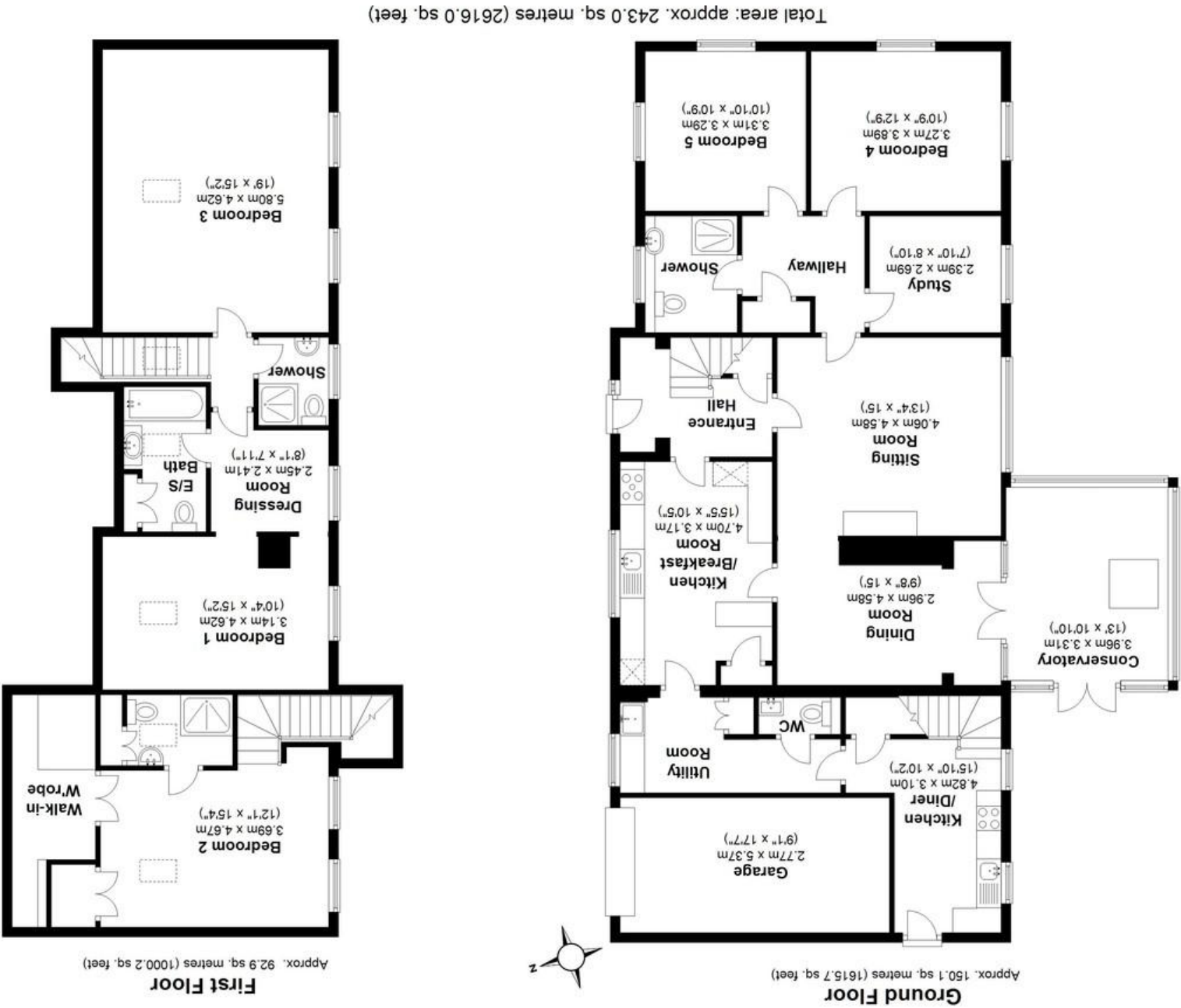

6 Brockleaze, Neston, Corsham, Wiltshire, SN13 9TJ



## 6 Brockleaze, Neston, Corsham, Wiltshire, SN13 9TJ

- Spacious chalet bungalow
- 5/6 Bedrooms, 4 Bathrooms
- Kitchen / Breakfast room
- Garage plus ample parking
- Versatile accommodation
- 4 Reception rooms
- Self contained annexe
- Large established gardens

£585,000

### Situation and Description

This spacious detached chalet style home, situated in the sought after village of Neston, offers extremely spacious and flexible accommodation, including a part of the house which is currently used as a self contained one bedroom annexe..

The vast ground floor accommodation in the main part of the house includes a sitting room with wood burner and underfloor heating, kitchen/breakfast room, dining room, conservatory with wood burner and French windows opening onto the attractive south facing garden, utility room, cloakroom, shower room, study/bedroom 6, and two double bedrooms. Upstairs there is another shower room and two large double bedrooms with one having a dressing area and en-suite bathroom.

The right hand side of the house, which is accessed through the utility room but also has its own private entrance comprises kitchen/diner, double bedroom with walk-in wardrobe and en-suite shower room.

To the front of the property there is large block paved drive for parking numerous vehicles and a single garage. The front garden is well enclosed by hedging and is very private. There is a lovely south facing garden to the rear which is predominately lawned with a good sized paved patio seating area to the side.

Neston is a sought after village with a strong community spirit and an excellent range of local facilities, which include a highly favoured primary school, church, pub, village hall and farm shop. The historic town of Corsham is a short drive away, as is the Georgian heritage city of Bath.

EPC Rating C



### Directions

From our office turn left on to Pickwick Road and turn right at the mini roundabout into Pound Pill. Continue along this road and turn right into Dicketts Road, and then left onto Lypiatt Road towards Neston. Upon reaching the fork continue straight over into Rough Street and continue on to the 'T' junction and right into Brockleaze where the property will be found on the left hand side.