



St Albans Road, London NW10

£445,000 Leasehold

*** SOLE AGENTS ***

mile... are delighted to present to the market this stunning CHAIN FREE recently refurbished three bedroom apartment in NW10. This rare and unique property comes to the market having recently being completely refurbished. For entrance, one can either gain access via a communal hallway to the front, or one's own private entrance from the kitchen. Starting from the kitchen area, this is beautifully contemporary fully fitted kitchen benefits from sleek and stylish finishes and brand new Miele appliances. From the kitchen one gains access to the large open plan living area, ideal for both relaxing and entertaining; further into the property one finds two stunning bathrooms (one being an en-suite) and three great sized bedrooms. Benefitting from a long lease, quiet neighbours and chain free sellers - this completely refurbished property is ideal for those looking for the area wanting a light and spacious flat with room to grow and work from home. St Albans Road is ideally positioned close to all the local amenities of Harlesden and is within easy reach of a wide selection of shops, bars and restaurants of Willesden Junction. Maple Walk school and Roundwood Park open space are only a few minutes' walk from the property. Short walk to Harlesden tube (Bakerloo line/Overground).

- Ground floor flat
- Three bedrooms
- Two bathrooms (one en-suite)
- Own entrance
- Off street parking
- Newly refurbished
- Stunning condition
- Communal garden
- Chain Free
- Close to shops and transport

Approximate Gross Internal Area
788 sq ft - 73 sq m

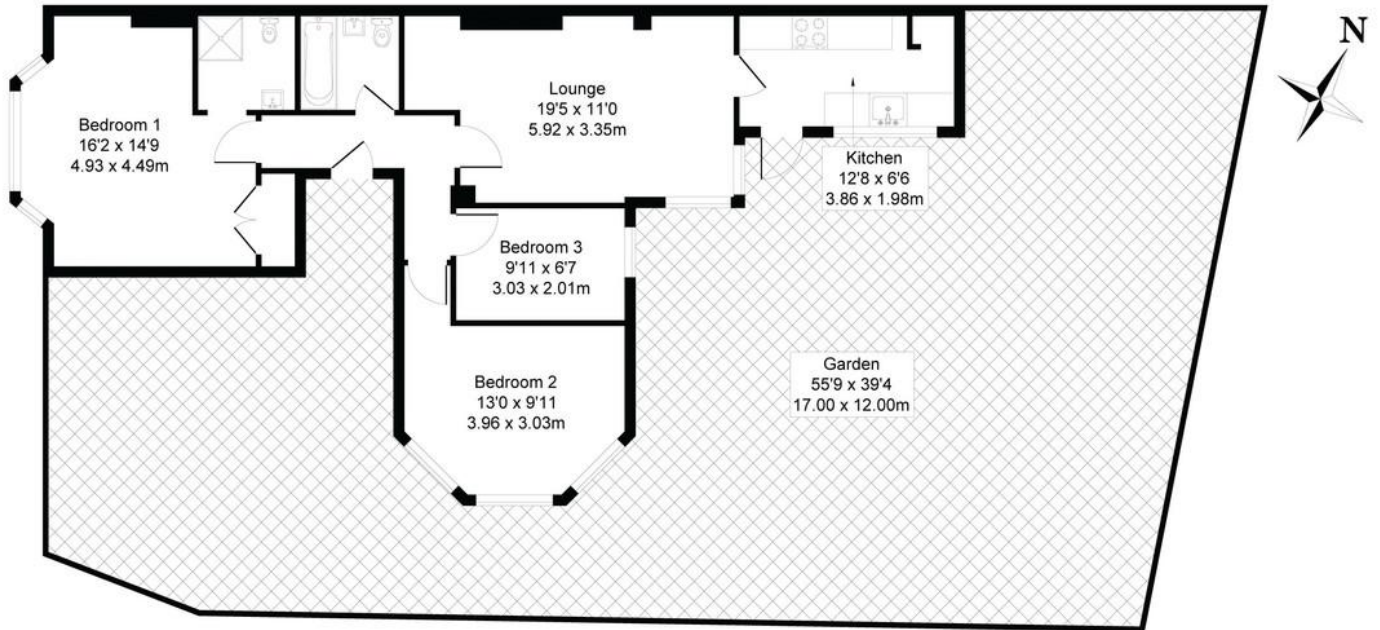

MONEY LAUNDERING REGULATIONS 2003: Intending purchasers will be asked to produce identification documentation at a later stage and we would ask for your co-operation in order that there will be no delay in agreeing the sale.

General: While we endeavour to make our sales particulars fair, accurate and reliable, they are only a general guide to the property and, accordingly, if there is any point which is of particular importance to you, please contact the office and we will be pleased to check the position for you, especially if you are contemplating travelling some distance to view the property.

Measurements: These approximate room sizes are only intended as general guidance. You must verify the dimensions carefully before ordering carpets or any built-in furniture.

Services: Please note we have not tested the services or any of the equipment or appliances in this property, accordingly we strongly advise prospective buyers to commission their own survey or service reports before finalising their offer to purchase.