



Rutherford Road

ASTON FIELDS

40% Shared Ownership

£116,000

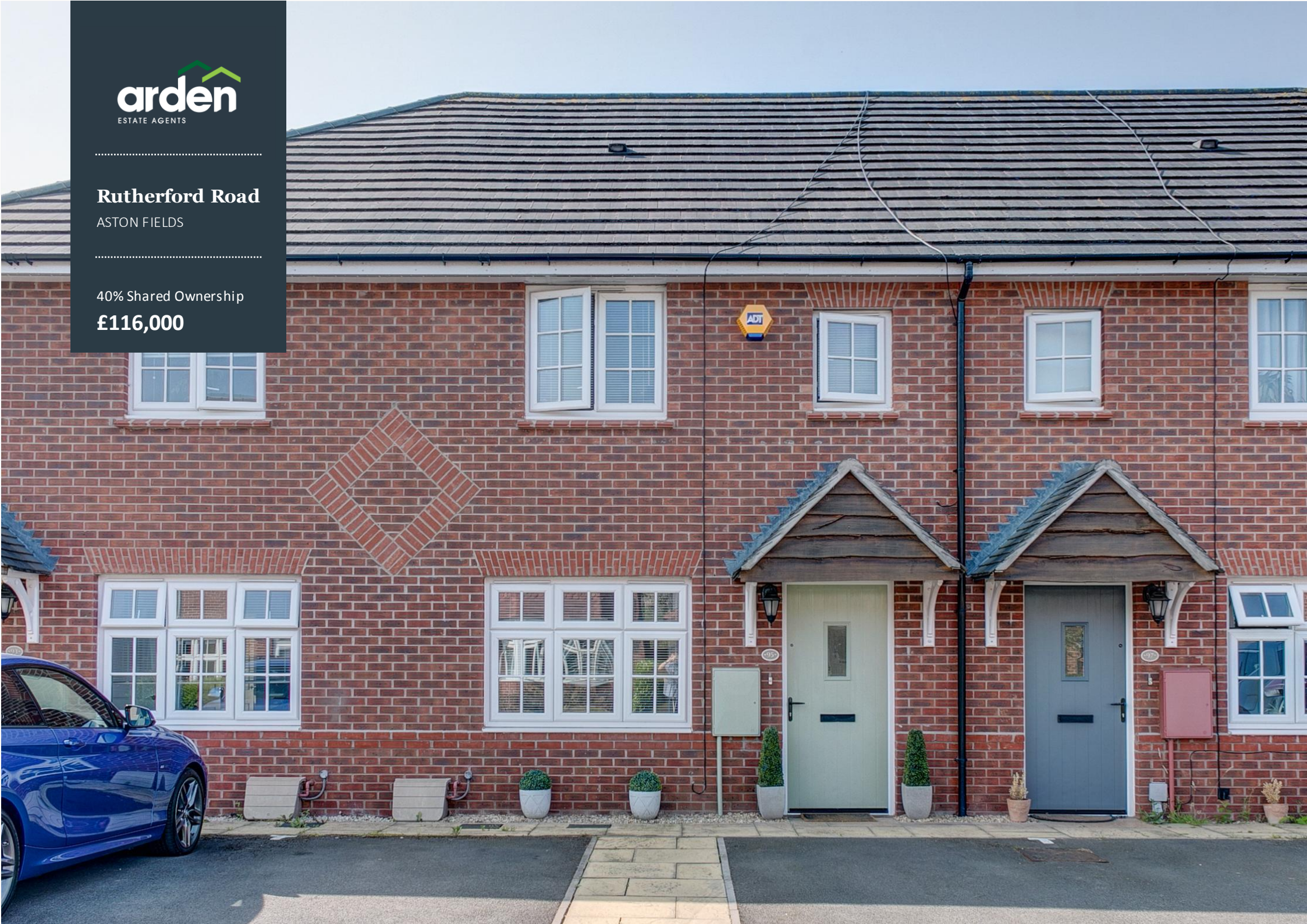

Two Bedroom Mid-Terraced House

Features.

- TWO DOUBLE BEDROOMS
- CONTEMPORARY BATHROOM AND DOWN STAIRS WC
- MODERN LOUNGE
- STUNNING KITCHEN/DINER WITH INTEGRATED APPLIANCES
- LANDSCAPED REAR GARDEN
- 2X ALLOCATED PARKING SPACES
- 40% SHARED OWNERSHIP

Description.

A modern, stylish and immaculately presented two bedroom mid-terraced house, built by Redrow to the Heritage range, offered with 40% shared ownership, a stunning kitchen/diner, contemporary bathroom, landscaped rear garden and allocated parking, situated in the popular area of Aston Fields, Bromsgrove.

The property is approached via two allocated parking spaces. Once inside, the hall leads directly into the modern lounge with a door to an inner hall providing; a handy storage cupboard; door to a downstairs wc; and a door into the stunning kitchen/diner with French doors out to the rear garden, a breakfast island and integrated appliances including a microwave, double oven and hob.

Stairs from the hall lead up to the first floor landing with doors radiating off to; the master bedroom with fitted wardrobes; double bedroom two; and the contemporary bathroom with a shower situated over the bath.

Outside, the property enjoys a landscaped rear garden with a paved patio and steps up to a decking sitting area with raised planted beds and hedged/fenced boundaries.

Aston Fields is a small village located to the west of Bromsgrove. With close proximity to the M5 (junctions 4 and 5), M42 (junction 1), and Bromsgrove train station just metres away. The village itself enjoys a number of amenities, independent shops and eateries, and a well sought after Middle School. In addition, the property benefits from additional, non-allocated parking spaces with in close proximity.



Room Dimensions:

Hall

Lounge: 13' 10" x 11' 1" (4.23m x 3.40m) max

Downstairs WC

Kitchen/Diner: 14' 9" x 10' 9" (4.52m x 3.30m)

Stairs To First Floor Landing

Master Bedroom: 14' 9" x 13' 7" (4.52m x 4.15m) max

Bedroom Two: 14' 9" x 8' 4" (4.52m x 2.55m) max

Bathroom: 7' 7" x 7' 0" (2.32m x 2.15m) max



Rutherford Road, Bromsgrove

Ground Floor

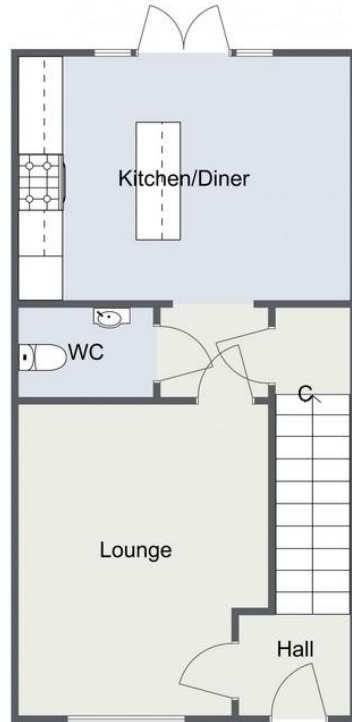

First Floor

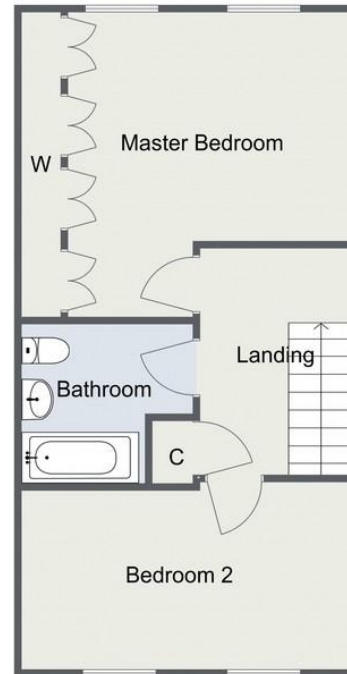

Total Area Approx:
81.1 sq metres (873 sq ft)

For illustrative purposes only. Decorative finishes, fixtures & fittings do not represent the current state of the property. Measurements are approximate & not to scale. Floor Plans made using RoomSketcher.

EPC: B

COUNCIL TAX BAND: B

TENURE: Freehold

.....
For more information on this house or to arrange a viewing please call the Bromsgrove office on:

01527 872 479

.....
Alternatively, you can scan below to view all of the details of this property online.

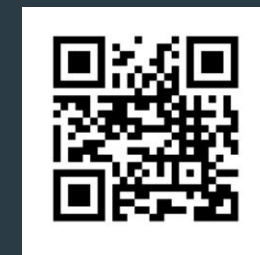

Please read the following: These particulars are for general guidance only and are based on information supplied and approved by the seller. Complete accuracy cannot be guaranteed and may be subject to errors and/or omissions. They do not constitute a contract or part of a contract in any way. We are not surveyors or conveyancing experts therefore we cannot and do not comment on the condition, issues relating to title or other legal issues that may affect this property. Interested parties should employ their own professionals to make enquiries before carrying out any transactional decisions. Photographs are provided for illustrative purposes only and the items shown in these are not necessarily included in the sale, unless specifically stated. The mention of any fixtures, fittings and/or appliances does not imply that they are in full efficient working order and they have not been tested. All dimensions are approximate. We are not liable for any loss arising from the use of these details.

.....
14 Old Birmingham Road
Lickey End
Bromsgrove
B60 1DE