



Seion Place, ##Invalid £150,000

- Four Bedroom Town House
- Set Over Three Floors
- Sash Windows & Juliet Balcony
- En-Suite & Bathroom
- Enclosed Rear Garden
- EPC Rating: C



 4
  2
  1



About the property

Available with no chain is this four bedroom town house set over three floors. The property benefits from off road parking and a rear garden. Comprising entrance hallway, open plan kitchen/living area with sliding doors to rear and cloakroom to ground floor. From the first floor landing are two double bedrooms, one with en-suite and on the second floor you will find a further two bedrooms and family bathroom. Viewing is highly recommended to appreciate this lovely family home. Please call Peter Alan Neath on 01639 635115 to arrange your appointment or book online 24/7.

Accommodation

Entrance Hallway

With access through uPVC door, laminate flooring, radiator, storage cupboard, leading to:

Cloakroom

Carpeted, WC & sink, frosted window to side

Kitchen/living Room

24' 5" max into kitchen x 14' 7" max (7.44m max into kitchen x 4.45m max)

Open plan kitchen living area. The living space is carpeted with sliding doors and window to the rear. The kitchen is laminate flooring, with base and wall units, integrated oven and hob with extractor fan, space for dryer and fridge freezer, wall mounted combi boiler, sink and draining board, sash window to front.

First Floor Landing

Carpeted, leading to:



Bedroom One

8' x 15' 9" (2.44m x 4.80m)

Carpeted, radiator, sash window to front

En-Suite

Carpeted, shower, WC and sink, frosted window to side

Bedroom Two

8' 2" x 14' 8" (2.49m x 4.47m)

carpeted, radiator, window to rear and Juliet balcony with sliding door.

Second Floor Landing

Carpeted, window to side, leading to:

Bedroom Three

8' max x 15' 9" max (2.44m max x 4.80m max)

Carpeted, radiator, sash window to front

Bedroom Four

8' 2" x 14' 8" (2.49m x 4.47m)

Carpeted, radiator, two windows to rear

Bathroom

Carpeted, bath with overhead shower, sink, WC and radiator with frosted sash window to front

External

Property has a lawn frontage with stepping stones to front door. The rear garden is fully enclosed, with patio and lawn area.

Floorplan

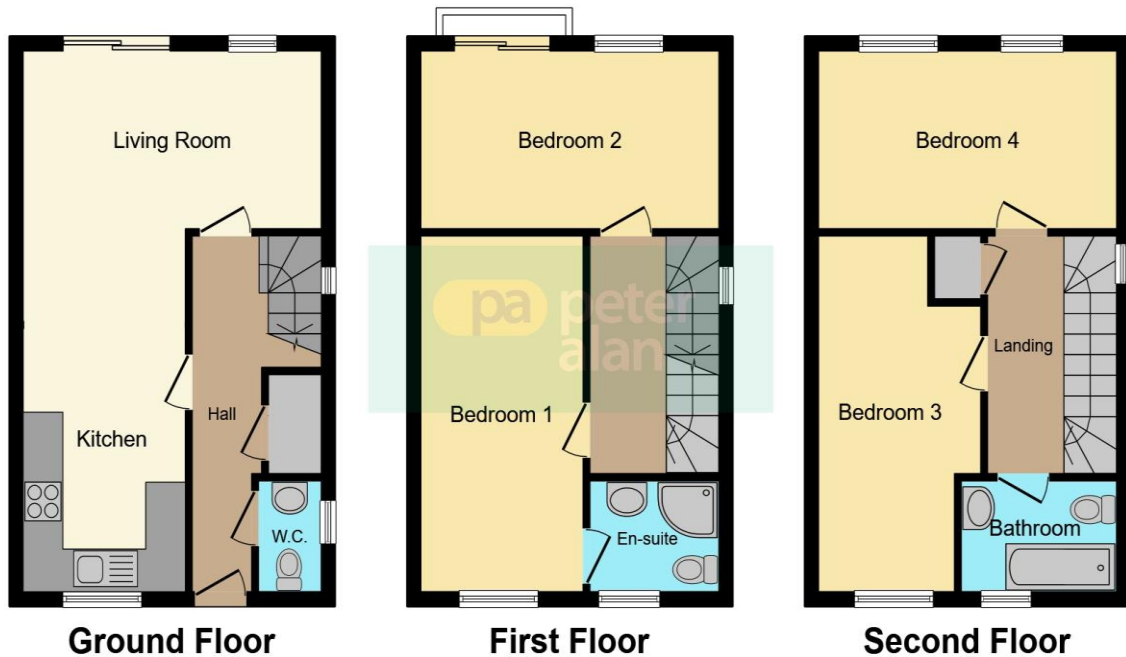

This floorplan is for illustrative purposes only and is not drawn to scale. Measurements, floor-areas, openings and orientations are approximate. They should not be relied upon for any purpose and do not form any part of an agreement. No liability is taken for any error or mis-statement. All parties must rely on their own inspections.

Important Information

Note while we endeavour to make our sales details accurate and reliable, if there is any point which is of particular interest to you, please contact the office and we will be pleased to confirm the position for you. We have not personally tested any apparatus, equipment, fixtures, fittings or services and cannot verify they are in working order or fit for their purposes. Nothing in these particulars is intended to indicate that carpets or curtains, furnishings or fittings, electrical goods (whether wired or not). Gas fires or light fittings or any other fixtures not expressly included form part of the property offered for sale. This computer generated Floorplan, if applicable, is intended as a general guide to the layout and design of the property. It is not to scale and should not be relied upon for dimensions. Tenure: We cannot confirm the tenure of the property as we have not had access to the legal documents. The buyer is advised to obtain verification from their solicitor or surveyor.

Peter Alan Limited is registered in England and Wales under company number 2073153, Registered Office is Cumbria House, 16-20 Hockliffe Street, Leighton Buzzard, Bedfordshire, LU7 1GN. VAT Registration Number is 500 2481 05. For activities relating to regulated mortgages and non-investment insurance contracts, Peter Alan Limited is an appointed representative of Connells Limited which is authorised and regulated by the Financial Conduct Authority. Connells Limited's Financial Services Register number is 302221. Most buy-to-let