



2 Bedroom Ground Floor Apartment £140,000

Alicia Close, Swindon, Wiltshire, SN25 1XE

mcfarlane
property.com

2 Bedroom Ground Floor Apartment North Swindon

- NO ONWARD CHAIN
- LONG LEASE 232 YEARS REMAINING
- GROUND FLOOR APARTMENT
- TWO BEDROOMS

A lovely GROUND FLOOR apartment, within walking distance of local amenities. With a spacious open plan kitchen/diner with modern fitted kitchen, TWO BEDROOMS with master benefiting from FITTED WARDROBES and a large modern family bathroom suite. There is also secure phone entry system, one ALLOCATED PARKING space and GAS CENTRAL HEATING. Located in the popular residential location of Taw Hill, North Swindon, this sought-after area is near to both the local shops, schools and parks for children of all ages.

Lease 232 years remaining.
£1526 service charge pa.
£100 ground rent pa.
Council Tax Band Band C
Council Tax Estimate £1,954





Ground Floor
Approx. 50.3 sq. metres (541.0 sq. feet)

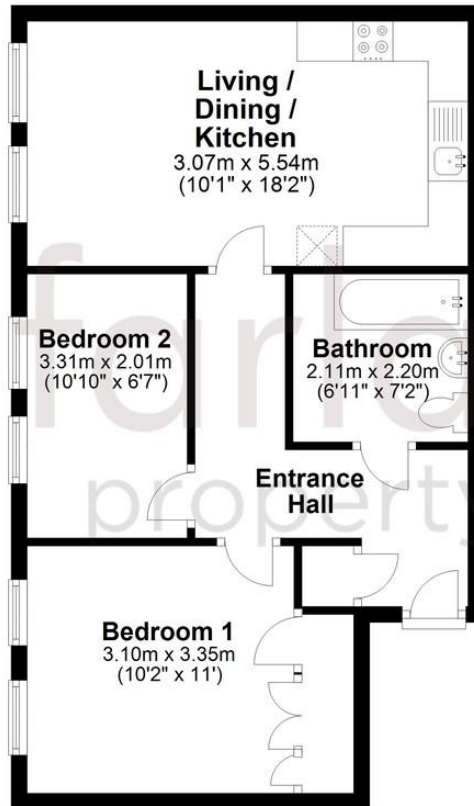

Total area: approx. 50.3 sq. metres (541.0 sq. feet)

We 
where you
LIVE

Our team are friendly, experienced and are all local. They know it better than they do their own living rooms and can help you find what you're looking for because **we love where we live.**

We would be delighted to show you around this property.

**Because every home
needs a personal touch.**

**If you would like to view this
property then please get in touch.**

📞 01793 296600

✉ swindon@mcfarlaneproperty.com

mcfarlaneproperty.com

mcfarlane
property.com

Cricklade.
102 High Street
Cricklade SN6 6AA
📞 01793 751044

Marlborough.
106 High Street
Marlborough SN8 1LT
📞 01672 514380

Old Town.
28-30 Wood Street
Swindon SN1 4AB
📞 01793 296880

Swindon.
The Village Centre,
Redhouse SN25 2FW
📞 01793 296600

Agents Note: Whilst every care has been taken to prepare these sales particulars, they are for guidance purposes only. All measurements are approximate are for general guidance purposes only and whilst every care has been taken to ensure their accuracy, they should not be relied upon and potential buyers are advised to recheck the measurements