



**60 Out Westgate,
Bury St. Edmunds, Suffolk.**

**DAVID
BURR**



60 OUT WESTGATE, BURY ST. EDMUNDS, SUFFOLK. IP33 3NT

The Cathedral town of Bury St Edmunds lies in West Suffolk at the heart of East Anglia famous for its Benedictine Abbey. The town has extensive facilities and amenities to cater for all walks of life and has exceptional transport links. The A14 bypasses the town and links the Midlands with the East coast. London via the M11 is 60 miles. The railway station offers services to Cambridge, Norwich and Ipswich with connections for London. A commuter rail link is available at Stowmarket.

An attractive detached family home with spacious and versatile accommodation just a stone's throw from the town centre that could be used in various ways and would suit multi-generational living. The Coach House and The Studio would work well for those wishing to run a business from home (subject to any necessary consents) or those that simply have hobbies requiring space. The versatile accommodation is further complemented by off-road parking and charming gardens.

An elegant detached townhouse with versatile accommodation ideally placed for amenities and with the benefit of off-road parking and a charming garden.

THE RISE

ENTRANCE HALL: An inviting area with oak wood flooring, useful storage cupboard and staircase off.

DRAWING ROOM: A light room with an oak wood floor, fireplace with a moulded wood surround and a slate tiled hearth.

DINING ROOM: A feeling of space is created by the opening that links with the drawing room.

KITCHEN: Divided into two distinct areas with a wall of bi-folding glass opening to create an 11ft wide access onto terracing and the garden beyond. The kitchen area has been finished with an extensive range of matching modern units and thick Quartz worktops that incorporate a sink unit with mixer tap over. There are deep pan drawers, integrated fridge/freezer, dishwasher, 2 ovens and a 5-ring gas hob with extractor fan over.

UTILITY ROOM: A spacious room with a door to the garden. Oak wood worktops with inset sink and mixer tap over. Plumbing for washing machine and space for tumble dryer.

CLOAKROOM: Large fitted cloaks cupboard. Heated towel rail, WC and wash hand basin with storage below.

First Floor

LANDING: Linen cupboard, access to loft storage space and doors to:-

BEDROOM 1: Views over the garden with roof top view beyond.

BEDROOM 2: Large walk-in wardrobe with hanging rail and shelving.

BEDROOM 3: Built-in wardrobe.

60 OUT WESTGATE, BURY ST. EDMUNDS, SUFFOLK. IP33 3NT

FAMILY BATHROOM: With a large fully tiled shower cubicle, deep double ended contemporary bath, heated towel rail, WC and wash hand basin with storage below.

THE FLAT, 60A OUT WESTGATE STREET

KITCHEN/LIVING ROOM: Divided into two distinct areas with an entrance door at the front and a door to the garden at the rear. The kitchen area has been finished with a matching range of units, worksurfaces with inset stainless-steel sink and mixer tap over. Integrated oven with hob and extractor fan over. Plumbing for washing machine. Door to:-

BEDROOM: Overlooking the garden.

WET ROOM: Finished with full floor and wall tiles, distinct shower area, heated towel rail, WC and wash hand basin.

THE COACH HOUSE

LIVING/DINING ROOM: A versatile space with 18ft wide wall of bi-folding glass finished with slate tiled floor, shelving, storage cupboards and offering a potential for a variety of different purposes.

KITCHEN/BREAKFAST ROOM: With a wall of glass incorporating double doors opening onto terracing. Finished with a slate tiled floor, an extensive range of storage cupboards and worktops with inset single drainer sink unit with mixer tap over. Integrated oven, 5-ring gas hob and extractor fan over. Lift for a wheelchair, well placed alongside the staircase to provide access to the first floor.

UTILITY/CLOAKROOM: Fitted WC, plumbing for washing machine and worktops with inset stainless steel sink unit.

BEDROOM: Large set of double doors, slate tiled floor and extensive fitted wardrobes. Door to:-

DRESSING ROOM: Fitted wardrobes, storage cupboards and worktop. Door to:-

ENSUITE BATHROOM: A spacious room with fully tiled shower area, deep double ended bath with contemporary fittings and shower attachment, WC and wash hand basin.

First Floor

LANDING: Doors to:-

STUDIO: A versatile space currently utilised as a games room/office area with extensive fitted shelving, good natural light and double doors opening on to decking and the garden beyond.

GUEST SUITE: Cleverly designed to include a bedroom space with double doors and an area of fitted worktops inset sink and a door to:-

ENSUITE: Large double shower cubicle, heated towel rail, WC and wash hand basin.

Outside

A high red brick wall defines the front boundary with a gate opening to a large brick paved area of **OFF-ROAD PARKING**. Central herringbone patterned steps rise to the upper level, bordered by lavender and roses. Various other areas of garden incorporate areas of lawn to front and rear, areas of terracing and a particularly impressive entertaining space. External lighting and power point. There is also a useful: **STUDIO/WORKSHOP:** A very recent addition, only completed in April 2024. Built to a very high specification, insulated and power connected.

SERVICES: Main electricity, drainage and water are connected. Gas fired heating. Underfloor heating in The Rise bathroom and at ground floor in The Coach House **NOTE:** None of these services have been tested by the agent.

60 OUT WESTGATE, BURY ST. EDMUNDS, SUFFOLK. IP33 3NT

LOCAL AUTHORITY: West Suffolk Council: 01284 763233. Council Tax Band: D - £2,086.39 – 2024. Annexe: Band D - £2,086.39 – 2024.

EPC RATING: The Rise: D. The Flat: C. The Coach House: C. Reports available upon request.

BROADBAND SPEED: Up to 1000 Mbps (source Ofcom).

MOBILE COVERAGE: EE, Three, O2 and Vodafone – outdoor, likely (source Ofcom). **NOTE:** David Burr make no guarantees or representations as to the existence or quality of any services supplied by third parties. Speeds and services may vary and any information pertaining to such is indicative only and may be subject to change. Purchasers

WHAT3WORDS: ///basic.tunnel.perfumes.

VIEWING: Strictly by prior appointment only through DAVID BURR Bury St Edmunds 01284 725525.

NOTICE: Whilst every effort has been made to ensure the accuracy of these sales details, they are for guidance purposes only and prospective purchasers or lessees are advised to seek their own professional advice as well as to satisfy themselves by inspection or otherwise as to their correctness. No representation or warranty whatever is made in relation to this property by David Burr or its employees nor do such sales details form part of any offer or contract.

Out Westgate, Bury St. Edmunds, IP33

Approximate Area = 2115 sq ft / 196.5 sq m

Annex(s) = 1797 sq ft / 166.9 sq m

Total = 3912 sq ft / 363.4 sq m

For identification only - Not to scale

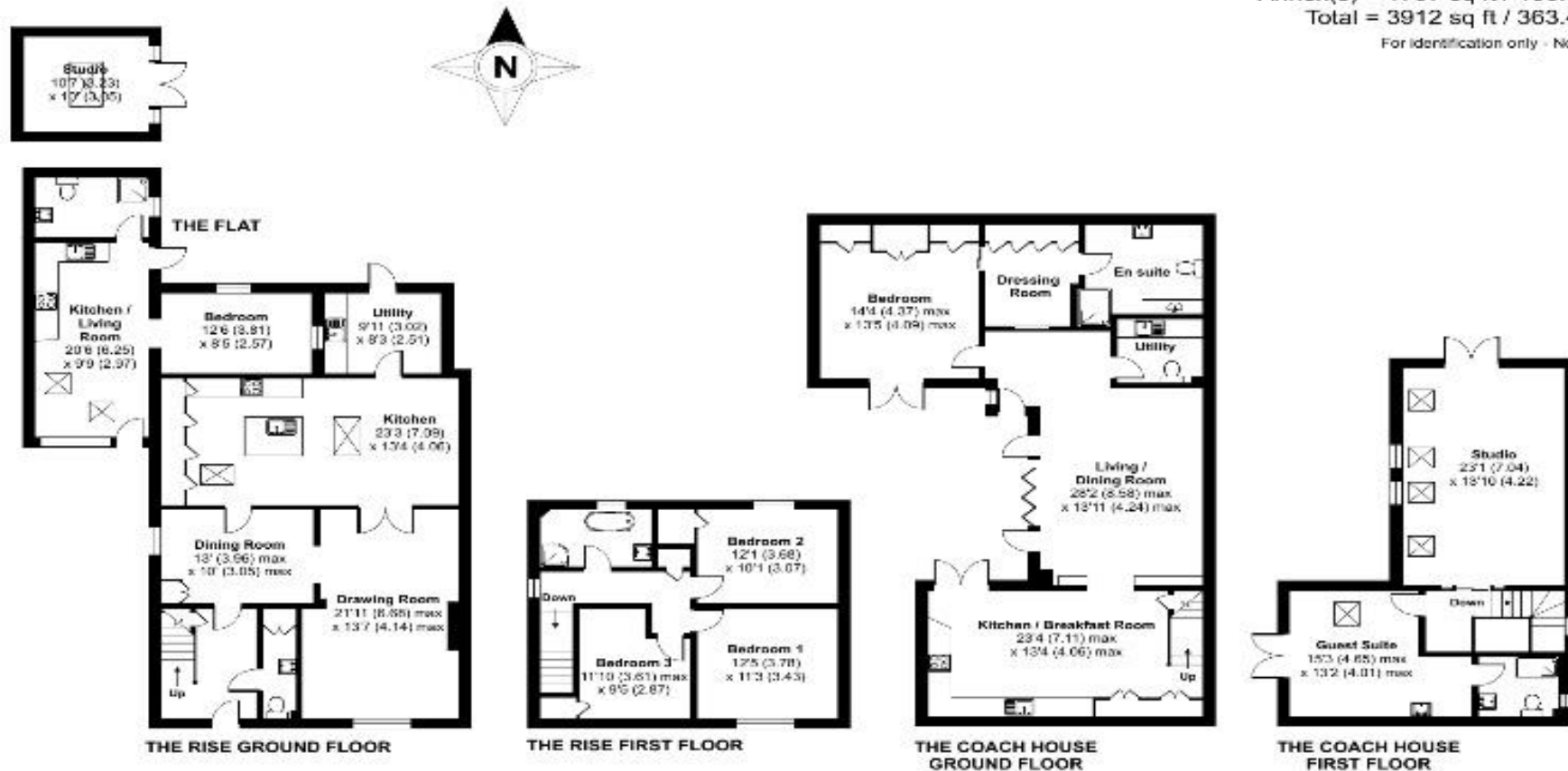

Floor plan produced in accordance with RICS Property Measurement Standards incorporating International Property Measurement Standards (IPMS2 Residential). ©davidburr.com 2024. Produced for David Burr Ltd. REF: 1125035

Bury St Edmunds 01284 725525 Leavenheath 01206 263007 Clare 01787 277811 Castle Hedingham 01787 463404 Woolpit 01359 245245

Newmarket 01638 669035 Long Melford 01787 883144 London 020 78390888 Linton & Villages 01440 784346

