



HOLLY LODGE, WEST END LANE, HA5 1HE



Nestled in the heart of the charming Pinner Village, this purpose-built, ground-floor two-bedroom maisonette offers an ideal opportunity for those looking to downsize without compromising on space or comfort. Bathed in natural light, this bright and airy home is within a short, easy stroll of the quaint village shops and highly regarded West Lodge Schools.

As you step through your own private front door, you're welcomed by a generously sized entrance hallway. The inviting lounge features large windows and doors that open directly onto the serene communal rear garden, perfect for enjoying peaceful moments outdoors. The contemporary fitted kitchen boasts a range of modern wall and base-mounted units, providing ample storage and style.

The property offers two well-proportioned bedrooms, both designed to maximize comfort, along with a family bathroom.

Additional highlights include:

Central location in sought-after Pinner Village

Ground-floor maisonette, purpose-built in 1980

Two spacious bedrooms

Stylish, modern kitchen

Family bathroom with contemporary finishes
Lounge with direct access to communal gardens

Private garage located in a nearby block

Council: Harrow Borough

NEW LEASE UPON COMPLETION

This maisonette presents an excellent opportunity for those seeking a tranquil, low-maintenance lifestyle in a picturesque village setting.



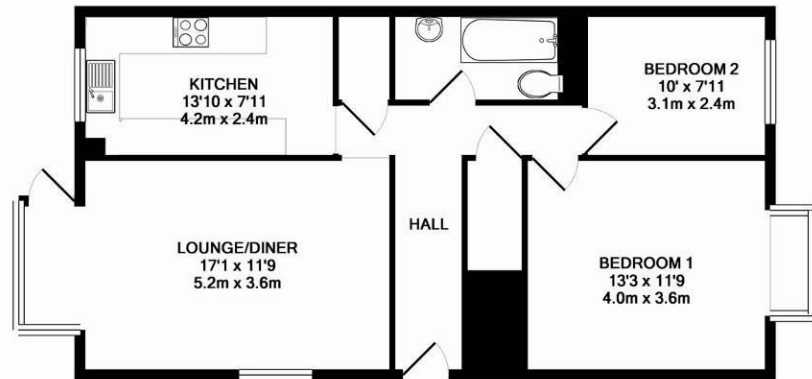

TOTAL APPROX. FLOOR AREA 743 SQ.FT. (69.0 SQ.M.)

Whilst every attempt has been made to ensure the accuracy of the floor plan contained here, measurements of doors, windows, rooms and any other items are approximate and no responsibility is taken for any error, omission, or mis-statement. This plan is for illustrative purposes only and should be used as such by any prospective purchaser. The services, systems and appliances shown have not been tested and no guarantee as to their operability or efficiency can be given

Made with Metropix ©2014



