



HEXAGON APARTMENTS, NEWTON STREET, COVENT GARDEN

£958,000
LEASEHOLD

HEXAGON APARTMENTS | One Bedroom | Residents Concierge Services | No Chain | Located in the heart of Covent Garden

Davidson

NEWTON STREET

Incredible Location | Concierge Services

| Sold with NO CHAIN | Good-sized 1

Bed Apartment | Holborn Station 2 mins

Away | Short Walk to LSE | | |



Davidson Estates are delighted to present this spacious one bedroom apartment located in the popular Hexagon Apartments development.

This apartment is in excellent condition and is tastefully decorated, comprises of an airy and spacious hallway entrance with cloak room, a beautifully designed open-plan living room with fully integrated kitchen and breakfast bar and a spacious bedroom with built-in wardrobe.

Additional benefits to this property include and well maintained communal entrance, lift and 24 hour concierge services.

The Hexagon Apartments are located at the heart of London's Covent Garden, close to the West End, Bloomsbury, the City, and the River Thames. The strategic and coveted location of the development allows for convenient access to world-class culture, retail, leisure and dining.

The property benefits from excellent transport connections and lies within 5 minutes walking distance of Covent Garden (Piccadilly Line), and Tottenham Court Road stations (Central, Northern and Elizabeth Lines) with Holborn (Piccadilly and Central Lines) 2 minutes away.

Financial Information:

Service Charge: £6500.00 pa

Years remaining on lease: 120

Ground Rent: £30.00 pa

Estimate Rental Figure: £3500 pcm

NEWTON STREET



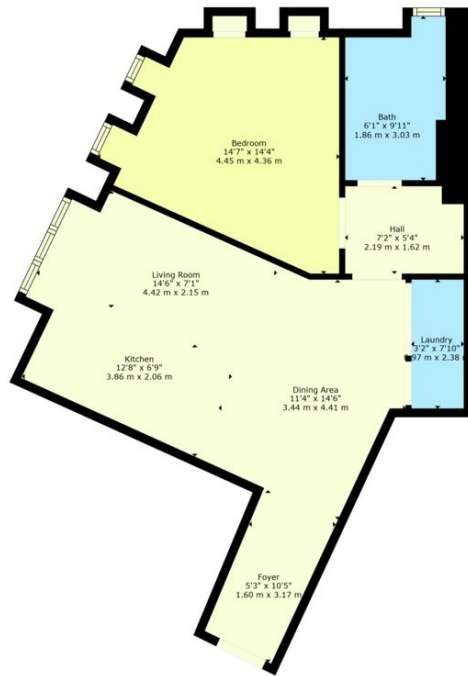

TOTAL: 629 sq. ft, 58 m2
 FLOOR 1: 629 sq. ft, 58 m2
 EXCLUDED AREAS: UNDEFINED: 4 sq. ft, 0 m2

Please Be Aware That The Dimensions In These Floor Plans Are Close Approximations And May Not Reflect Exact Measurements.

Energy Efficiency Rating			
Score	Energy rating	Current	Potential
92+	A		
81-91	B	← 85 B	← 85 B
69-80	C		
55-68	D		
39-54	E		

Davidson

OFFICE
 14 Frederick Road
 Birmingham
 West Midlands
 B15 1JD

0121 455 7727
 info@daavidsonestates.co.uk
 www.daavidsonestates.co.uk

Agents Note: Whilst every care has been taken to prepare these particulars, they are for guidance purposes only. All measurements are approximate and are for general guidance purposes only and whilst every care has been taken to ensure their accuracy, they should not be relied upon and potential buyers/tenants are advised to recheck the measurements