



Old Laira Road, Plymouth **Offers Over £135,000**







Old Laira Road, Plymouth

Offers Over £135,000

Property Description

OH MY OLD LAIRA ROAD!!! GUIDE PRICE: £135,000 - £145,000. A perfect property for first time buyers, families or investors! Comprising entrance porch, lounge, dining room, kitchen and a useful outbuilding/utility area to the ground floor. Stairs to the first floor give access to three bedrooms and a family bathroom; the two front facing bedrooms with cracking views out towards the Plym estuary. To the rear there is a courtyard garden enjoying a good deal of privacy. A copy of the EPC will be available on request. EPC Grade E.

Our View

Could it honestly get any better? With the city centre and A38 within close proximity and bus routes leaving from the end of the road, what more can you ask for?

Location

What an impressive example of a period style property! With ample living space, flexible accommodation, access to the city centre and the A38 with RIVER VIEWS! What a fantastic package.



Mid-terrace House
For full EPC please contact the branch

Ground Floor
Floor Size: 56.6 m², 609.7 ft²

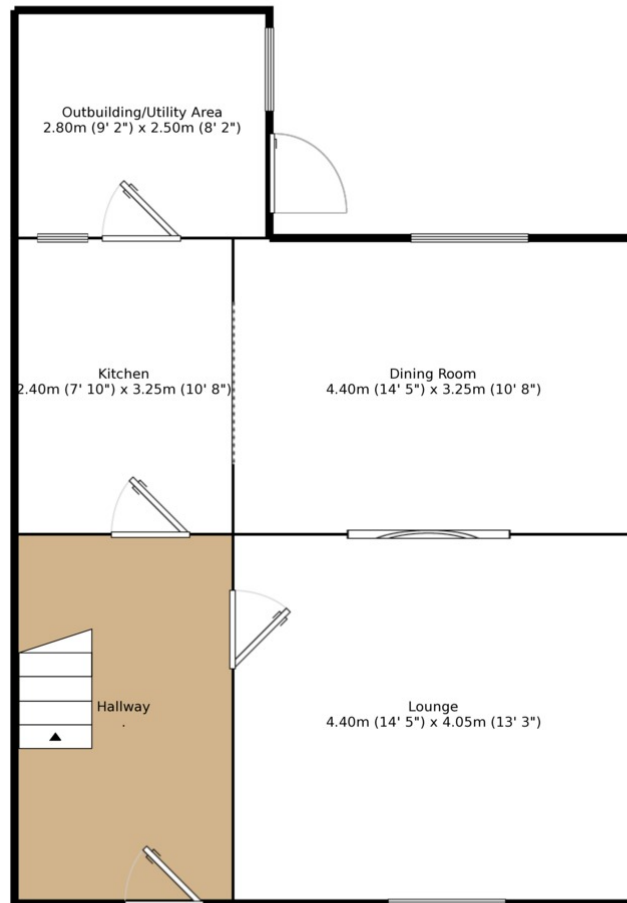

First Floor
Floor Size: 49.6 m², 534.3 ft²

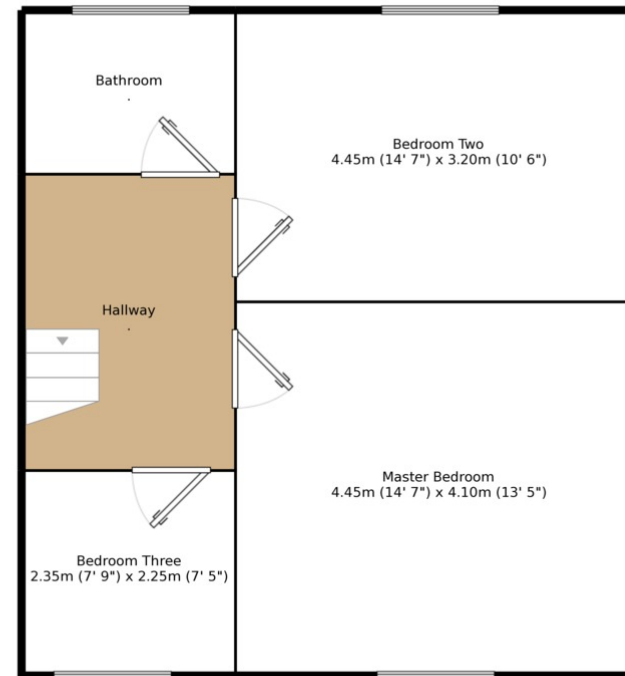

Measurements are approximate. Not to scale. For illustrative purposes only.

IMPORTANT NOTE TO PURCHASERS: We endeavour to make our sales particulars accurate and reliable, however, they do not constitute or form part of an offer or any contract and none is to be relied upon as statements of representation or fact. The services, systems and appliances listed in this specification have not been tested by us and no guarantee as to their operating ability or efficiency is given. All measurements have been taken as guide to prospective buyers only, and are not precise. Floor plans where included are not to scale and accuracy is not guaranteed. If you require clarification or further information on any points, please contact us, especially if you are travelling some distance to view. Fixtures and fittings other than those mentioned are to be agreed with the seller.

Your Move is a trading name of your-move.co.uk, registered in England at Newcastle House, Albany Court, Newcastle Business Park, Newcastle upon Tyne NE4 7YB (number 01864469).

*Calls may be recorded and/or monitored for training and/or security purposes.

C/O Your Move, 2 Mannamead Road, Mutley,
Plymouth, PL4 7AA

01752 220401 * plymouth@your-move.co.uk

