



Station Road, Market Bosworth, Leicestershire **£245,000**





YOUR MOVE





Station Road, Market Bosworth, Leicestershire

£245,000

Property Description

A slice of heaven awaits the lucky buyer of this beautifully presented home, Offering panoramic views of the Market Bosworth countryside and situated close to the heart of this highly sought after historic village. Accommodation briefly comprises Entrance Hall, Lounge, Kitchen/Diner, Rear Lobby, Cloakroom/WC, Landing, Three Bedrooms, Family Bathroom and Gardens. This is where your search ends if your lucky enough to acquire this dream home. Call for viewing without delay. A copy of the EPC will be available on request. EPC Grade C.

Our View

Opportunities like this don't come along often in beautiful Market Bosworth. This spacious three bedroom will suit any buyer looking to move into this highly sought after location and you are advised to call for a viewing without delay to save on disappointment.

Location

Birthplace of the Tudor Dynasty Historic Market Bosworth has been famous amongst historians and school children around the world for the last 500 years and more. With Many a mention in Shakespeare's Legendary Richard the III this village is truly an aspirational location in every sense of the word. Regional and National finalists many years running in the RHS Britain in Bloom competition the village is awash with colour!



EPC Grade C

For full EPC please contact the branch

Ground Floor
Floor Size: 52.5 m², 564.9 ft²

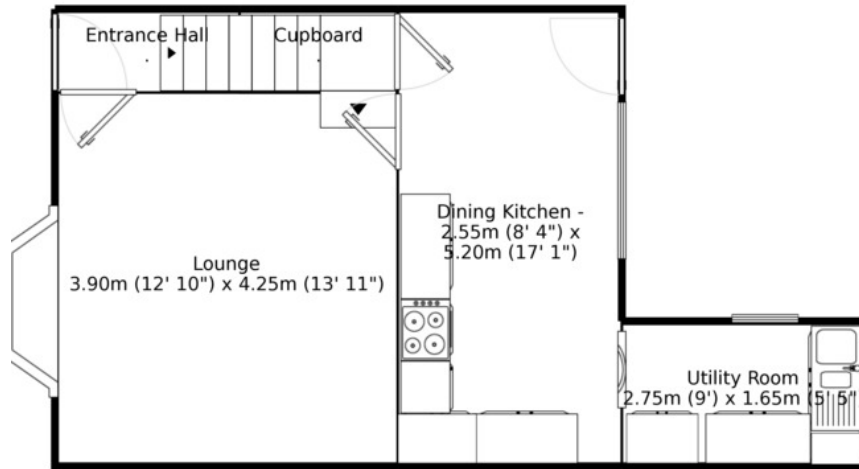
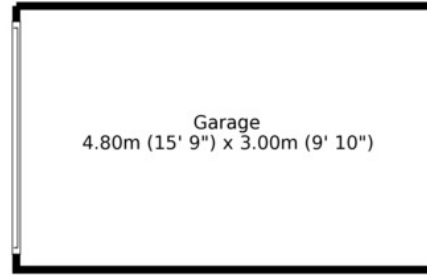

First Floor
Floor Size: 34.3 m², 369.4 ft²

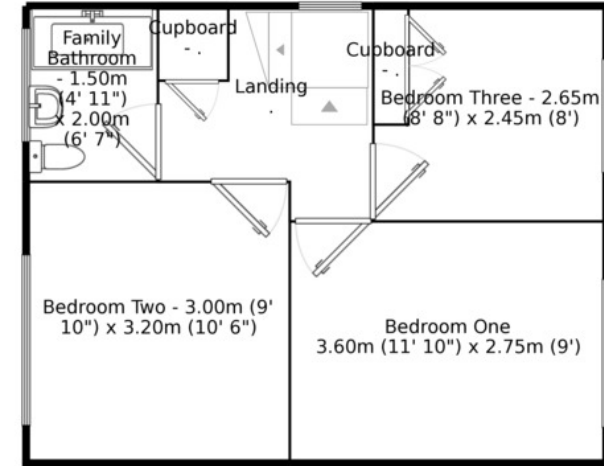

Measurements are approximate. Not to scale. For illustrative purposes only.

IMPORTANT NOTE TO PURCHASERS: We endeavour to make our sales particulars accurate and reliable, however, they do not constitute or form part of an offer or any contract and none is to be relied upon as statements of representation or fact. The services, systems and appliances listed in this specification have not been tested by us and no guarantee as to their operating ability or efficiency is given. All measurements have been taken as guide to prospective buyers only, and are not precise. Floor plans where included are not to scale and accuracy is not guaranteed. If you require clarification or further information on any points, please contact us, especially if you are travelling some distance to view. Fixtures and fittings other than those mentioned are to be agreed with the seller.

Your Move is a trading name of your-move.co.uk, registered in England at Newcastle House, Albany Court, Newcastle Business Park, Newcastle upon Tyne NE4 7YB (number 01864469).

*Calls may be recorded and/or monitored for training and/or security purposes.

Residential, 84 Castle Street, Hinckley,
Leicestershire, LE10 1DD

01455 615908 * Hinckley@your-move.co.uk



YOUR MOVE