



A Whitefriars Avenue, Harrow, Middlesex **Offers Around £250,000**





YOUR MOVE





A Whitefriars Avenue,
Harrow, Middlesex

Offers Around £250,000

Property Description

This ground floor maisonette benefits from its own entrance, a lovely spacious kitchen/diner (much larger than what you find in most one bedroom apartments) with a skylight window flooding the area with light, double bedroom off a long hallway, lounge, modern tiled shower room, double glazed windows and front door, Vaillant Combination gas boiler and radiator heating system, block paved frontage providing one off road parking space and a long lease. Well presented throughout and well decorated inside making it a great home that you can just move in to and enjoy. The location is also ideal for a commuter as you have easy access to Harrow & Wealdstone station and there is also a frequent bus service going in to London. EPC Grade B. A full copy of the EPC is available upon request.

Our View

A simply excellent location is what this home offers! If you work in London, then fret no more the local train station is close by and offers a frequent service in to Central London via the Bakerloo line. Inside it is very clean and tidy and features an unusually large kitchen/diner that needs to be seen to be appreciated!

Location

The home is set in a peaceful 'off the road' position making it a very rare find for an apartment and gives it a feeling of real privacy. Close by you have the high street with local shops, supermarkets and restaurants all within walking distance, a local Sunni Mosque is also just a few minutes walk away. You are also a short drive or bus ride right in the centre of Harrow.



Close To Centre Of Harrow
For full EPC please contact the branch

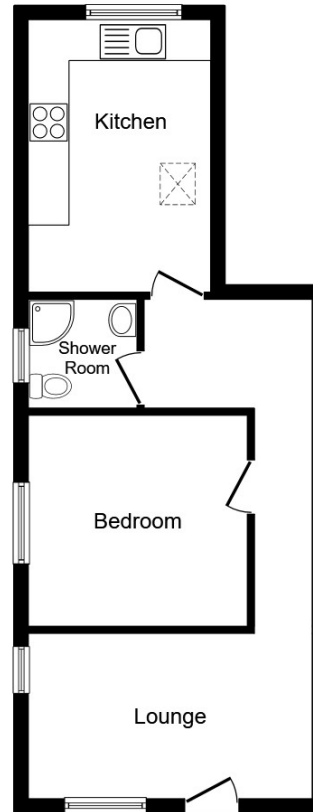

Floor Plan

This plan is for illustration purposes only and may not be representative of the property. Plan not to scale.

Powered by audioagent.com

IMPORTANT NOTE TO PURCHASERS: We endeavour to make our sales particulars accurate and reliable, however, they do not constitute or form part of an offer or any contract and none is to be relied upon as statements of representation or fact. The services, systems and appliances listed in this specification have not been tested by us and no guarantee as to their operating ability or efficiency is given. All measurements have been taken as guide to prospective buyers only, and are not precise. Floor plans where included are not to scale and accuracy is not guaranteed. If you require clarification or further information on any points, please contact us, especially if you are travelling some distance to view. Fixtures and fittings other than those mentioned are to be agreed with the seller.

Your Move is a trading name of your-move.co.uk, registered in England at Newcastle House, Albany Court, Newcastle Business Park, Newcastle upon Tyne NE4 7YB (number 01864469).

*Calls may be recorded and/or monitored for training and/or security purposes.

11 Marlowes, Hemel Hempstead, Hertfordshire,
HP1 1LA

01442 242541 * Hemelhempstead@your-
move.co.uk

