



Chapel Road, Kirkcaldy, Fife   **Fixed £179,999**









Chapel Road, Kirkcaldy,  
Fife

**Fixed £179,999**

### Property Description

Two UNIQUE and DECEPTIVELY SPACIOUS family homes. Both sit on an elevated site within the commuting town of Kirkcaldy and boast far reaching town views with the Lomond Hills in the distance. The generous accommodation, which is arranged over ground, lower ground and first floor, will be ideal for a growing family and represent excellent value for money. Both have private gardens and drives for off street parking. EPC=Exempt

### Our View

The unique internal layout offers fantastic living and sleeping accommodation. All the rooms are of generous proportions and even the halls and landings are over sized, further emphasising the feeling of space. Only by internal viewing can these beautiful homes be fully appreciated.

### Location

Kirkcaldy is situated on the coast of the Firth of Forth and offers a wide range of shopping, recreational facilities and amenities including a theatre, museum and library. There are nursery, primary, secondary and further education facilities. There are town centre rail and bus stations.



**Three Double Bedrooms - Master En-suite**  
**For full EPC please contact the branch**

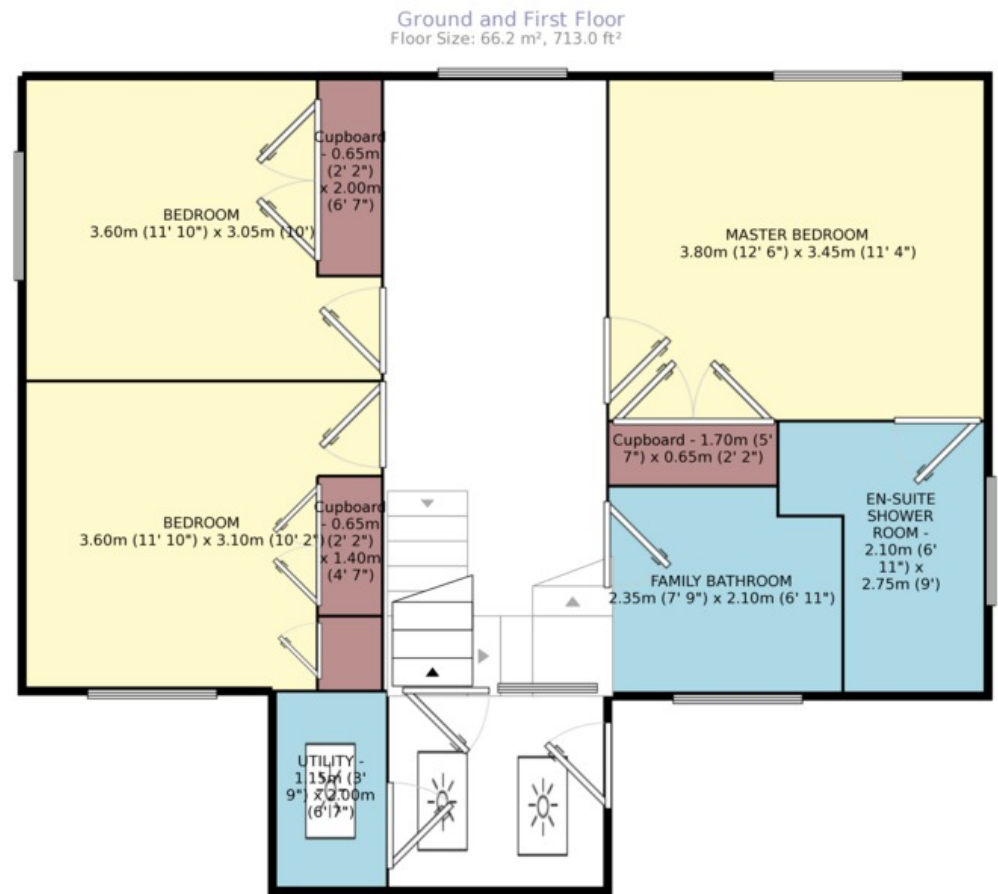
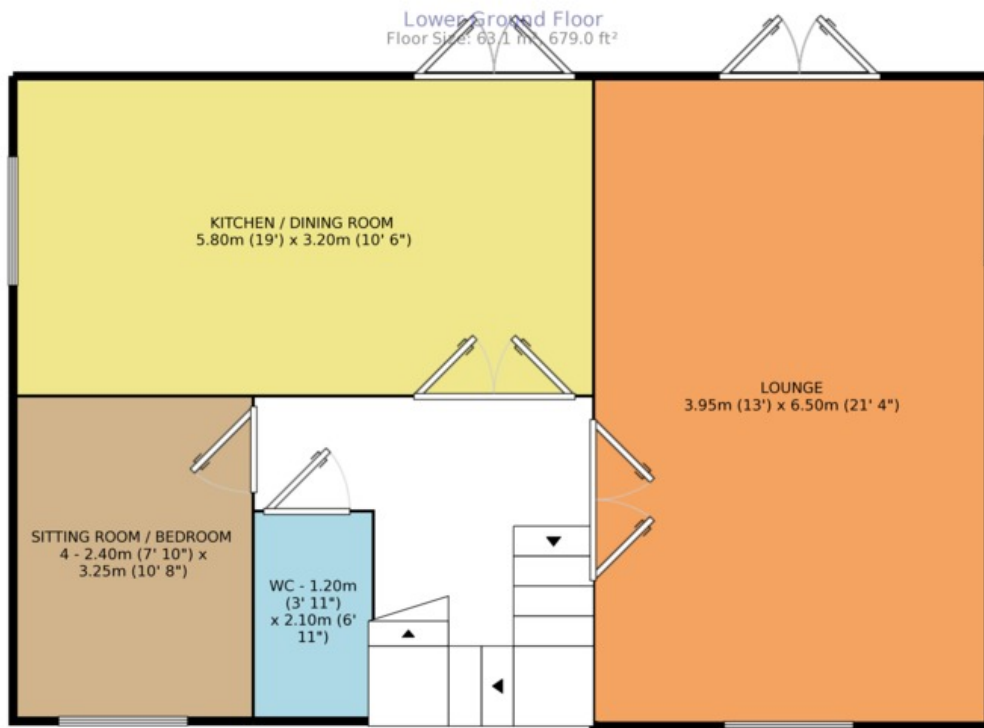

Measurements are approximate. Not to scale. For illustrative purposes only.

IMPORTANT NOTE TO PURCHASERS: We endeavour to make our sales particulars accurate and reliable, however, they do not constitute or form part of an offer or any contract and none is to be relied upon as statements of representation or fact. The services, systems and appliances listed in this specification have not been tested by us and no guarantee as to their operating ability or efficiency is given. All measurements have been taken as guide to prospective buyers only, and are not precise. Floor plans where included are not to scale and accuracy is not guaranteed. If you require clarification or further information on any points, please contact us, especially if you are travelling some distance to view. Fixtures and fittings other than those mentioned are to be agreed with the seller.

Your Move is a trading name of your-move.co.uk, registered in England at Newcastle House, Albany Court, Newcastle Business Park, Newcastle upon Tyne NE4 7YB (number 01864469).

\*Calls may be recorded and/or monitored for training and/or security purposes.

87 High Street, Kirkcaldy, Fife, KY1 1LN

01592 205432 \* [Kirkcaldy@your-move.co.uk](mailto:Kirkcaldy@your-move.co.uk)

