



Guilyhill Court Newbridge Drive, Dumfries **Offers in the region of £95,000**





YOUR MOVE





Guilyhill Court Newbridge Drive, Dumfries

Offers in the region of £95,000



End Of Terrace Family Home
For full EPC please contact the branch

Property Description

We are delighted to welcome to the market a beautifully presented family home situated in a residential cul-de-sac on the northern outskirts of Dumfries. The property has a spacious lounge/dining room with modern fitted kitchen off, to the ground floor. On the first floor there are three spacious bedrooms and a modern bathroom suite. Externally there is an enclosed rear garden with small open front lawn. The property is offered for sale with no onward chain and has been attractively priced for quick sale. Dimensions - Lounge 4.6m by 4.1m, Dining Area 3.0m by 2.65m, Kitchen 2.9m by 2.75m. First Floor Master 4.25m by 2.35m, Bedroom Two 2.95m by 3.4m, Bedroom Three 3.25m by 2.0m, Family Bath 2.95m by 1.95m. EPC Rating = Band C.

Our View

A fantastic home for a young family. Representing fantastic value for money and in 'Move In' condition an opportunity not to be missed. Viewings a Must!!!

Location

Dumfries town centre offers a variety of shops as well as both primary and secondary schools. The surrounding area offers a wide range of country pursuits including sailing, horse riding, mountain biking, fishing, golfing, bird watching, shooting and numerous coastal and woodland walks. The M74 provides transport links to the north and south and is approximately 25 miles to the east.

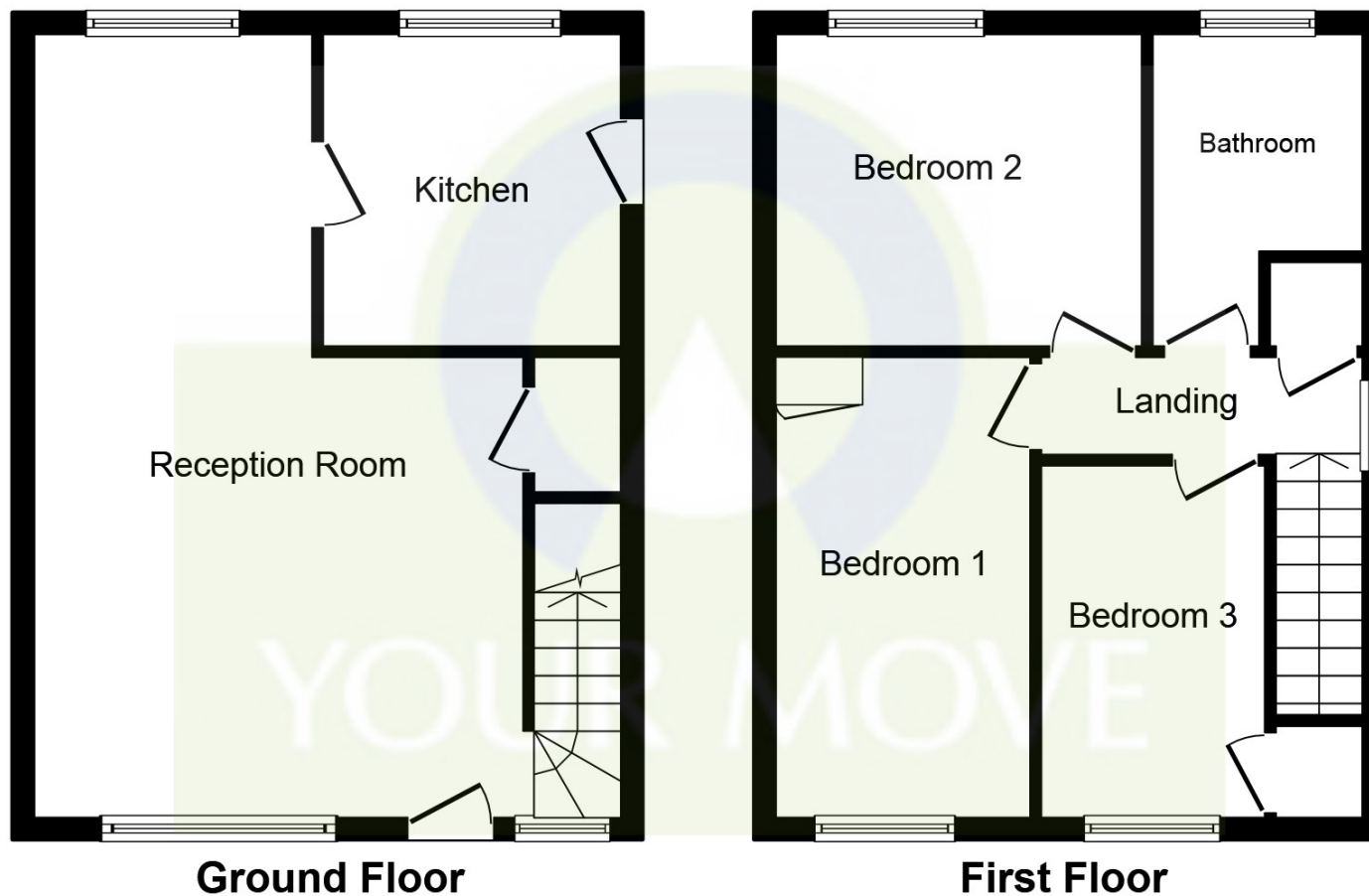

Ground Floor

First Floor

This plan is for illustration purposes only and may not be representative of the property. Plan not to scale.

Powered by audioagent.com

IMPORTANT NOTE TO PURCHASERS: We endeavour to make our sales particulars accurate and reliable, however, they do not constitute or form part of an offer or any contract and none is to be relied upon as statements of representation or fact. The services, systems and appliances listed in this specification have not been tested by us and no guarantee as to their operating ability or efficiency is given. All measurements have been taken as guide to prospective buyers only, and are not precise. Floor plans where included are not to scale and accuracy is not guaranteed. If you require clarification or further information on any points, please contact us, especially if you are travelling some distance to view. Fixtures and fittings other than those mentioned are to be agreed with the seller.

Your Move is a trading name of your-move.co.uk, registered in England at Newcastle House, Albany Court, Newcastle Business Park, Newcastle upon Tyne NE4 7YB (number 01864469).

Queensberry Street, Dumfries, DG1 1EX

01387 257666 * Dumfries@your-move.co.uk

*Calls may be recorded and/or monitored for training and/or security purposes.

