



Matthew James

St James House | St James Road | Surbiton | Surrey KT6 4QH

T: +44 (0) 20 8390 2266

E: enquiries@matthewjamesestateagents.co.uk

www.matthewjamesestateagents.co.uk



Fassett Road, Kingston upon Thames, KT1 2TD

A spacious ground floor studio apartment with a veranda and communal garden. Set in a grand Victorian house within walking distance of Kingston town centre and railway station, the Thames and Surbiton mainline station. The many benefits include a large studio room with tall ceilings and French doors opening onto the veranda. There is a separate modern fitted kitchen with appliances and a shower room with a large storage cupboard. To the rear is large communal garden. At the front, parking on a first come first serve basis. Council tax band B. Sold with a lease of 150 years. We are informed the service charge is approx. £2040 pa. Sold with no onward chain.

Guide Price £230,000 Leasehold

EPC Rating: E

Fassett Road, Kingston Upon Thames, KT1

Approximate Area = 339 sq ft / 31.4 sq m

For identification only - Not to scale

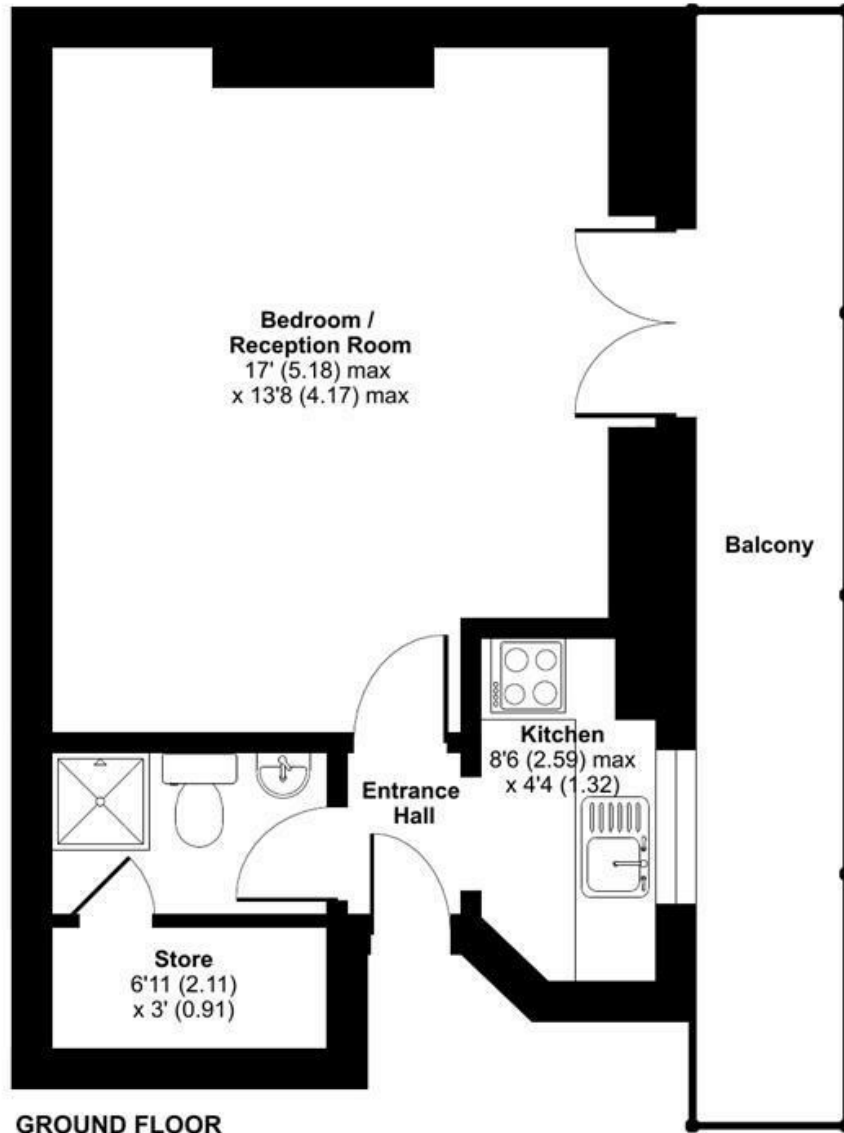

Floor plan produced in accordance with RICS Property Measurement Standards incorporating International Property Measurement Standards (IPMS2 Residential). © nichecom 2024. Produced for Matthew James. REF: 1104727

We aim to make our property details a reliable guide. However they are not guaranteed and do not form part of a contract. Information in relation to lease length, service charge and ground rent has been provided by the vendor, they are likely to be subject to reviews and increases in the future and will need to be verified by your legal representative. Please note that appliances and heating systems have not been tested and therefore no warranty can be given as to their good working order. Carpets, curtains, gas fires, electrical goods/fitings and other fixtures, unless expressly mentioned, are not included in the sale of this property. If there are any important matters which are likely to affect your decision to buy, please contact our office.

