



118 Southwark Bridge Road | London
| SE1 0BQ

Leasehold

£495,000

- Modern apartment block
- One double bedroom
- Central location
- Third floor
- Balcony
- Wood flooring
- Southwark tube
- Borough tube
- Well presented
- Lift to all floors



Stylish Central London apartment on the 3rd floor of this well maintained purpose built block. The apartment has recently been redecorated and has new carpets and flooring throughout. Popular 'South Central' location, walking distance to London Eye, Waterloo, Southbank and Thames River walk. Excellent transport links and walking distance to Southwark tube and Borough tube. One double bedroom, large lounge and balcony. Wood flooring and spot lighting throughout. Lift access to all floors.

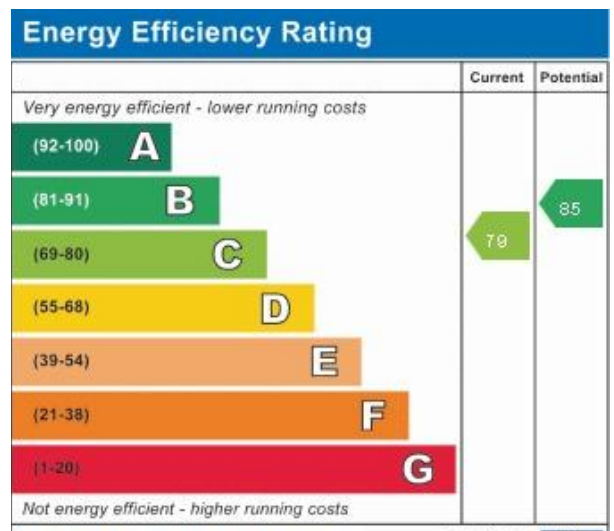

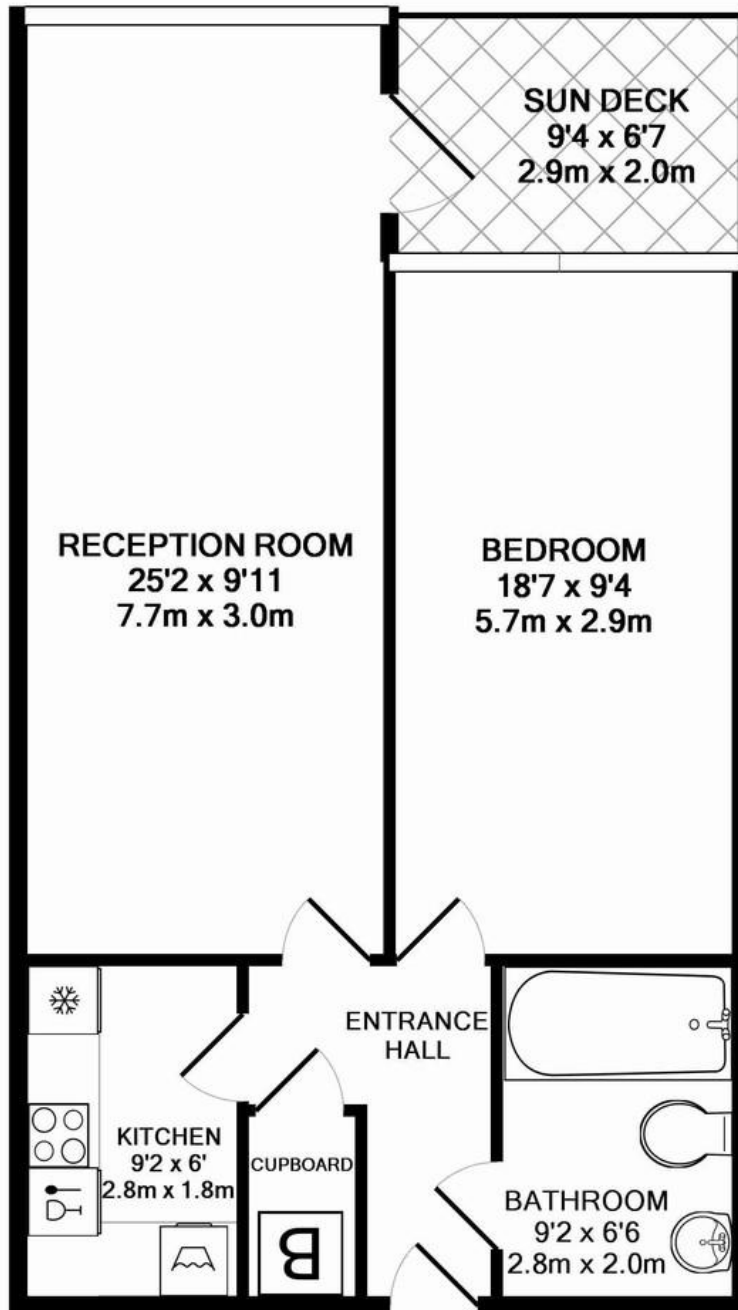

TOTAL APPROX. FLOOR AREA 598 SQ.FT. (55.6 SQ.M.)

It has been made to ensure the accuracy of the floor plan contained here, measurements of rooms and any other items are approximate and no responsibility is taken for any error, omission or inaccuracy. This plan is for illustrative purposes only and should be used as such by any prospective buyer. All services, systems and appliances shown have not been tested and no guarantee can be given as to their operability or efficiency can be given.
 Made with Metropix ©2016

Viewing Arrangements

Strictly by appointment

Contact Details

121 Denmark Hill

London

SE5 8EN

www.urbanvillagehomes.co.uk

sales@urbanvillagehomes.com

020 3519 9121

Agents Note: Whilst every care has been taken to prepare these sales particulars, they are for guidance purposes only. All measurements are approximate and for general guidance purposes only and whilst every care has been taken to ensure their accuracy, they should not be relied upon and potential buyers are advised to recheck the measurements.