



4 Bedroom Semi-Detached House £290,000

Hathaway Road, Swindon, Wiltshire, SN2 7TP

mcfarlane
property.com

4 Bedroom Semi-Detached House Swindon East

-
- Large extended kitchen / Family room
 - Garage and off road parking
 - Ground floor shower room
 - Family bathroom
-

This amazing FAMILY HOME has been EXTENDED to the rear to provide a great open plan space including the NEW FITTED KITCHEN with integrated appliances and matching dining table. The ground floor also benefits from a separate sitting room and shower room.





We where you LIVE

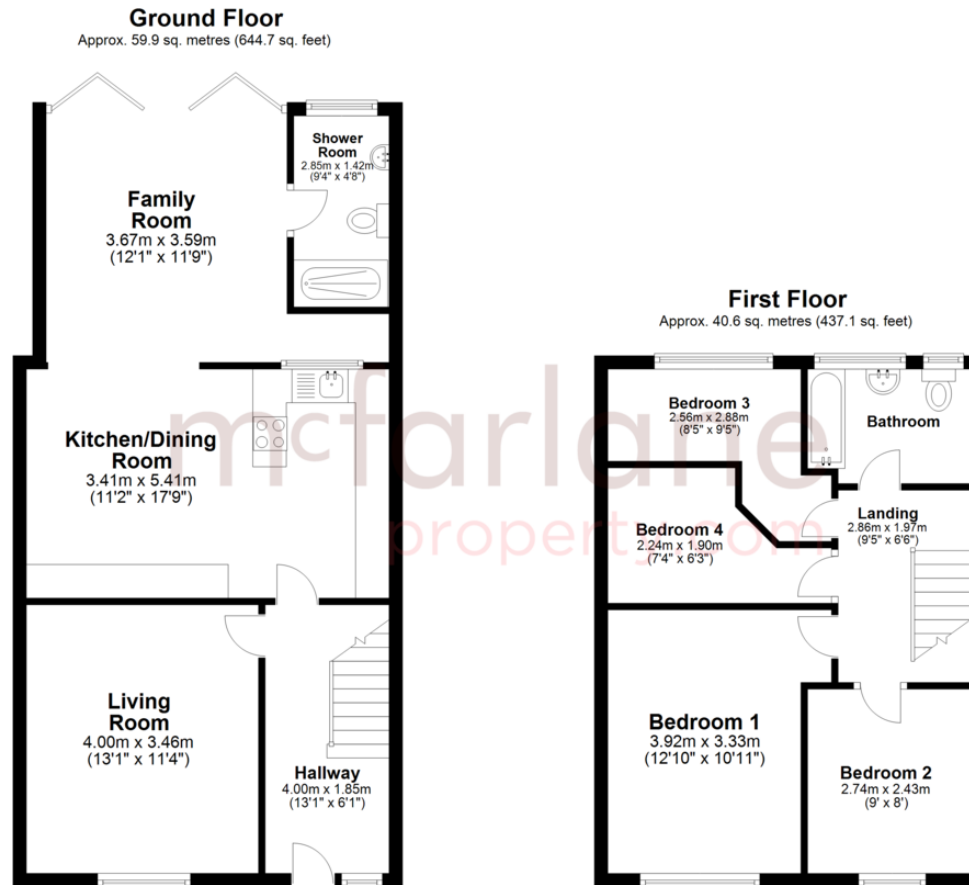

Total area: approx. 100.5 sq. metres (1081.8 sq. feet)

Our team are friendly, experienced and are all local. They know it better than they do their own living rooms and can help you find what you're looking for because **we love where we live.**

We would be delighted to show you around this property.

Because every home needs a personal touch.

If you would like to view this property then please get in touch.

☎ 01793 296600

✉ swindon@mcfarlaneproperty.com

mcfarlaneproperty.com

mcfarlane
property.com

Cricklade.
102 High Street
Cricklade SN6 6AA
☎ 01793 751044

Marlborough.
106 High Street
Marlborough SN8 1LT
☎ 01672 514380

Old Town.
28-30 Wood Street
Swindon SN1 4AB
☎ 01793 296880

Swindon.
The Village Centre,
Redhouse SN25 2FW
☎ 01793 296600

Agents Note: Whilst every care has been taken to prepare these sales particulars, they are for guidance purposes only. All measurements are approximate and are for general guidance purposes only and whilst every care has been taken to ensure their accuracy, they should not be relied upon and potential buyers are advised to recheck the measurements