



- MODERN THREE BEDROOM HOUSE
- SOUGHT AFTER LOCATION
- SUMMER HOUSE
- MODERN KITCHEN

35 Southfield Road, Worthing, BN14 9EH

Offers In Excess Of £350,000

W Welch Estate Agents are delighted to be able to offer for sale by private treaty a wonderfully well presented three bedroom mid terrace home. Located in the sought after and popular area of Broadwater with local shops, eateries, close proximity to the town centre with access to the A27 for transport links to Brighton and London. The property which has been modernised throughout features the following: Entrance hall leading to lovely spacious reception room with a bay window with seating, open plan dining area, leading to modern kitchen with door onto garden which has a wonderful summer house. Stairs leading to first floor with two double



Ground Floor

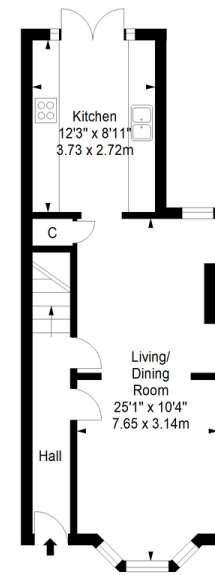

First Floor

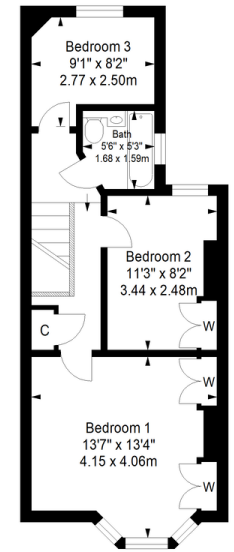

Approximate gross internal floor area 82.5 sq m/ 888.1 sq ft  
 Whilst every care has been taken to ensure accuracy, dimensions are approximate and for illustrative purposes only.  
 All rights reserved.

%epcGraph\_c\_1\_334%



3 Marston Road, Worthing, West  
 Sussex, BN14 8BD

[www.w-welchestateagents.co.uk](http://www.w-welchestateagents.co.uk)  
 01903 898000  
[sales@w-welchestateagents.co.uk](mailto:sales@w-welchestateagents.co.uk)

Agents Note: Whilst every care has been taken to prepare these particulars, they are for guidance purposes only. All measurements are approximate and for general guidance purposes only and whilst every care has been taken to ensure their accuracy, they should not be relied upon and potential buyers/tenants are advised to recheck the measurements