



FOR SALE

3 Bed Semi-Detached House in Henley Crescent, Braunstone Town
£200,000

*** No Chain *** Semi detached property with larger than average garden. The property requires modernisation throughout and would ideally suit someone who is handy at DIY or a property investor. The accommodation comprises porch, entrance hall, lounge, breakfast kitchen, outside w.c., three bedrooms, bathroom and front and rear gardens.



GROUND FLOOR
337 sq.ft. (31.3 sq.m.) approx.

1ST FLOOR
319 sq.ft. (29.6 sq.m.) approx.

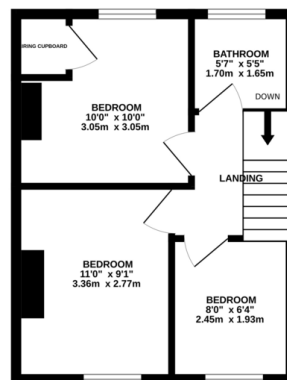
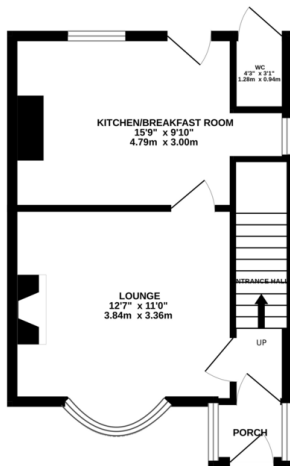

TOTAL FLOOR AREA: 655 sq.ft. (60.9 sq.m.) approx.
While every attempt has been made to ensure the accuracy of the floorplans contained herein, measurements of doors, windows, rooms and any other areas are approximate and no responsibility is taken for any error, omission or mis-statement. This plan is for illustrative purposes only and should be used as such by any prospective purchaser. The services, systems and appliances shown have not been tested and no guarantee as to their operability or efficiency can be given.
Made with Metreplan ©2024

EPC to follow

- No Chain
- Modernisation Required
- Semi Detached
- Large Garden
- Three Bedrooms
- Close To Amenities
- Good Access To Motorways
- Gas Central Heating

Agents Note: Whilst every care has been taken to prepare these sales particulars, they are for guidance purposes only. All measurements are approximate are for general guidance purposes only and whilst every care has been taken to ensure their accuracy, they should not be relied upon and potential buyers are advised to recheck the measurements.

