



MILE



## Beechworth, Willesden Lane, NW6

£550,000 Leasehold

Welcome to Beechworth, a beautifully maintained development at 179 Willesden Lane, NW6 7YZ. This charming flat offers a harmonious blend of comfort, convenience, and modern living. With its private underground parking and access to a tranquil communal garden, the property provides a peaceful retreat amidst the vibrant energy of North West London. Nestled in the heart of Willesden, the area is renowned for its rich cultural diversity and strong sense of community. Just moments away, you'll find an array of independent shops, cosy cafes, and acclaimed restaurants, making it an ideal location for those who value both local charm and city accessibility. The excellent transport links ensure that central London is never far, whether for work or leisure. Beechworth itself is steeped in history, with the building managed by the Beechworth Residents Association since its establishment in 1974. This long-standing commitment to maintaining the property speaks volumes about the quality of life here, offering residents a secure and well-cared-for environment. Perfectly suited for modern living, this flat combines thoughtful design with practical features. The underground parking provides convenience and security, while the communal garden offers a delightful space to relax or socialise. Whether you're seeking a new home or an investment opportunity, this property is a wonderful chance to experience the best of Willesden Lane.

- Ground floor apartment
- Two double bedrooms
- Underground parking
- 884 sq ft
- Secure block
- Long lease
- Excellent condition
- Communal garden
- Great location
- Close to shops and transport

# WILLESDEN LANE, NW6 7YZ

Approximate Gross Internal Area = 82.1 sq.m / 884 sq.ft

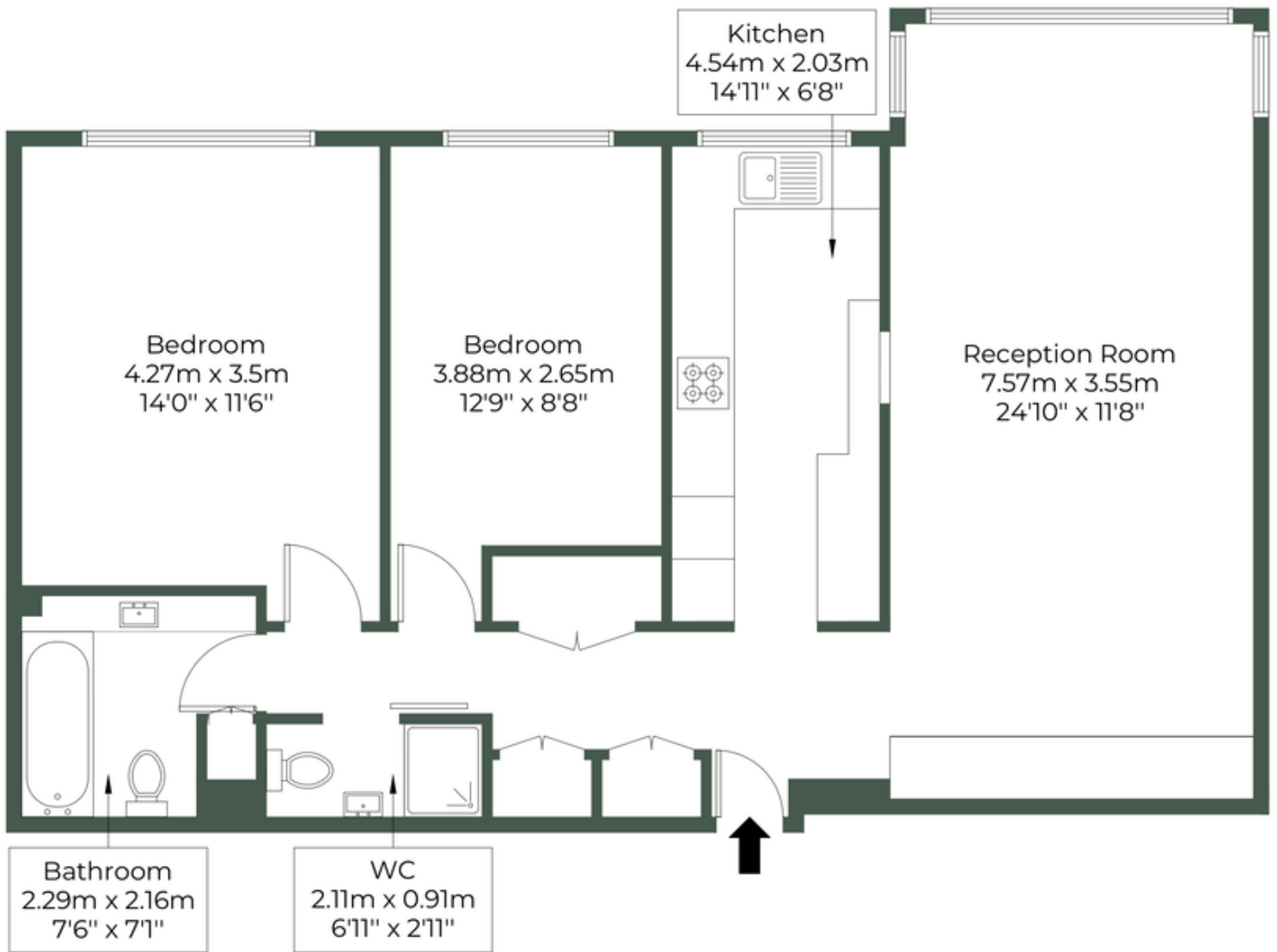
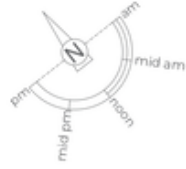

Ground Floor



**MONEY LAUNDERING REGULATIONS 2003:** Intending purchasers will be asked to produce identification documentation at a later stage and we would ask for your co-operation in order that there will be no delay in agreeing the sale.

**General:** While we endeavour to make our sales particulars fair, accurate and reliable, they are only a general guide to the property and, accordingly, if there is any point which is of particular importance to you, please contact the office and we will be pleased to check the position for you, especially if you are contemplating travelling some distance to view the property.

**Measurements:** These approximate room sizes are only intended as general guidance. You must verify the dimensions carefully before ordering carpets or any built-in furniture.

**Services:** Please note we have not tested the services or any of the equipment or appliances in this property, accordingly we strongly advise prospective buyers to commission their own survey or service reports before finalising their offer to purchase.