



23 Hovedene, Cromwell Road

Hove BN3 3EH

Asking Price Of £335,000

- STUNNING VIEWS
- MODERN APARTMENT
- DOUBLE BEDROOM
- BATHROOM
- KITCHEN
- LIVING ROOM
- PRIVATE BALCONY
- UNDERGROUND ALLOCATED PARKING SPACE

Whitlock and Heaps bring to market this wonderful 6th floor apartment being of a southerly aspect featuring a full width balcony offering extensive views over the cricket ground and of the sea. The accommodation is presented in good decorative order throughout and benefiting from an underground allocated parking space and share in the freehold. The one double bedroom accommodation includes a modern kitchen and bathroom with both the south facing living room and bedroom having access onto the balcony. Situated in this convenient location within walking distance of Hove mainline station and seafront. An array of eateries, cafes and shopping facilities are all within easy reach and bus services run close by offering access into the City Centre.

OUTSIDE Underground allocated Parking Space 42.

Brick built store.

OUTGOINGS

SHARE OF FREEHOLD

LEASE 1994 to 1st March 2152

ENTRANCE HALL Three fitted cupboards with one housing the 'Glow Worm' gas fired boiler.

KITCHEN UPVC double glazed window overlooking the cricket ground. Incorporating stainless steel sink unit with drainer and mixer tap, adjacent laminate worksurface with cupboards and drawers under, matching eye level wall cupboards, inset four ring gas hob with extractor over, electric oven, integrated fridge/freezer and washing machine, tiled splashback.

LIVING ROOM South facing, radiator, patio door to:

BALCONY Full width with space for table and chairs. Offering views over the cricket ground and towards the sea. You will also be able to benefit from the number of events the Cricket ground hosts.

BEDROOM Fitted wardrobes, radiator, sliding patio doors to balcony.

BATHROOM White suite comprising panelled bath with mixer tap and separate shower over, glazed shower screen, wash hand basin with cupboard under, low level w.c., heated ladder style towel rail, tiled walls and floor.

HOOVEDENE

HOVE

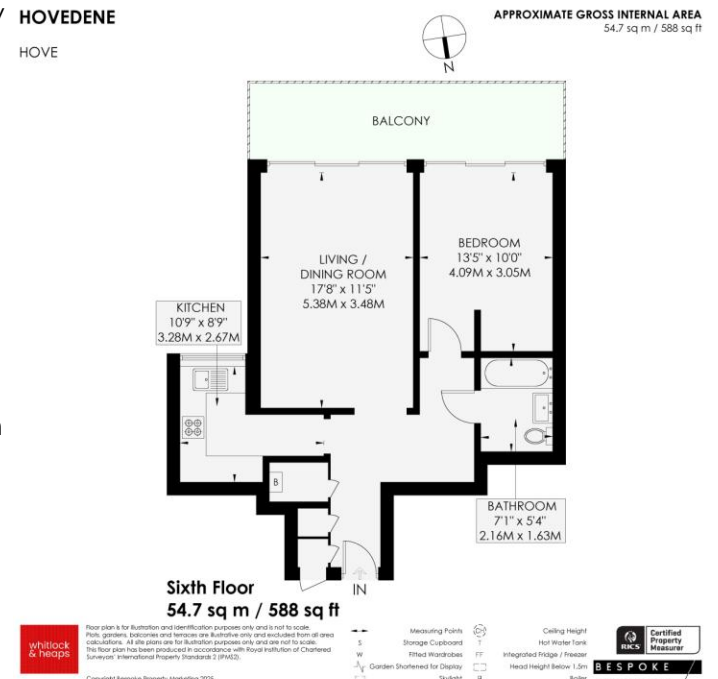

Portslade Branch

48 Boundary Road, Portslade BN3 4EF
portslade@whitlockandheaps.co.uk
01273 422706

Hove Branch

65 Sackville Road, Hove BN3 3WE
hove@whitlockandheaps.co.uk
01273 778577



Disclaimer: Whitlock & Heaps have produced these particulars in good faith and they are set out as a general guide. Accuracy is not guaranteed, nor do they form part of any contract. If there is any particular aspect of these details which you require any confirmation, please do contact us, especially if contemplating a long journey. All measurements are approximate. Fixtures and fittings, other than those mentioned above, to be agreed with the seller. Any services, systems or appliances at the property have not been tested.