



- POPULAR LOCATION
- TWO BEDROOMS
- AMPLE PARKING
- IN NEED OF MODERNISATION

7 Tollgate, Daws Heath, Essex, SS7 3UX

Guide Price £300,000

Fancy a project? Come take a look at this SEMI DETACHED TWO BEDROOM BUNGALOW in need of modernisation. Located in this popular location within easy access of the A127.



Property Description

ENTRANCE HALL

Double glazed entrance door with a stained glass lead light panel leads to the entrance hall. Georgian style obscure glazed window to the side. 15 light door leads to the:-

LOUNGE

Double glazed window to the front. Tiled fireplace. Double radiator. Two wall light points.

KITCHEN

Fitted with units at eye and base level with work surfaces over. Single drainer one and a half bowl single drainer sink unit with a mixer tap over. Cupboard housing the gas fired central heating boiler. Double glazed door and window to the side.

BEDROOM ONE

Double glazed window to the rear. Radiator.

BEDROOM TWO

Double glazed sliding patio doors lead to the rear garden. Radiator.

BATHROOM

With a 3 piece suite comprising low level wc wash hand basin and panelled bath with an electric shower over. Obscure double glazed window to the side. Radiator.

GARAGE

Approached via a long independent driveway. In need of substantial repair/removal.

REAR GARDEN





Laid to lawn with established shrubs. Paved patio. Outside water supply.

GENERAL

Tenure Freehold

Castle Point Borough Council

Council Tax Band C



Approx Gross Internal Area
58 sq m / 619 sq ft

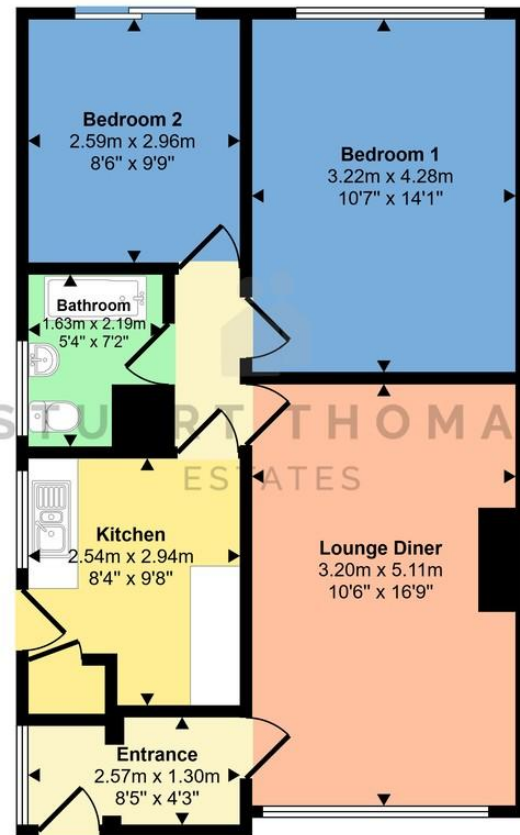

Floorplan

Score	Energy rating	Current	Potential
92+	A		
81-91	B		89 B
69-80	C		
55-68	D	66 D	
39-54	E		
21-38	F		
1-20	G		

This floorplan is only for illustrative purposes and is not to scale. Measurements of rooms, doors, windows, and any items are approximate and are not intended to be taken as a guarantee. For more information, please contact the agent.

294 Kiln Road, Benfleet, Essex,
SS7 1QT

stestates.co.uk
01702 558110
info@stestates.co.uk

Agents Note: Whilst every care has been taken to prepare these sales particulars, they are for guidance purposes only. All measurements are approximate and are for general guidance purposes only and whilst every care has been taken to ensure their accuracy, they should not be relied upon and potential buyers are advised to recheck the measurements.