



## Willesden Lane, London NW6

### £350,000 Leasehold

Welcome to Garfield Court – a beautifully presented one-bedroom apartment nestled within a secure and well-maintained block on the sought-after Willesden Lane. Offering 515 square feet of thoughtfully designed living space, this stylish home is in excellent condition throughout and perfectly suited for first-time buyers, downsizers, or investors alike. Step inside to discover a contemporary interior featuring bespoke Italian finishes, including custom-made kitchen and hallway wardrobes, and elegant Italian bathroom tiles. The kitchen is fitted with a sleek stone worktop and opens onto a wooden-floored hallway via a space-saving pocket door, enhancing both flow and functionality. The bathroom is equally impressive, complete with a bathtub and shower, underfloor heating, and a modern, high-quality finish. Additional features include double-glazed windows, access to a generous loft space providing excellent storage, and access to a peaceful communal garden. Residents also benefit from off-street parking and the convenience of a leasehold tenure. Located in a vibrant area with easy access to local amenities, transport links, and green spaces, this superb apartment at Garfield Court combines comfort, quality, and convenience in one of North West London's most desirable locations.

- Secure block
- Second floor apartment
- One bedroom
- Excellent condition
- Leasehold
- Communal garden
- Off Street Parking
- 515 square foot
- Great location
- Close to shops and transport

# Garfield Court, NW6

Approximate Gross Internal Area = 47.87 sq.m / 515 sq.ft

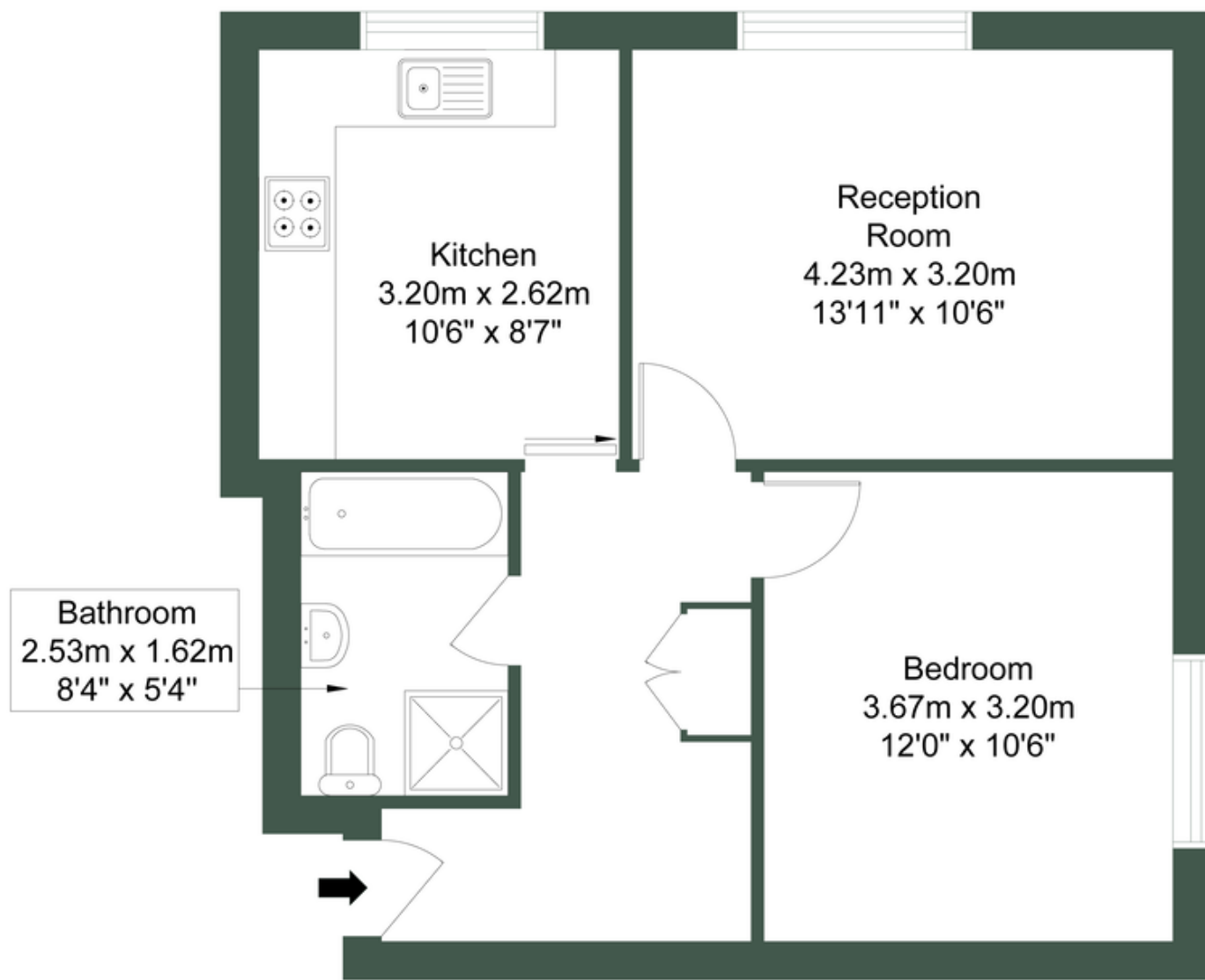
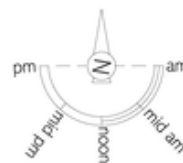

Second Floor



**MONEY LAUNDERING REGULATIONS 2003:** Intending purchasers will be asked to produce identification documentation at a later stage and we would ask for your co-operation in order that there will be no delay in agreeing the sale.

**General:** While we endeavour to make our sales particulars fair, accurate and reliable, they are only a general guide to the property and, accordingly, if there is any point which is of particular importance to you, please contact the office and we will be pleased to check the position for you, especially if you are contemplating travelling some distance to view the property.

**Measurements:** These approximate room sizes are only intended as general guidance. You must verify the dimensions carefully before ordering carpets or any built-in furniture.

**Services:** Please note we have not tested the services or any of the equipment or appliances in this property, accordingly we strongly advise prospective buyers to commission their own survey or service reports before finalising their offer to purchase.