



Hamilton Street, Atherton, Manchester **Offers Over £100,000**







Hamilton Street, Atherton,
Manchester

Offers Over £100,000

Property Description

This LARGE and SPACIOUS property close to Atherton Park will simply BLOW YOU AWAY. This is not your standard 2 bedroom house, not only is this home large and spacious, but it is stylish with lots of character throughout and has 2 reception rooms. This is a very rare opportunity to purchase a rare property and you really need to see it to believe it. The house benefits from a fantastic size, perfect for relaxing and putting your feet up. We aren't done yet as the kitchen is also stylish and modern, although the house has lots of character and plenty of storage. A copy of the EPC will be available on request. EPC Grade D.

Our View

You enter the property and the lounge is overlooking the front of the property. The dining room is behind the lounge and the kitchen is to the rear of the dining room. Upstairs the master bedroom is overlooking the front of the property with bedroom 2 and the bathroom overlooking the rear

Location

What a great location! Close to Atherton park and situated very close to Atherton High School. This great house is also within walking distance to Atherton town centre which benefits from plenty amenities and some great transport links.



EPC Grade D
For full EPC please contact the branch

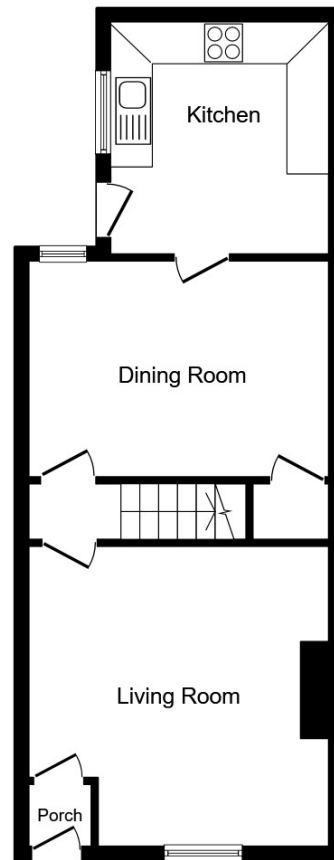

Ground Floor

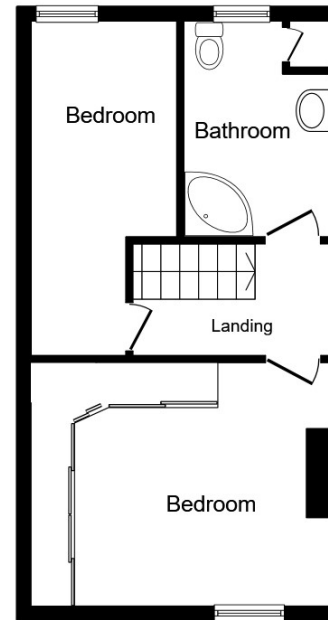

First Floor

This plan is for illustration purposes only and may not be representative of the property. Plan not to scale.

Powered by audioagent.com

IMPORTANT NOTE TO PURCHASERS: We endeavour to make our sales particulars accurate and reliable, however, they do not constitute or form part of an offer or any contract and none is to be relied upon as statements of representation or fact. The services, systems and appliances listed in this specification have not been tested by us and no guarantee as to their operating ability or efficiency is given. All measurements have been taken as guide to prospective buyers only, and are not precise. Floor plans where included are not to scale and accuracy is not guaranteed. If you require clarification or further information on any points, please contact us, especially if you are travelling some distance to view. Fixtures and fittings other than those mentioned are to be agreed with the seller.

Your Move is a trading name of your-move.co.uk, registered in England at Newcastle House, Albany Court, Newcastle Business Park, Newcastle upon Tyne NE4 7YB (number 01864469).

*Calls may be recorded and/or monitored for training and/or security purposes.

Tyldesley House, Unit 4 Elliott Street, Tyldesley,
Manchester, M29 8DS

01942 894500 * Astley@your-move.co.uk

