



## Becksidde Cottage, Rockcliffe, Carlisle

### Offers in the region of £155,000

#### Property Description

A spacious two bedroom semi-detached bungalow close to the village of Rockcliffe comprising of:- Entrance hall, lounge, dining room, kitchen fitted with a range of units, electric hob and integrated dishwasher. There are two bedrooms and shower room/WC. The property has oil central heating and double glazing, allocated parking to the rear and front forecourt garden area. EPC grade D.



## Our View

The property offers a semi-rural location and is within easy access to village Rockcliffe and Carlisle traffic routes.

## Location

Located at the end of this lane approximately half a mile from the village Rockcliffe having a primary schools, public house, easy access to Kingstown industrial estate to the North of Carlisle, Asda supermarket, M6 motorway and Western bypass.

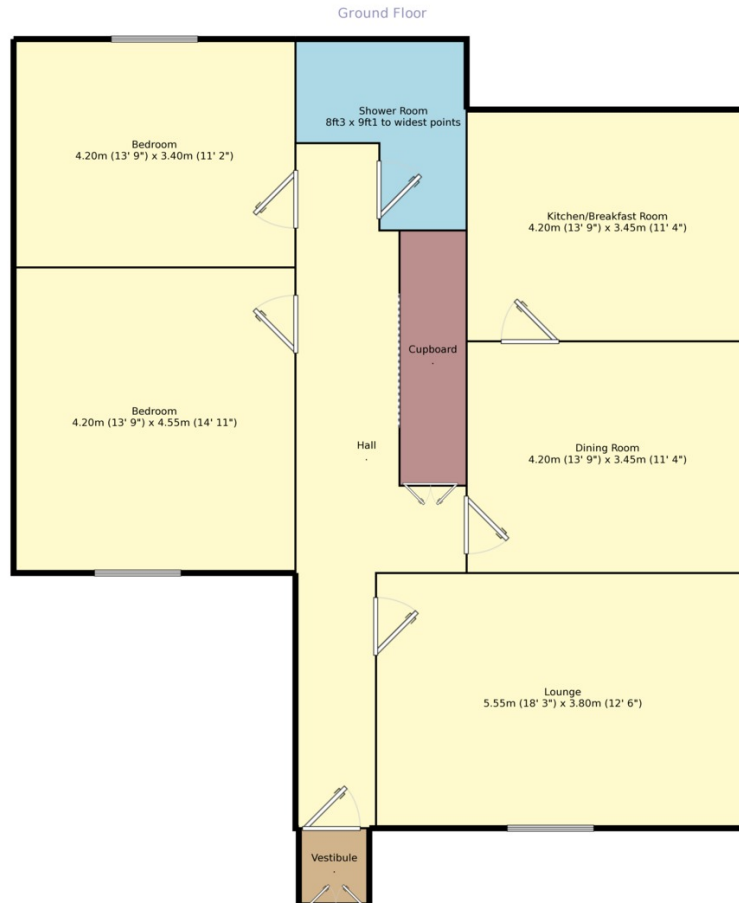

Measurements are approximate. Not to scale. For illustrative purposes only.



**EPC Grade D**

**For full EPC please contact the branch**

**IMPORTANT NOTE TO PURCHASERS:** We endeavour to make our sales particulars accurate and reliable, however, they do not constitute or form part of an offer or any contract and none is to be relied upon as statements of representation or fact. The services, systems and appliances listed in this specification have not been tested by us and no guarantee as to their operating ability or efficiency is given. All measurements have been taken as guide to prospective buyers only, and are not precise. Floor plans where included are not to scale and accuracy is not guaranteed. If you require clarification or further information on any points, please contact us, especially if you are travelling some distance to view. Fixtures and fittings other than those mentioned are to be agreed with the seller.

Your Move is a trading name of your-move.co.uk, registered in England at Newcastle House, Albany Court, Newcastle Business Park, Newcastle upon Tyne NE4 7YB (number 01864469).

\*Calls may be recorded and/or monitored for training and/or security purposes.

19 Fisher Street, Carlisle, CA3 8RF  
01228 537333 \* [carlisle@your-move.co.uk](mailto:carlisle@your-move.co.uk)

