



Frimley Road, Chessington, Surrey **Guide £265,000**





YOUR MOVE





Frimley Road,  
Chessington, Surrey

**Guide £265,000**

### Property Description

Perfect First Time Purchase! Being sold with no chain. This maisonette is set in a convenient location just a short stroll for the local shops and mainline station serving London Waterloo. The interior is a home makers dream and allows you free reign to make the property your own as updating is required, you also have options to change round the layout to a preference that may be more suitable to you. Internally all the rooms are of a good size there is a spacious lounge/diner and a generous 10ft 4 kitchen. The rear garden offers a degree of seclusion and with a little bit of imagination and some work could be transformed into a real gem where outdoor dining will truly be enjoyed. EPC Grade C.

### Our View

SELLERS VIEW! We are offering this property for sale with no upper chain and we have priced it realistically to generate a lot on interest. We appreciate the property requires updating as it has been in the family for over 45 years and would highly recommended a viewing if you are keen on DIY. Once inside we think you'll be surprised by the space on offer.

### Location

The local vicinity has good transport links for the local and major areas in South London and Surrey and access to the M25 and A3 providing links to a number of major routes into the City of London and London Airports.



**Two Bedroom Ground Floor Maisonette**  
For full EPC please contact the branch

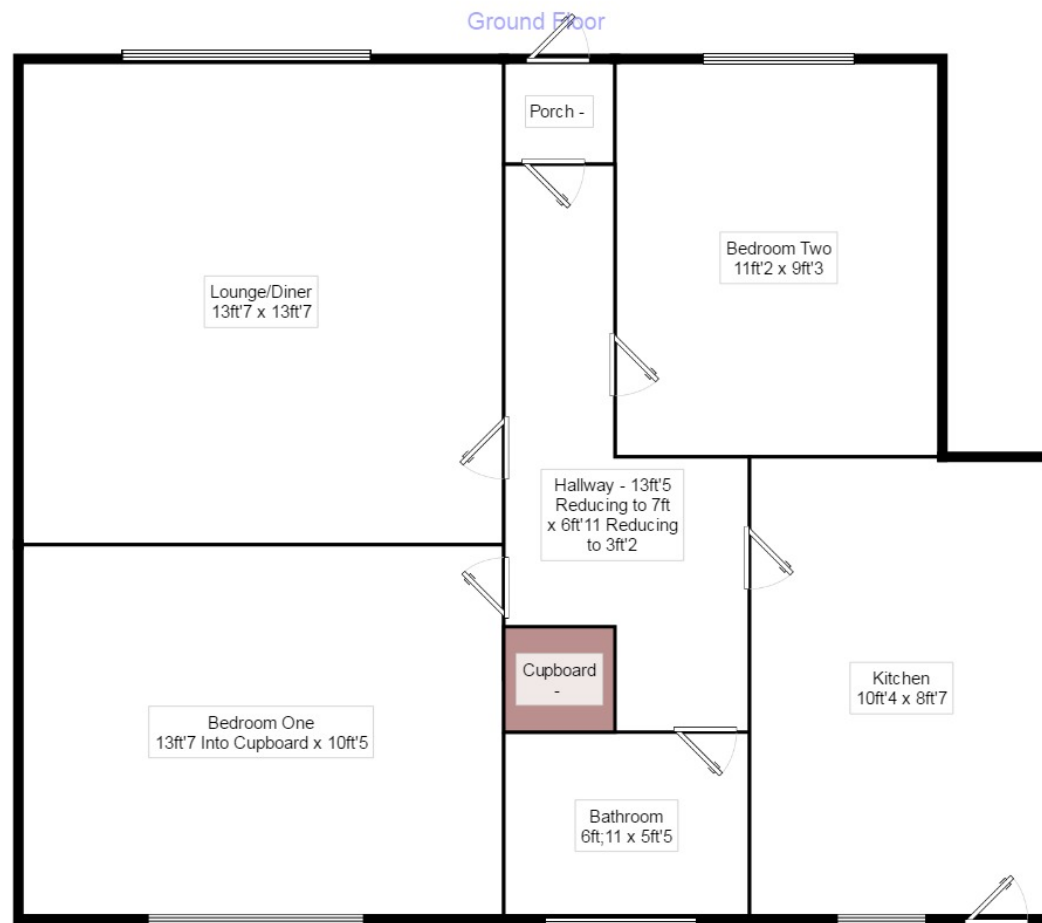

Measurements are approximate. Not to scale. For illustrative purposes only.

IMPORTANT NOTE TO PURCHASERS: We endeavour to make our sales particulars accurate and reliable, however, they do not constitute or form part of an offer or any contract and none is to be relied upon as statements of representation or fact. The services, systems and appliances listed in this specification have not been tested by us and no guarantee as to their operating ability or efficiency is given. All measurements have been taken as guide to prospective buyers only, and are not precise. Floor plans where included are not to scale and accuracy is not guaranteed. If you require clarification or further information on any points, please contact us, especially if you are travelling some distance to view. Fixtures and fittings other than those mentioned are to be agreed with the seller.

Your Move is a trading name of your-move.co.uk, registered in England at Newcastle House, Albany Court, Newcastle Business Park, Newcastle upon Tyne NE4 7YB (number 01864469).

3 Arcade Parade, Chessington, Surrey, KT9 1AB

020 8391 1689 \* Chessington@your-move.co.uk

\*Calls may be recorded and/or monitored for training and/or security purposes.

