

London Road
Tetbury



LOCKSTONES
ESTATE AGENTS

18 London Road Tetbury

Central Location ~ Period Cottage ~ Character Features
Lounge with Feature Fireplace ~ Two Bedrooms ~ Fully Enclosed Rear Garden
Log Burner ~ No Onward Chain ~ EPC Rating: D

18 London Road is a beautifully presented two double bedroom, natural stone-built cottage. The property has been lovingly renovated with the comprehensive works including: uncovering the fireplace and surround, new Upvc Windows in a hardwood style with shutters, new combination boiler with filter, refitted kitchen with Indian slate flooring. On the first floor, works included a new bathroom and exposing the vaulted ceiling in the master bedroom. Externally, the enclosed and private garden has been predominantly laid to lawn with block built storage shed and patio area. The outside cloakroom has also been fully renovated.



Entrance

Lounge

Upvc double glazed hardwood-style window to front with hardwood shutters. Fitted alcove storage cupboards with oak shelving over. Feature natural stone fireplace with inset 'Clearview' log burner and stone hearth. Wall light points. Antique oak flooring. Radiator. Latch door to:

Kitchen/Diner

Window to rear. Range of 'John Lewis from Hungerford' bespoke units with ceramic tiled worksurfaces. Fitted 'Rangemaster' oven with extractor over. Inset ceramic sink with mixer tap. Space for fridge. 'Valliant' combination boiler with water filter. In-built pantry. Indian slate tiled flooring. Spotlights and radiator. Latch door to first floor and door to:

Utility

Window and door to rear. Ceramic tiled worksurface with space and plumbing for washing machine and dishwasher under. Indian slate flooring. Spotlights and radiator.

First floor

Landing

Overstairs storage cupboard. Original floorboards. and latch doors to:

Master Bedroom

Upvc double glazed hardwood style window to front with shutters. Vaulted ceiling with exposed beams and pendant lighting. Original floorboards. Built in wardrobe. Radiator

Bedroom Two

Upvc double glazed hardwood style window to rear with shutters. Original floorboards. Radiator.

Bathroom

Upvc double glazed hardwood style window to rear with Upvc shutters. Travertine tiled walls and flooring. Cast iron bath with mixer tap and shower attachment. Rain head shower over and glass screen door. Extractor. Pedestal wash hand basin with mixer tap and w/c. Mirrored wall cupboard with lights over. Radiator

Externally

Fully enclosed garden with patio area and feature stone wall. Shallow steps lead to a lawned area with block built shed at the end. Recently renovated outside cloakroom with dual flush w/c and wash hand basin with mixer tap, tiled surround and Indian slate flooring.





Cairns Lecture Theatre →



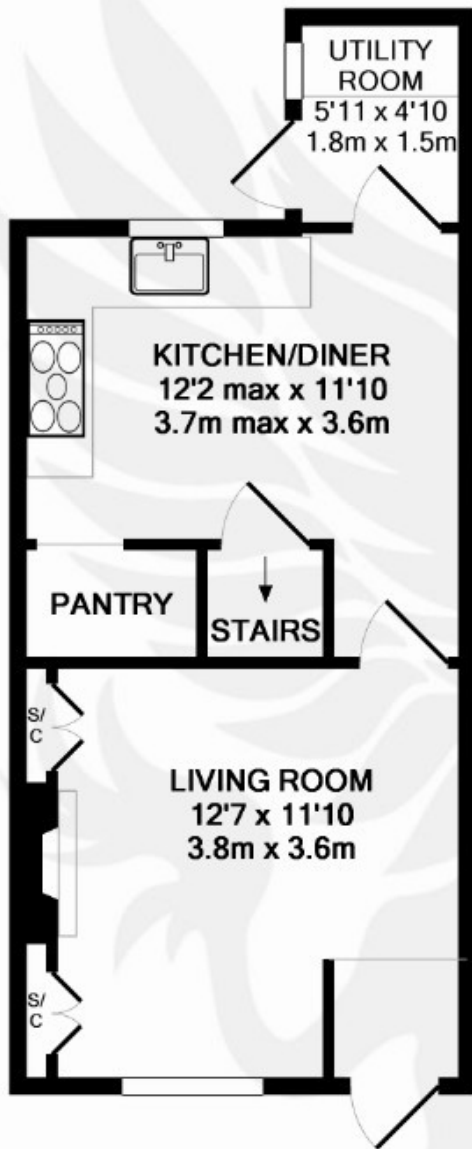

GROUND FLOOR
APPROX. FLOOR
AREA 330 SQ.FT.
(30.7 SQ.M.)

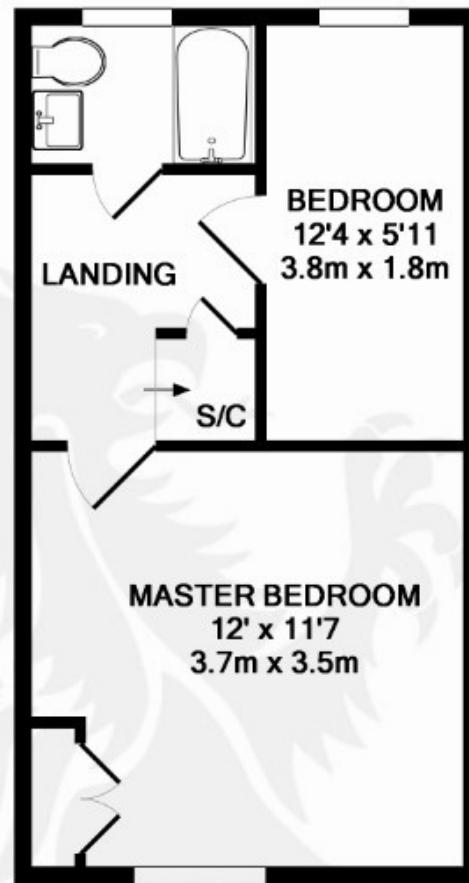

1ST FLOOR
APPROX. FLOOR
AREA 302 SQ.FT.
(28.0 SQ.M.)

TOTAL APPROX. FLOOR AREA 632 SQ.FT. (58.7 SQ.M.)

Whilst every attempt has been made to ensure the accuracy of the floor plan contained here, measurements of doors, windows, rooms and any other items are approximate and no responsibility is taken for any error, omission, or mis-statement. This plan is for illustrative purposes only and should be used as such by any prospective purchaser. The services, systems and appliances shown have not been tested and no guarantee as to their operability or efficiency can be given

Made with Metropix ©2014



LOCKSTONES
ESTATE AGENTS

52 High Street,
Malmesbury,
Wiltshire,
SN16 9AT

Tel: 01666 338633 Fax: 01666 338606

Email: malmesbury@lockstones.co.uk

Website: www.lockstones.co.uk

Disclaimer: Whilst every attempt has been made to ensure the accuracy of the details displayed here, measurements are approximate and no responsibility is taken for any error omission or miss-statement. These plans and details are for representation purposes only and should be used as by any prospective purchaser/tenant. The services, systems and appliances listed in this specification have not been tested and no guarantee as to their operating ability or their efficiency can be given.

