



Bryan Lodge, Moor Lane, Arkendale, HG5 0QU

£1,250,000



QUALITY TRUST VALUE



Description

A most attractive rustic brick detached family home, set in grounds of approximately 2.018 acres (0.817HA). This characterful home retains numerous original features, including exposed ceiling beams and period fireplaces. The property is now in need of general modernisation, allowing a purchaser to update the residence to their own requirements.

The accommodation in the main house briefly comprises: Central reception hall with cloakroom/WC, formal sitting room leading to a conservatory, which links to the extensive garden. There is a separate dining room and snug, a large breakfast kitchen, laundry and boot room. On the first floor are five bedrooms and two bathrooms.

An undoubted feature of this delightful home is the extensive garden space and paddock which extend to approximately 2.018 acres. In addition there is a detached former Chapel, which has been converted into a ground floor snooker room and first floor one bedroom self-contained apartment.

There is a three car open fronted carport with attached garden and coal stores and gardener's WC.





This wonderful family home could remain as such and be modernised to suit an individual's requirements. There is also the possibility of partial or significant re-development of the site, subject to obtaining the necessary planning approval.

Bryan Lodge is situated on Moor Lane in the popular village of Arkendale. The village is conveniently placed between Knaresborough and Boroughbridge for a wider range of amenities. The village itself supports a public house and a Village Hall. The location is seen as ideal for the commuter, as easy access can be gained to the A1(M) linking to the region's motorway network.

Tenure

Freehold.

Services

All mains services are connected to the property.

Council Tax

Band G.

Directions

Leaving Knaresborough on the Boroughbridge Road, proceed into the village of Ferrensby and turn right signposted to Arkendale. Proceed into the village passing the Bluebell Public house on your left hand side, take the next right and turn onto Moor Lane, where the property will be found on your right hand side.

Details Produced

11th October 2022.





House

Hill House

Bryan Lodge

2.018 acres
0.817 ha

4a

4

1

South View





GROUND FLOOR
1410 sq.ft. (131.0 sq.m.) approx.

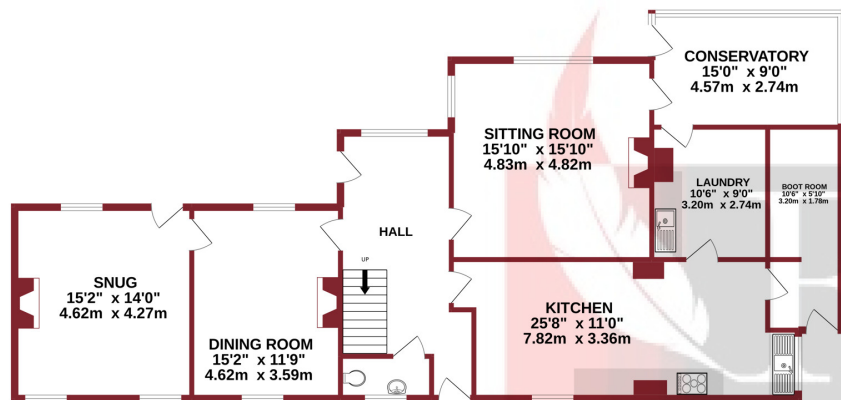

1ST FLOOR
940 sq.ft. (87.3 sq.m.) approx.

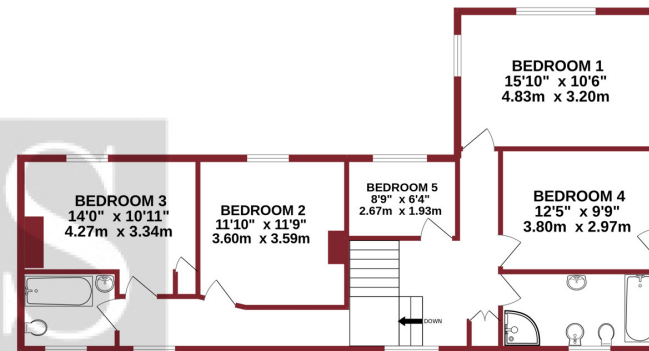

FEATHER SMAILES SCALES

TOTAL FLOOR AREA : 2349 sq.ft. (218.2 sq.m.) approx.

Made with Metropix ©20.

GROUND FLOOR
836 sq.ft. (77.7 sq.m.) approx.

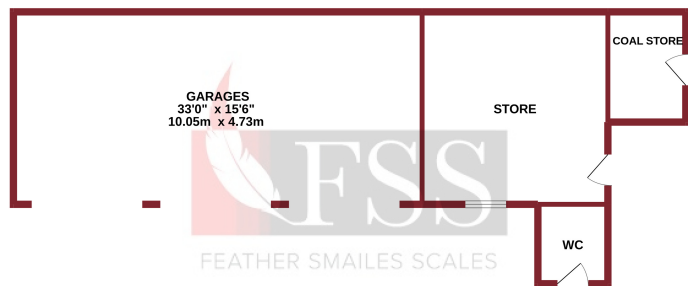

TOTAL FLOOR AREA : 836 sq.ft. (77.7 sq.m.) approx.

Made with Metropix ©2022

GROUND FLOOR
510 sq.ft. (47.4 sq.m.) approx.

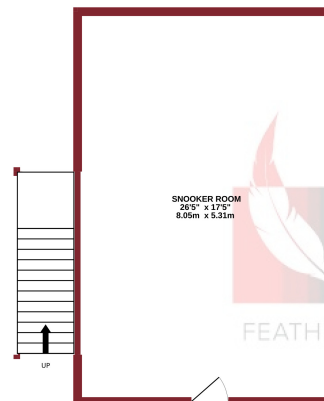

1ST FLOOR
534 sq.ft. (49.6 sq.m.) approx.

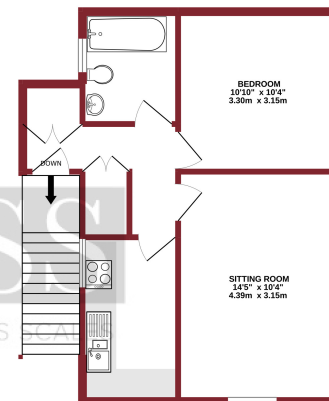

FSS trust potential buyers and sellers have obtained financial advice, or have funds in place, prior to entering into a property transaction. FSS, as agents acting on behalf of clients, will seek proof of funding to safeguard our clients interest. Should you require mortgage advice, we have a long standing relationship with an independent mortgage advisor who can provide information for you. Please ask a member of staff for more details. Over the course of the last financial year 2018-2019 referrals to this independent mortgage broker have, on average, earned us a fee of £339.96 per case.

IMPORTANT NOTICE: 1. Particulars: These particulars are not an offer of contract, nor part of one. You should not rely on statements by Feather Smiles Scales LLP in the particulars or by word of mouth or in writing ("information") as being factually accurate about the property, its condition or its value. Neither Feather Smiles Scales or any joint agent has any authority to make any representations about the property, and accordingly any information given is entirely without responsibility on the part of the agents, seller(s) or lessor(s). **2. Photos etc:** The measurements and distances given are approximate only and maps, plans and areas displayed are for illustration purposes only. Photographs show only certain parts of the property as they appeared at the time they were taken. **3. Regulations etc:** Any reference to alterations to, or use of, any part of the property does not mean that any necessary planning, building regulations or other consent has been obtained. A buyer or lessee must find out by inspection or in other ways that these matters have been properly dealt with and that all information is correct. **4. VAT:** The VAT position in relation to the property may change without notice. Viewing by appointment only. Feather Smiles & Scales is a limited liability partnership registered in England with registered number OC308783. Our registered office is 8 Raglan Street, Harrogate, North Yorkshire, HG1 1LE, where you may look at a list of members' names.

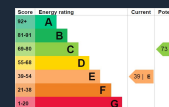

01423 501211
www.fssproperty.co.uk
sales@fssproperty.co.uk
8 Raglan Street, Harrogate,
North Yorkshire, HG1 1LE

