



MILE



Leghorn Road, Willesden Junction NW10

£3,950 pcm

SHORT LET - Mile are delighted to introduce to the market since splendid slit-level apartment set within this semi-detached Victorian conversion.

- Incredible split-level apartment
- Three double bedrooms
- Amazing 15ft south facing rood terrace
- Excellent condition
- Available now
- Offered furnished or unfurnished
- Contemporary 18ft reception / kitchen diner
- Two bathrooms (one en-suite) and a further WC
- Fantastic location
- Close to shops and transport

LEGHORN ROAD

Approximate Gross Internal Area 1027 sq ft / 95.4 sq m
(Excluding Eaves Storage)

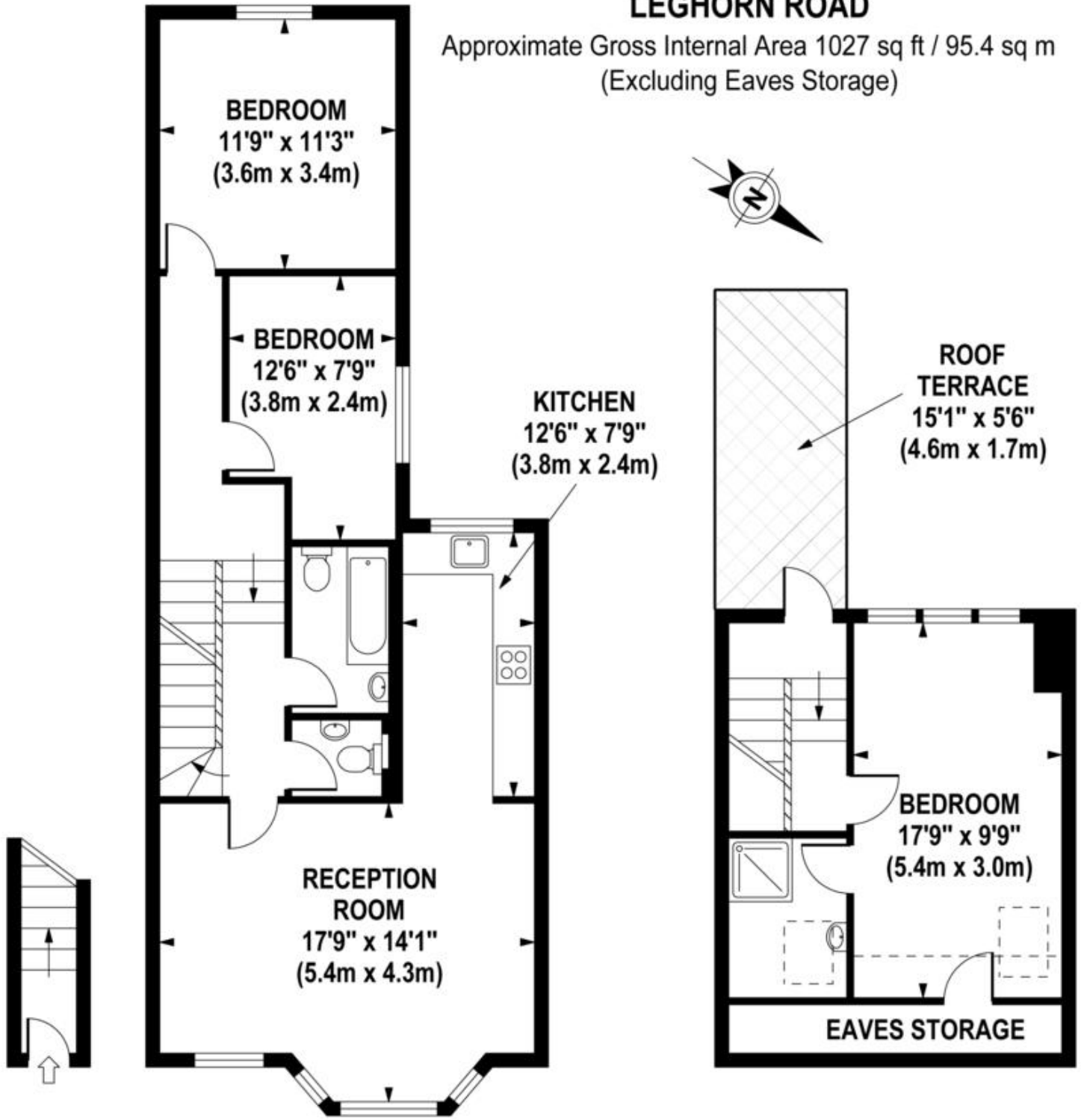

GROUND FLOOR
GROSS INTERNAL
FLOOR AREA 24 SQ FT

FIRST FLOOR
GROSS INTERNAL
FLOOR AREA 723 SQ FT

SECOND FLOOR
GROSS INTERNAL
FLOOR AREA 280 SQ FT

Although every attempt has been made to ensure accuracy, all measurements are approximate. The floor plan's for illustrative purposes only and not to scale. Measured in accordance to RICS standards.
GB PRO PHOTOS

MONEY LAUNDERING REGULATIONS 2003: Intending purchasers will be asked to produce identification documentation at a later stage and we would ask for your co-operation in order that there will be no delay in agreeing the sale.

General: While we endeavour to make our sales particulars fair, accurate and reliable, they are only a general guide to the property and, accordingly, if there is any point which is of particular importance to you, please contact the office and we will be pleased to check the position for you, especially if you are contemplating travelling some distance to view the property.

Measurements: These approximate room sizes are only intended as general guidance. You must verify the dimensions carefully before ordering carpets or any built-in furniture.

Services: Please note we have not tested the services or any of the equipment or appliances in this property, accordingly we strongly advise prospective buyers to commission their own survey or service reports before finalising their offer to purchase.