



71B Drayton Park, N5 1BF

Guide Price £625,000
Leasehold



71B Drayton Park

Guide Price £625,000

Leasehold

A stunning, two-bedroom apartment set across the third of a modern development, with 998sqft/92sqm of living space. Park. Offering plenty of light throughout, the space comprises; an entrance hallway inclusive of a built-in storage and utility room; an open-plan kitchen diner offering integrated appliances, leading to a dual aspect reception area with double doors opening out to the private Balcony; two double bedrooms, two bathrooms. Drayton Park is within walking distance to the beautiful Highbury Fields & approx. ten-minute walk from Stoke Newington's ever-popular Church Street, while Finsbury Park, Woodberry Wetlands & Highbury Fields are all close by. Excellent transport links are provided via Highbury & Islington and Arsenal stations & several local bus routes.

- Two Double Bedrooms
- Third Floor
- 998sqft/92sqm
- Epc Rating C
- Private Balcony
- close to Good Transport Links
- mins walk to Highbury Barn
-





Balcony also available, not measured during survey, and excluded from measurements.

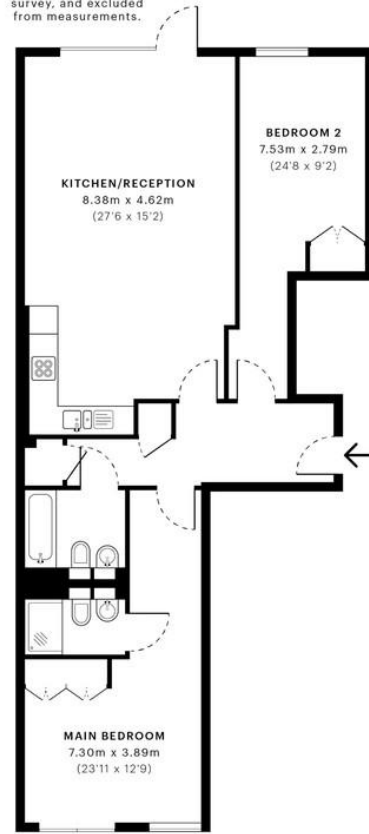

— Third Floor



spec Verified floor plans are produced in accordance with Royal Institution of Chartered Surveyors' Property Measurement Standards. Plans and gardens are illustrative only and excluded from all area calculations. Due to rounding, numbers may not add up precisely. All measurements shown for the individual room lengths and widths are the maximum points of measurement captured on the scan.

0000 00 00000000000000 00 00 sqm / 000000 sqft
0000 00 00000000000000 00 00 sqm / 000000 sqft

spec id: 56391dd665516150d5afaf8c



Agent's Note:

Whilst Care has been exercised in the preparation of these sales particulars, statements about the property must not be relied upon as representations of statements of fact. Prospective purchasers must make and rely upon their own enquiries and those of professional representatives. The company accept not liability for any error contained in these particulars.

Archway Office

671 Holloway Road
London, N19 5SE

T (0)20 7619 3750

Highbury Office

90 Highbury Park
London N5 2XE

T (0)20 7354 9111

Stroud Green Office

167 Stroud Green Road
London N4 3PZ

T (0)20 7281 2000

General Contact

E info@davidandrew.co.uk

W www.davidandrew.co.uk

