



19 North Street,
Boughton

£200,000

CURRANS
homes



Situated in a quiet backwater whilst being within walking distance of City centre this good sized and well presented two bedroomed terraced home which would make an ideal first time home.

The property which has been well improved in recent years and benefits from spacious accommodation with a double glazed entrance door which leads you to a good sized living room with an original cast iron feature fireplace, over 18ft extended dining/living/kitchen with space for additional seating, dining space with a range of built in white high gloss modern units with access to the walled rear courtyard.

To the first floor there are two bedrooms with fitted wardrobes to bedroom one and a main bathroom with a three piece white suite.

There is a boarded loft with a "Worcester" combination boiler and there is on road parking within the street.

FINER POINTS

- * Pleasant white rendered rear courtyard
- * Warmed via a "Worcester" combination boiler
- * UPVC double glazed doors and windows





* Quiet backwater position

* Walking distance to a range of shops, public houses & tap rooms

These particulars are intended to give a fair and substantially correct overall description for the guidance of intending purchasers and do not constitute an offer or part of a contract. Prospective purchasers ought to seek their own professional advice. All descriptions, dimensions, areas, reference to condition and necessary permissions for use and occupation and other details are given in good faith and are believed to be correct, but any intending purchasers should not rely on them as statements or representations of fact, but must satisfy themselves by inspection or otherwise as to the correctness of each of them. All measurements are approximate.

Tenure: Freehold

Local Authority: Cheshire West and Chester Council

Council Tax: Band B

Viewings: By appointment only



Ground Floor
Approximate Floor Area
396 sq. ft.
(36.8 sq. m.)

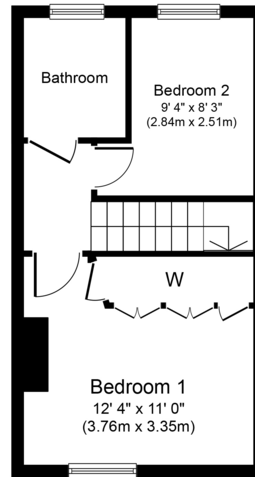

First Floor
Approximate Floor Area
286 sq. ft.
(26.6 sq. m.)

Whilst every attempt has been made to ensure the accuracy of the floor plan contained here, measurements of doors, windows, rooms and any other items are approximate and no responsibility is taken for any error, omission, or mis-statement. The measurements should not be relied upon for valuation, transaction and/or funding purposes. This plan is for illustrative purposes only and should be used as such by any prospective purchaser or tenant. The services, systems and appliances shown have not been tested and no guarantee as to their operability or efficiency can be given.

Copyright V360 Ltd 2024 | www.houseviz.com

Office Address

11 Grosvenor Street
Chester, Cheshire
CH1 2DD

01244 313900

sales@curranshomes.co.uk

CURRANS
homes