



Seymours



Parkhill Road Camberley, GU17 0NB £450,000

Arrange a viewing: 01276 534100

Property Details

- 4 bedrooms
- 1 baths
- EPC Rating TBC
- 1315 sqft
- Blackwater Station (0.2 miles)

- NO ONWARD CHAIN
- Four double bedrooms
- Spacious living room
- Kitchen
- Bathroom and shower room
- Driveway parking for several cars
- Mature rear garden
- Detached garage
- Convenient location

NO ONWARD CHAIN. A deceptively spacious four bedroom chalet that is located in this very popular road in Blackwater within a short walk of the local shops and amenities as well as the railway station. The property is ready for the incoming purchaser to put their own stamp on and modernise to their own taste. It also benefits from a spacious living room and a kitchen as well as a bathroom and a shower room. There is driveway parking to the front for several cars as well as a mature rear garden to the rear with a detached garage to the side.

[01276 534100](tel:01276534100) / james@seymours-blackwater.co.uk

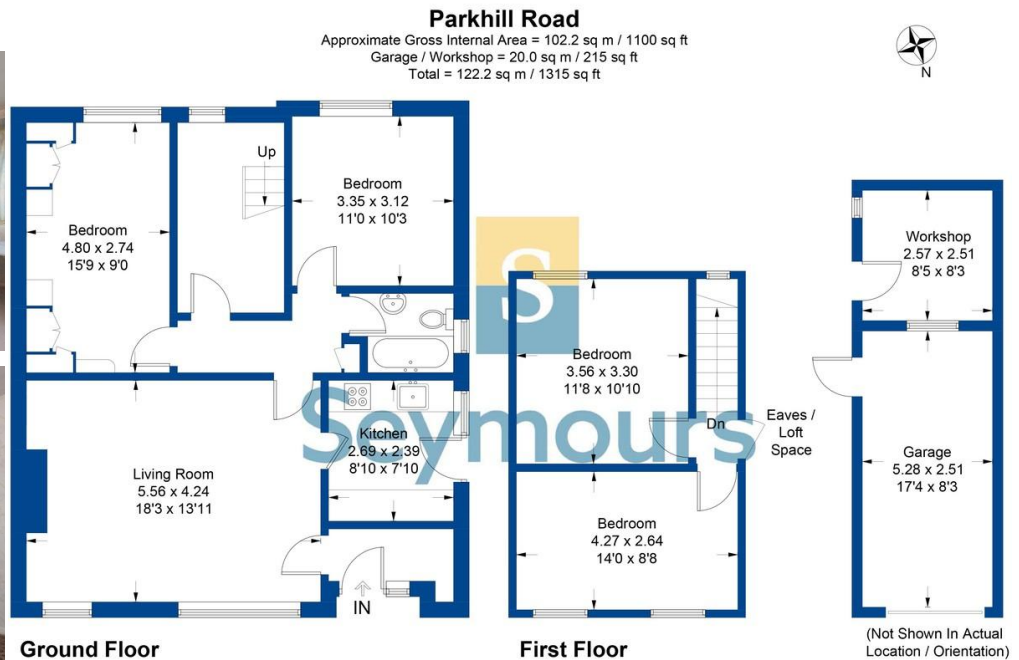

Illustration for identification purposes only, measurements are approximate, not to scale. Fourlabs.co © (ID1130661)