

Orbis Wharf
London, SW11 3GW

PROPERTY SUMMARY

Shared Ownership (50%)

A spacious fifth-floor one-bedroom apartment in a sought-after riverside development. Offering over 540 sq ft, it features a large double bedroom, modern bathroom, and a bright reception area with an open-plan kitchen. Benefits include a private balcony and secure allocated parking.

1 

1 

1 





LOCAL AUTHORITY

Wandsworth Borough Council

TENURE

Leasehold

COUNCIL TAX BAND

Band D

VIEWINGS

By prior appointment only

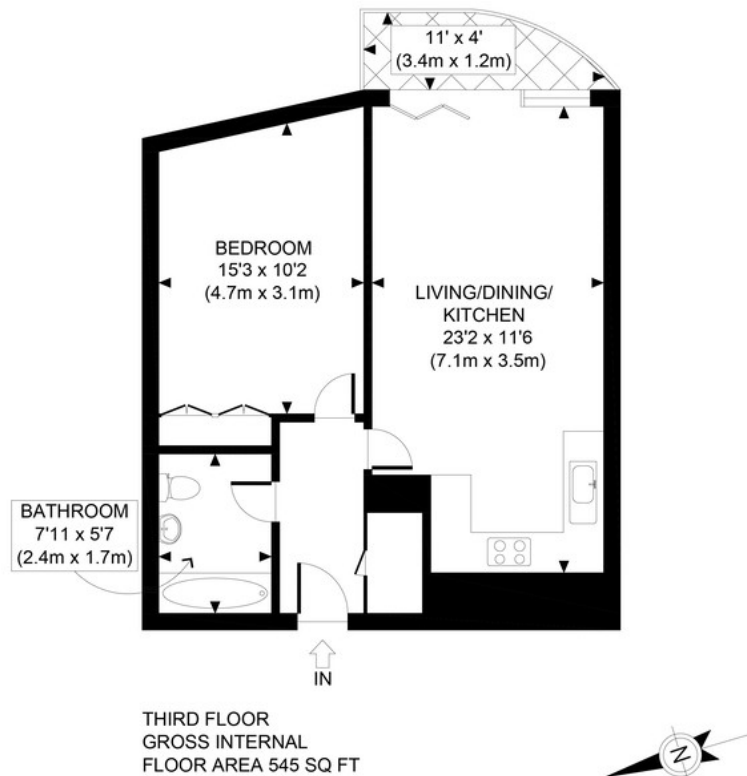

Agents Note: Whilst every care has been taken to prepare these particulars, they are for guidance purposes only. All measurements are approximate and are for general guidance purposes only and whilst every care has been taken to ensure their accuracy, they should not be relied upon and potential buyers/tenants are advised to recheck the measurements



4 Vicentia Court
Bridges Wharf
London
SW11 3GY

02073522455
info@hgproperty.co.uk
www.hgproperty.co.uk