



MILE



Airco Close, London NW9

£1,850 pcm %tenure%

Mile... are delighted to offer this spacious two bed ,one bath property to let on Airco Close, Colindale. The property benefits from two double bedrooms, large reception room and a separate kitchen. As well as this the property has off road parking available for one car and is conveniently located a stones throw from local shops as well as being walking distance to Colindale station.

Available Now
EPC Rating c

- Spacious
- Two double bedrooms
- Separate kitchen
- Large Reception
- Parking
- Close to local amenities
- Great Transport links
- **MUST BE SEEN TO AVOID DISSAPPOINTMENT!**
- Available Now
- EPC Rating C

AIRCO CLOSE, NW9 ONW

Approximate Gross Internal Area = 66.3 sq.m / 714 sq.ft

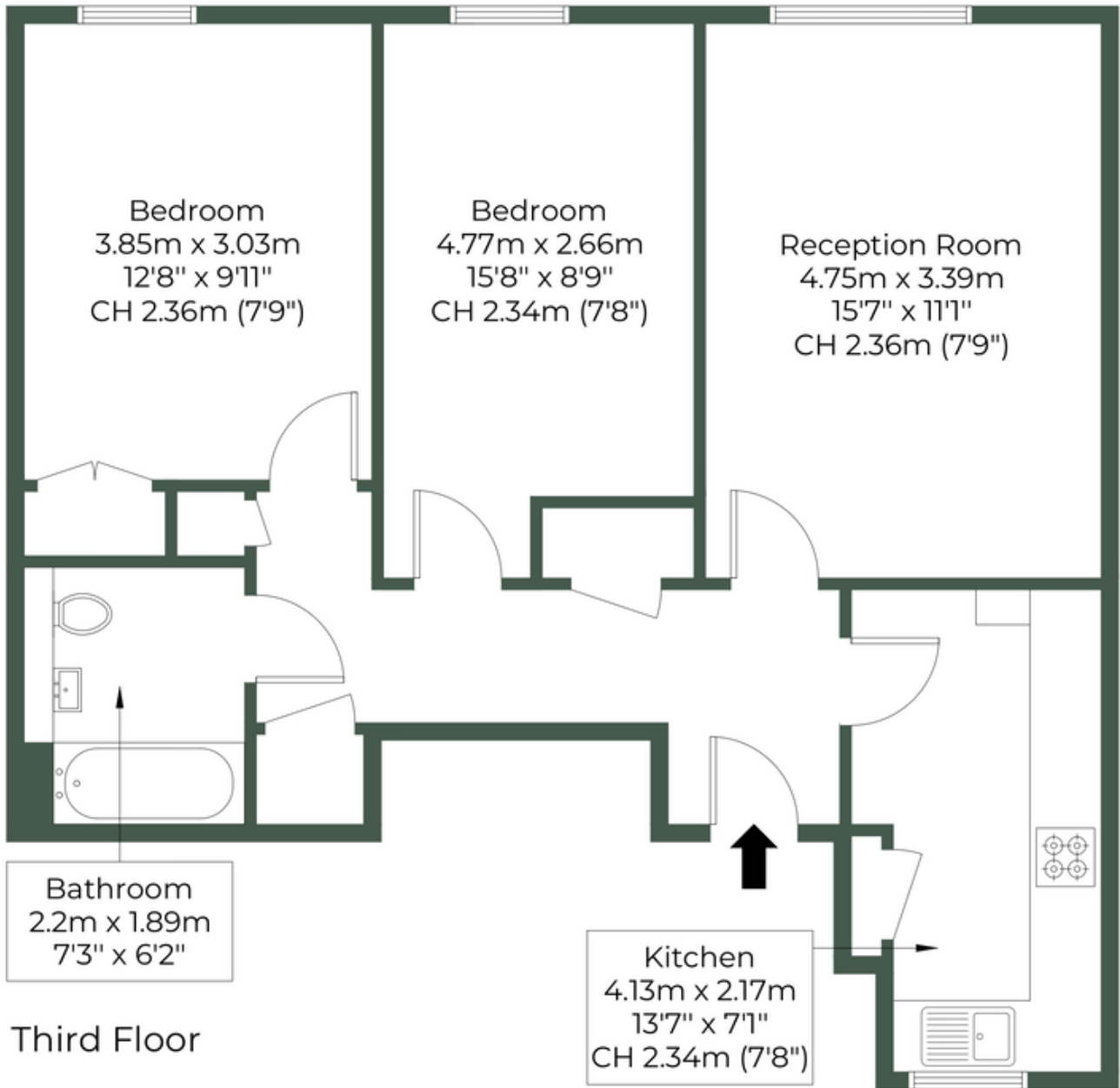
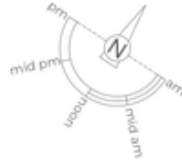

MONEY LAUNDERING REGULATIONS 2003: Intending purchasers will be asked to produce identification documentation at a later stage and we would ask for your co-operation in order that there will be no delay in agreeing the sale.

General: While we endeavour to make our sales particulars fair, accurate and reliable, they are only a general guide to the property and, accordingly, if there is any point which is of particular importance to you, please contact the office and we will be pleased to check the position for you, especially if you are contemplating travelling some distance to view the property.

Measurements: These approximate room sizes are only intended as general guidance. You must verify the dimensions carefully before ordering carpets or any built-in furniture.

Services: Please note we have not tested the services or any of the equipment or appliances in this property, accordingly we strongly advise prospective buyers to commission their own survey or service reports before finalising their offer to purchase.