



## 11 Perigee

Shinfield, Reading, RG2 9FT

- En-Suite double room
- Modern three storey shared house
- All bills included + Wi-Fi
- Fully furnished

**£625 pcm**

EPC Rating '78'



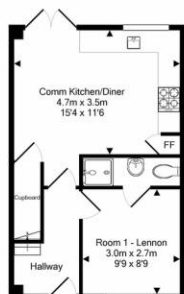

Ground Floor  
Approx. Floor  
Area 34.2 Sq.M.  
(369 Sq Ft.)

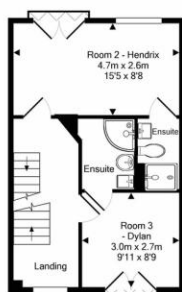

1st Floor  
Approx. Floor  
Area 34.0 Sq.M.  
(365 Sq Ft.)

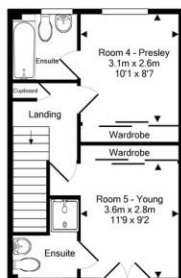

2nd Floor  
Approx. Floor  
Area 34.3 Sq.M.  
(369 Sq Ft.)

Total Approx. Floor Area 102.6 Sq.M. (1104 Sq Ft.)  
Measurements are approximate. Not to scale. Illustrative purposes only.  
Made with Metropix 62019



**Zoopla**  
Smarter property search

**PrimeLocation**  
Find the home you deserve

**SPAREROOM.co.uk**

**PRS** Property Redress Scheme

**mydeposits.co.uk**

**CMP**  
Client Money Protect

Overdene House  
49 Church Street  
Theale  
Reading  
Berkshire

[www.pillar.properties](http://www.pillar.properties)  
[hello@pillar.properties](mailto:hello@pillar.properties)  
07468529075

Agents Note: Whilst every care has been taken to prepare these sales particulars, they are for guidance purposes only. All measurements are approximate are for general guidance purposes only and whilst every care has been taken to ensure their accuracy, they should not be relied upon and potential buyers are advised to recheck the measurements