



Ladycroft Road, Armthorpe, Doncaster, South Yorkshire Offers in the region of





YOUR MOVE





Ladycroft Road,
Armthorpe, Doncaster,
South Yorkshire

**Offers in the region of
£145,000**

Property Description

If you are looking for a property that has been fully modernised throughout with a stunning open aspect view to the rear? then look no further. This property has been fully modernised since the current owners have owned it and briefly comprises internally a stunning fitted kitchen with top of the range kitchen integral appliances along with a family area. Also within the property are two double bedrooms both benefitting from built in wardrobes, a family shower room along with a stunning sun lounge to the rear giving beautiful views of the rear garden and the countryside. Viewing is a must to appreciate the standard of living on offer. A copy of the EPC will be available on request. EPC grade D

Our View

Being popular located and offering stunning spacious modern living throughout this bungalow will not be around for long, book your viewing early to avoid disappointment.

Location



EPC Awaited
For full EPC please contact the branch

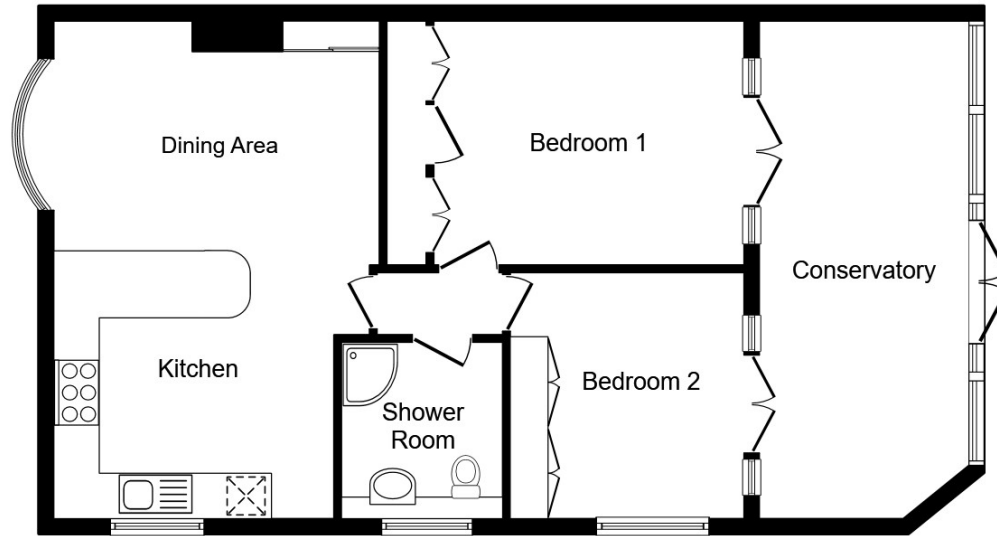

Floor Plan

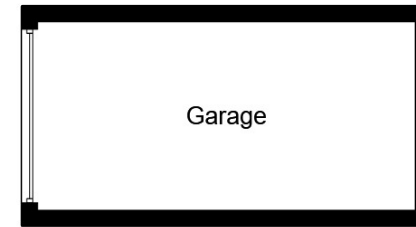

Garage

This plan is for illustration purposes only and may not be representative of the property. Plan not to scale.

Powered by audioagent.com

IMPORTANT NOTE TO PURCHASERS: We endeavour to make our sales particulars accurate and reliable, however, they do not constitute or form part of an offer or any contract and none is to be relied upon as statements of representation or fact. The services, systems and appliances listed in this specification have not been tested by us and no guarantee as to their operating ability or efficiency is given. All measurements have been taken as guide to prospective buyers only, and are not precise. Floor plans where included are not to scale and accuracy is not guaranteed. If you require clarification or further information on any points, please contact us, especially if you are travelling some distance to view. Fixtures and fittings other than those mentioned are to be agreed with the seller.

Your Move is a trading name of your-move.co.uk, registered in England at Newcastle House, Albany Court, Newcastle Business Park, Newcastle upon Tyne NE4 7YB (number 01864469).

*Calls may be recorded and/or monitored for training and/or security purposes.

Estate House, 56 Hall Gate, Doncaster, South
Yorkshire, DN1 3NE

01302 340444 * Doncaster@your-move.co.uk

