



The Nettlefolds, Hadley, Telford, Shropshire **Offers Over £80,000**







The Nettlefolds, Hadley, Telford, Shropshire

Offers Over £80,000

Property Description

****A TOP FLOOR APARTMENT WITH ELEVATED VIEWS**** Occupying a prestigious top floor position this two bedroom apartment offers an open plan lounge/kitchen with a front facing Juliet balcony, two double bedrooms and a modern bathroom. Externally the apartment offers one allocated parking space and access to the communal childrens play area. EPC grade C.

Our View

A rare opportunity to purchase a top floor apartment in this sought after development, this has been well kept by the current owner and I would recommend an early viewing.

Location

Situated in Hadley which benefits from local amenities including shops, primary and secondary schools, road and bus routes to Wellington and Telford town centres with their range of shops, supermarkets, library, leisure centre, bus and railway stations, primary, secondary and college educational facilities as well as road links to the M54 motorway and the Princess Royal hospital.



EPC Grade C

For full EPC please contact the branch

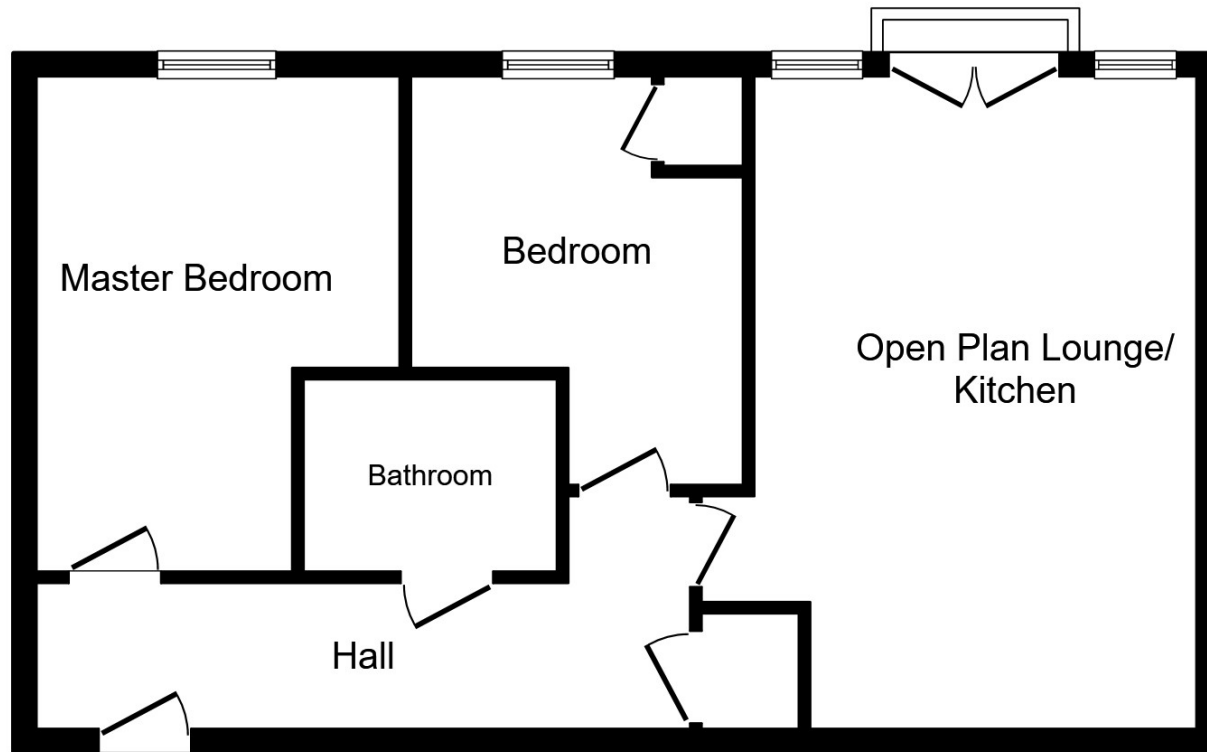

Floor Plan

This plan is for illustration purposes only and may not be representative of the property. Plan not to scale.

Powered by audioagent.com

IMPORTANT NOTE TO PURCHASERS: We endeavour to make our sales particulars accurate and reliable, however, they do not constitute or form part of an offer or any contract and none is to be relied upon as statements of representation or fact. The services, systems and appliances listed in this specification have not been tested by us and no guarantee as to their operating ability or efficiency is given. All measurements have been taken as guide to prospective buyers only, and are not precise. Floor plans where included are not to scale and accuracy is not guaranteed. If you require clarification or further information on any points, please contact us, especially if you are travelling some distance to view. Fixtures and fittings other than those mentioned are to be agreed with the seller.

Your Move is a trading name of your-move.co.uk, registered in England at Newcastle House, Albany Court, Newcastle Business Park, Newcastle upon Tyne NE4 7YB (number 01864469).

*Calls may be recorded and/or monitored for training and/or security purposes.

Market Street, Wellington, Telford, Shropshire,
TF1 1DT

01952 641242 * Wellington@your-move.co.uk

