

54/56 Barking Road
East Ham, London E6 3BP
Telephone: (020) 8472 4422
Property Management: (020) 8471 4224
Fax: (020) 8471 5052
E-mail: eastham@mcdowalls.com
Website: www.mcdowalls.com

43 Old Bethnal Green Road, Bethnal Green, E2 6PR



Offers in excess of £900,000

43 Old Bethnal Green Road, Bethnal Green, E2 6PR

A freehold commercial unit located a stones throw from Bethnal Green Underground Station. EPC - F

This property is a three storey detached commercial building with internal access to the basement in the highly desired location of Bethnal Green. Property holds an A1 licence for the commercial unit.

Proposed plans to extend and convert.

Offered with vacant possession.

Important Note

1. These particulars are prepared for guidance purposes only. They are intended to give a fair description of the property, but do not constitute part of an offer or contract.
2. We have been unable to verify certain information in particular none of the services or fixtures and fittings including central heating (where applicable). Electrical wiring appliances have not been tested and no warranties of any kind can be given.
3. The photograph appearing on particulars shows a certain aspect of the property at the time when the photograph was taken and it should not be assumed that the property has not changed since the photograph was taken.
4. All floorplan measurements are approximate and for illustration purposes only.
5. No enquiries have been made to the local authority with regards to planning consent, applications or notices.

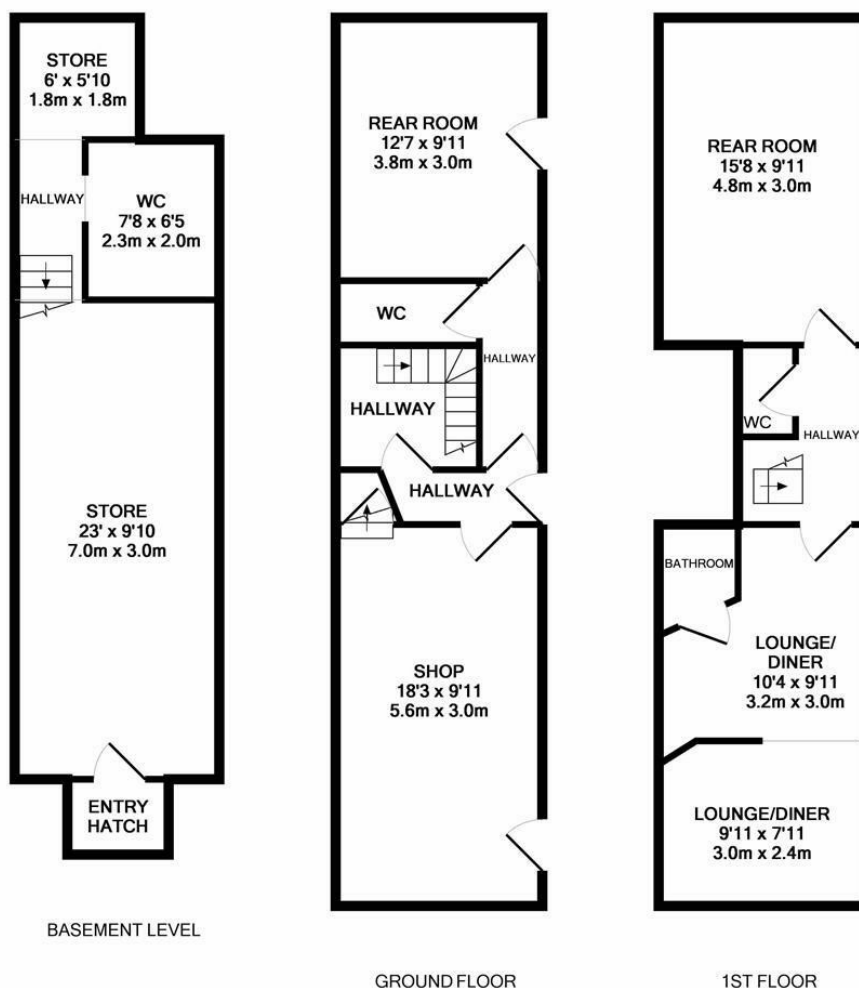



54/56 Barking Road
 East Ham, London E6 3BP
 Telephone: (020) 8472 4422
 Property Management: (020) 8471 4224
 Fax: (020) 8471 5052
 E-mail: eastham@mcdowalls.com
 Website: www.mcdowalls.com

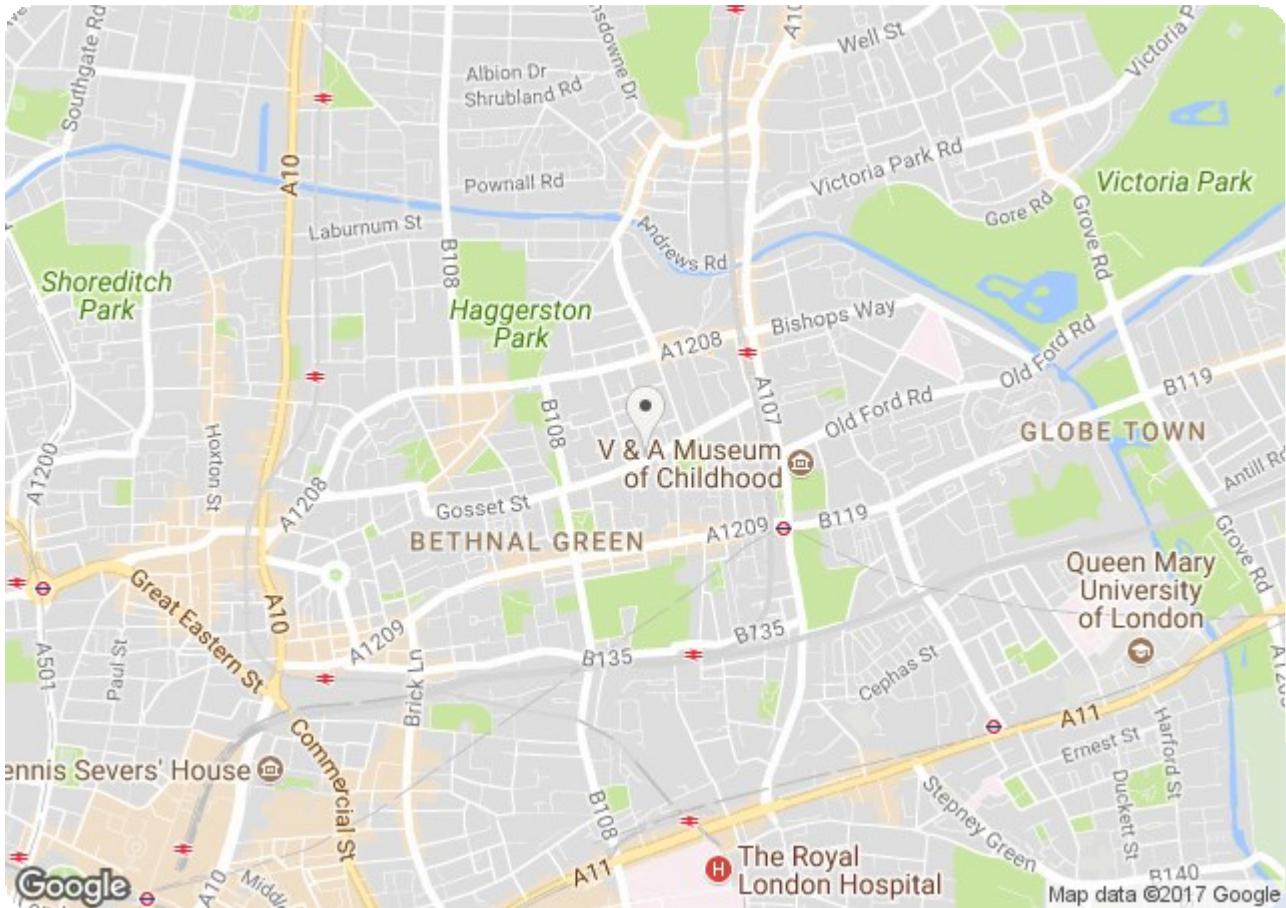

Energy Efficiency Rating		
	Current	Potential
Very energy efficient - lower running costs		
(92 plus) A		
(81-91) B		
(69-80) C		
(55-68) D		
(39-54) E		
(21-38) F		
(1-20) G		
Not energy efficient - higher running costs		
England & Wales	EU Directive 2002/91/EC	

Environmental Impact (CO ₂) Rating		
	Current	Potential
Very environmentally friendly - lower CO ₂ emissions		
(92 plus) A		
(81-91) B		
(69-80) C		
(55-68) D		
(39-54) E		
(21-38) F		
(1-20) G		
Not environmentally friendly - higher CO ₂ emissions		
England & Wales	EU Directive 2002/91/EC	

