



BRIARWOOD
BERRY HILL ROAD, ADDERBURY



BRIARWOOD

BBERRY HILL ROAD, ADDERBURY, BANBURY, OXFORDSHIRE OX17 3HF

A Deceptively Spacious Three Bedroom Detached Bungalow set in just under a Third of an Acre backing onto Open Fields and a Southerly Aspect. The Property offers scope to Extend to the First Floor.

ACCOMMODATION

- Spacious Entrance Hall
- Sitting Room
- Dining/Family Area
- Kitchen/Dining/Family Room
- Utility Room
- Family Bathroom
- Wet Room
- Own Driveway
- Detached Garage
- South Facing Rear Garden
- Set in just under a Third of an Acre backing onto Open Fields
- Gas Central Heating
- Double Glazed Windows

Mark David

Market House, Market Place, Deddington, Oxfordshire, OX15 0SB
Tel: 01869 338898
Email: deddington@mark-david.co.uk

Branches also at: Banbury, Chipping Norton & London

www.mark-david.co.uk



London Branch
The Mayfair Office
Cashel House, 15 Thayer Street
London, W1U 3JT
Tel: 0207 467 5330

www.mayfairoffice.co.uk

Briarwood is an individual and deceptively spacious detached residence set in gardens of just under a third of an acre backing onto open fields and enjoying panoramic views.

The property has been tastefully and sympathetically improved and modernised to provide excellent accommodation.

There is a spacious Entrance Hall with a beautiful herring bone floor that continues through the majority of the property and is an enchanting feature. Furthermore the light and spacious Kitchen/Dining Room has been superbly fitted to incorporate a variety of appliances provides an excellent space to entertain.

Equally the Wet Room and Family Bathroom enjoy underfloor heating.

The property benefits from gas central heating and double glazed windows.

The roof space provides an excellent space that could be further developed subject to planning permission being granted.

Outside there is a driveway and garage providing parking for several vehicles. The rear garden has been beautifully maintained and enjoys views over open fields and is south facing.



SITUATION & AMENITIES

The picturesque village of Adderbury offers many amenities including a Hotel and three Public Houses offering good food, Hair Dressers, Library, Golf Club, Recreation Ground and the Church of St Mary. The village has a good community spirit and offers many clubs ranging from babies and toddlers groups, to Brownies, Scouts, Photography, Gardening, WI, Bowls, Cricket, Tennis and Squash.

Also within the village there is the Christopher Rawlins Church of England primary school. Secondary education can be found at Bloxham – the Warriner School or Bloxham School which is an independent co-educational school catering for boarders and day pupils. Alternatively, secondary education can be found at Banbury - Blessed George Napier School or North Oxfordshire Academy.

Further comprehensive facilities can be found in both Banbury and Oxford whilst access to the M40 motorway can be gained at Junctions 10 or 11. Mainline stations are also available from both Banbury and Bicester.

Deddington c. 3 miles

Banbury c. 4 miles

Chipping Norton c. 13 miles

Oxford c. 21 miles

Birmingham c. 55 miles

London c. 74 miles

M40 Access c. 5 Miles

London via Bicester North or Banbury c. 1 hour

LOCAL AUTHORITY

Cherwell District Council

Council Tax Band: E

VIEWING

By Appointment Only





Briarwood, Berry Hill Road, Adderbury, OX17 3HF

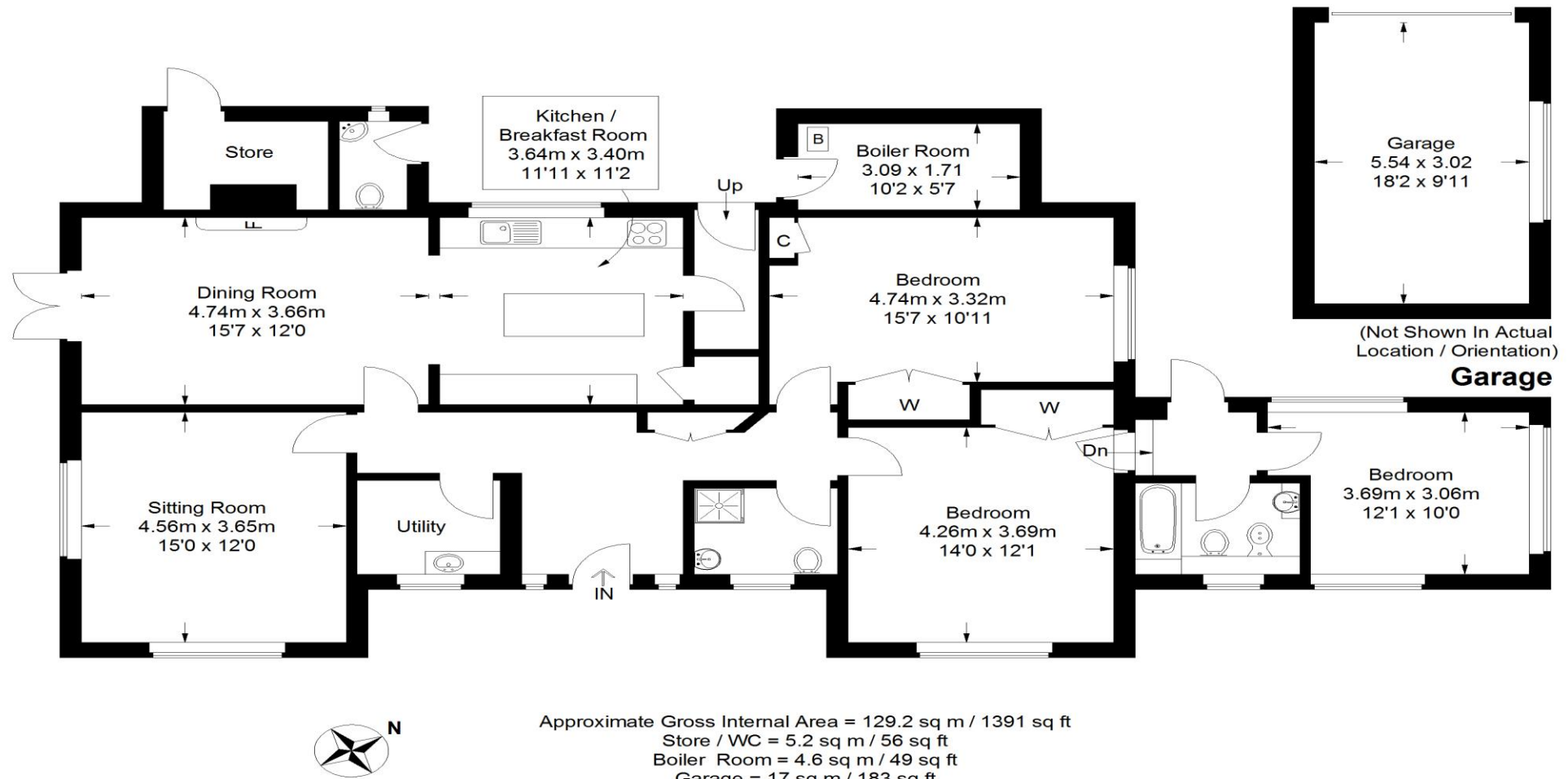

Approximate Gross Internal Area = 129.2 sq m / 1391 sq ft
 Store / WC = 5.2 sq m / 56 sq ft
 Boiler Room = 4.6 sq m / 49 sq ft
 Garage = 17 sq m / 183 sq ft
 Total = 156 sq m / 1679 sq ft

Illustration for identification purposes only, measurements are approximate, not to scale.

Important Notice

Mark David Estate Agents for themselves and their clients give notice that:-

1. They are not authorised to make or give representation or warranty in relation to this property, either on their own behalf or on behalf of the Seller. They assume no responsibility for any statement made in these particulars. These particulars do not form part of any offer or contract and must not be relied upon as statements or representations of fact.
2. Whilst every attempt has been made to ensure the accuracy of the floorplan contained here, measurements of doors, windows, rooms and any other items are approximate and no responsibility is taken for any error, omission, or mis-statement.
3. All areas, measurements or distances are approximate. The particulars are intended for guidance only and are not necessarily comprehensive. A wide angle lens may have been used in photography. Mark David Estate Agents have not tested appliances or services and it should not be assumed that the property has all necessary planning, building regulation and other consents. Buyers must satisfy themselves with the property by inspection or otherwise.
4. Reference to any mechanical or electrical equipment does not constitute a representation that such equipment is capable of fulfilling its function and prospective Buyers must make their own enquiries.
5. They have no responsibility for any expenses or costs incurred by prospective Buyers in inspecting properties which have been sold, let or withdrawn. Applicants are advised to contact the Agent to check availability and any other information of particular importance to them, prior to inspecting the property, particularly if traveling some distance.

"DoubleClick Insert EPC"

