

Offers In Excess Of **£230,000**

tel: **01442 214151**



Summerleas Close, Hemel Hempstead HERTS HP2 5PW

Clements Estate Agents are delighted to offer this SUPERB one double bedroom ground floor luxury apartment offering an excellent range of features including excellent decorative order with a modern fitted kitchen and bathroom, spacious room sizes, electric heating, allocated parking and a popular residential location set close to amenities and transport links. VIEWING ESSENTIAL!

- LUXURY APARTMENT
- ONE BEDROOM
- GROUND FLOOR
- EXCELLENT DECORATIVE ORDER
- SPACIOUS ROOM SIZES

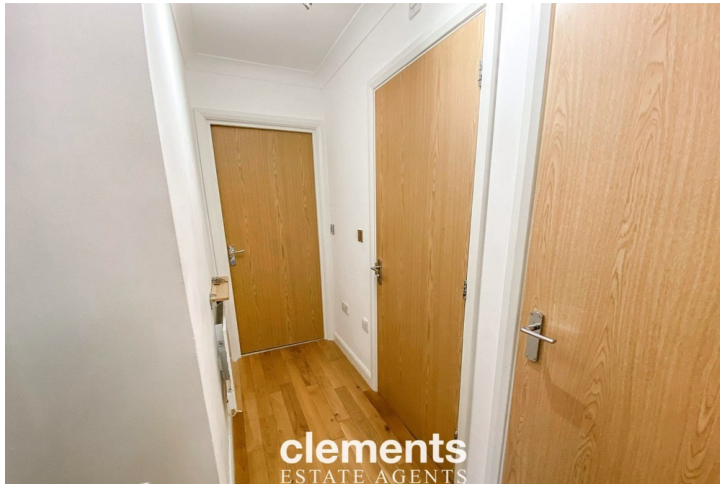

Property Description

Clements Estate Agents are delighted to offer this SUPERB one double bedroom ground floor luxury apartment offering an excellent range of features including excellent decorative order with a modern fitted kitchen and bathroom, spacious room sizes, electric heating, allocated parking and a popular residential location set close to amenities and transport links.

COMMUNAL ENTRANCE

Security entrance door with entry phone system, front door leading to :

ENTRANCE HALLWAY

Well decorated with doors to rooms, wooden flooring, large built in airing cupboard.

LOUNGE/DINER

17' 9" x 10' 10" (5.41m x 3.3m)

A large well decorated double aspect room with a windows to side and rear, fitted carpet, TV point, opening to :

KITCHEN

10' 10" x 6' 3" (3.3m x 1.91m)

A modern range of wall and floor mounted units with roll top work surfaces, stainless steel sink with single drainer and mixer tap, stainless steel built in oven with electric hob and extractor hood over, plumbing and space for a washing machine and dishwasher, space for a fridge freezer, window to side.

BEDROOM

14' 1" x 9' 6" (4.29m x 2.9m)

A good sized master bedroom with a window to side, fitted carpet, electric radiator.

BATHROOM

Comprising a modern panel enclosed bath, pedestal wash hand basin, low level WC, tiled walls and flooring, window to side.

OUTSIDE

Communal gardens and allocated parking.

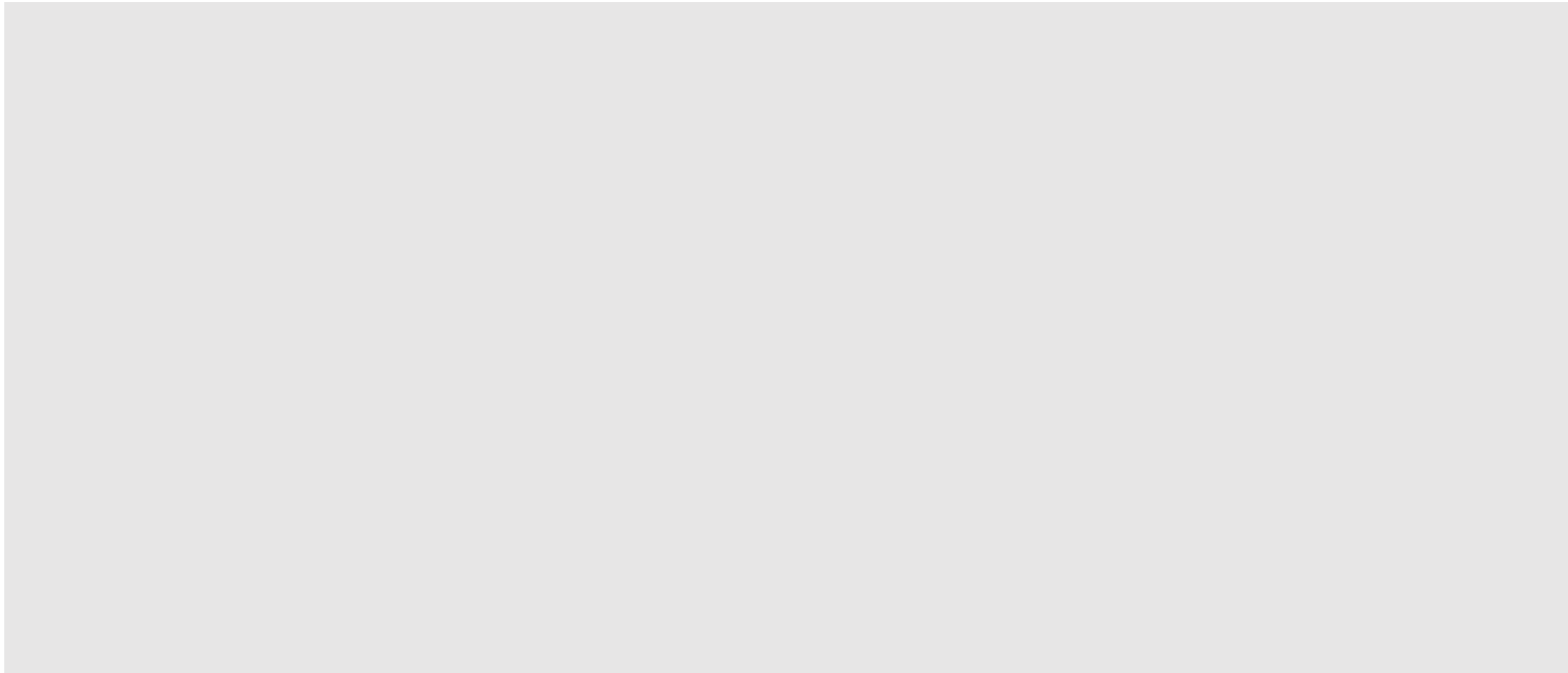

Tenure **Leasehold**

Council Tax Band

Viewing Arrangements **Strictly by appointment**

Contact Details

142 Marlowes

Hemel Hempstead

Hertfordshire

HP1 1EZ

Email: sales@clementsestateagents.co.uk

Tel: 01442 214151

www.clementsestateagents.co.uk

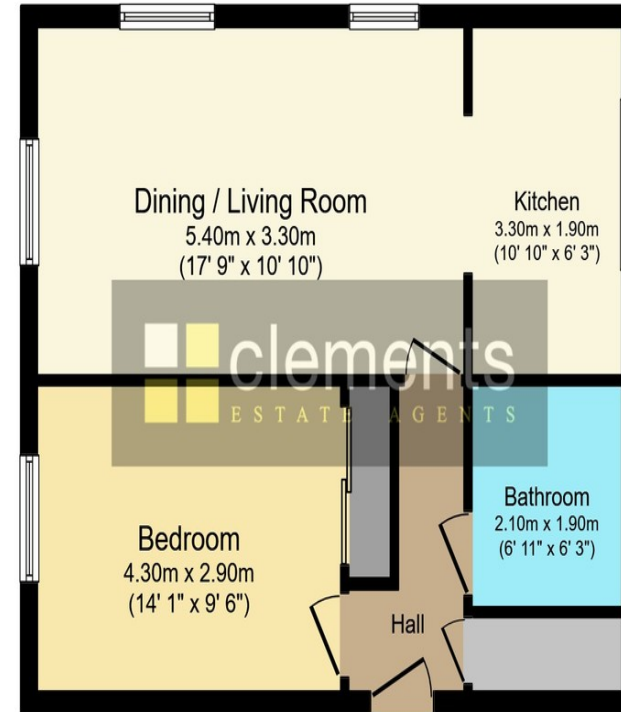

Floor area 47.0 sq. m. (506 sq. ft.) approx

Total floor area 47.0 sq. m. (506 sq. ft.) approx

This Floor Plan is for illustration purposes only and may not be representative of the property. The position and size of doors, windows and other features are approximate. Unauthorized reproduction prohibited. © PropertyBOX

Agents Note: Whilst every care has been taken to prepare these sales particulars, they are for guidance purposes only. All measurements are approximate are for general guidance purposes only and whilst every care has been taken to ensure their accuracy, they should not be relied upon and potential buyers are advised to recheck the measurements